

# Cassingham Complex

## Options



# Programmatic Need: Cassingham Elementary School

- Secure entry to building is distant – visitors must traverse the cafeteria and other spaces to locate Cassingham office
- Some classroom sizes are too small for current educational modalities
- Some classrooms are “buried” with no daylight
- Some spaces co-opted to alternate uses or spaces serve multiple functions due to lack of space
- No intentionally designed collaborative spaces
- Some student support spaces are not ADA compliant
- Cafeteria: distant and not conducive to elementary use
- Media Center is small, conflicts occur with adjacent Middle School use
- Many restrooms are not ADA compliant
- Some furniture updated, many rooms have older, less flexible furniture
- Technology not standardized
- Lack of appropriate storage an issue
- Lack of consistent temperature an issue



# Programmatic Need: Bexley Middle and High School

- Some classroom sizes are too small for current educational modalities
- Many classrooms and student support spaces have no daylight
- Difficult to support interdisciplinary instruction
- Constricted site, lack of parking, open field space/athletic fields
- Athletics: undersized weight room, MS gym, trainers room and locker rooms (also not ADA compliant)
- Shared cafeteria presents challenges for all grade levels
- Corridors are narrow and wayfinding is challenging
- No intentionally designed collaborative or informal learning spaces
- Many restrooms are not ADA compliant
- Inclusive restrooms are limited and not centrally located for ease of access
- Many offices are non-contiguous and would benefit from consolidation
- No intentional teacher collaboration spaces, makes sharing classrooms challenging
- MS Media Center use conflicts with adjacent ES use





# Construction Chronology

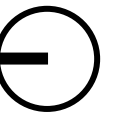
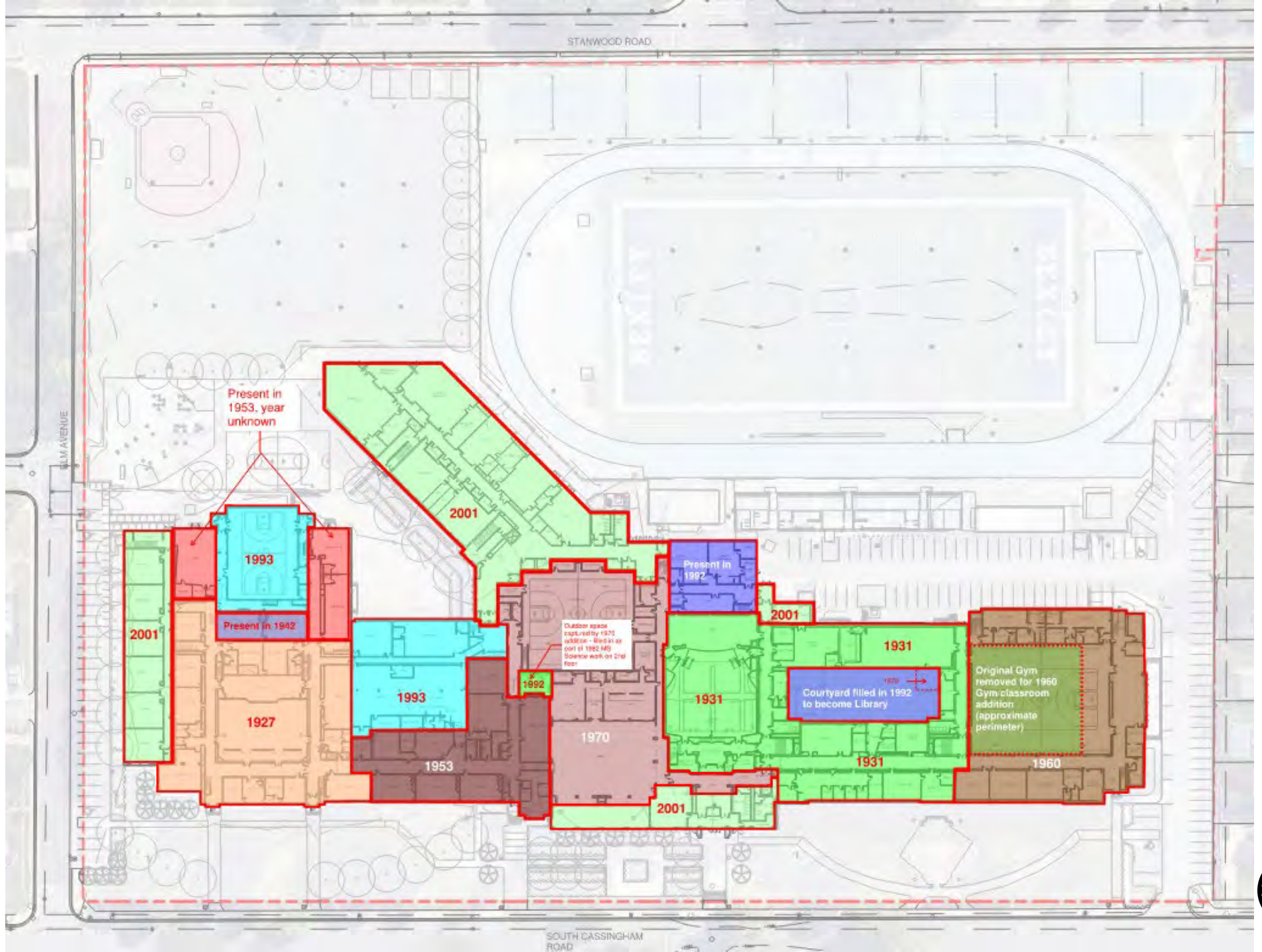



# Existing

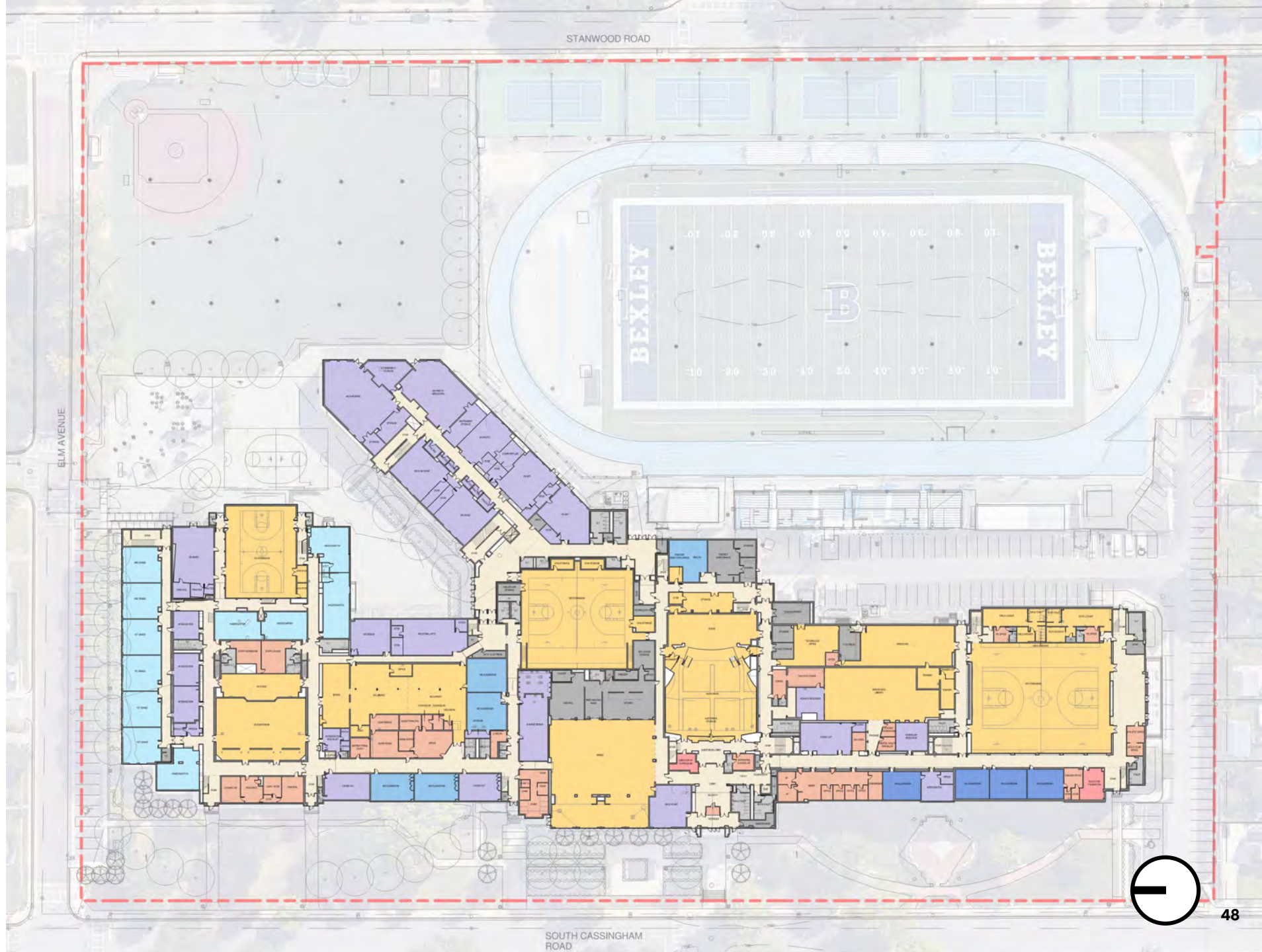



# Option A Demolition

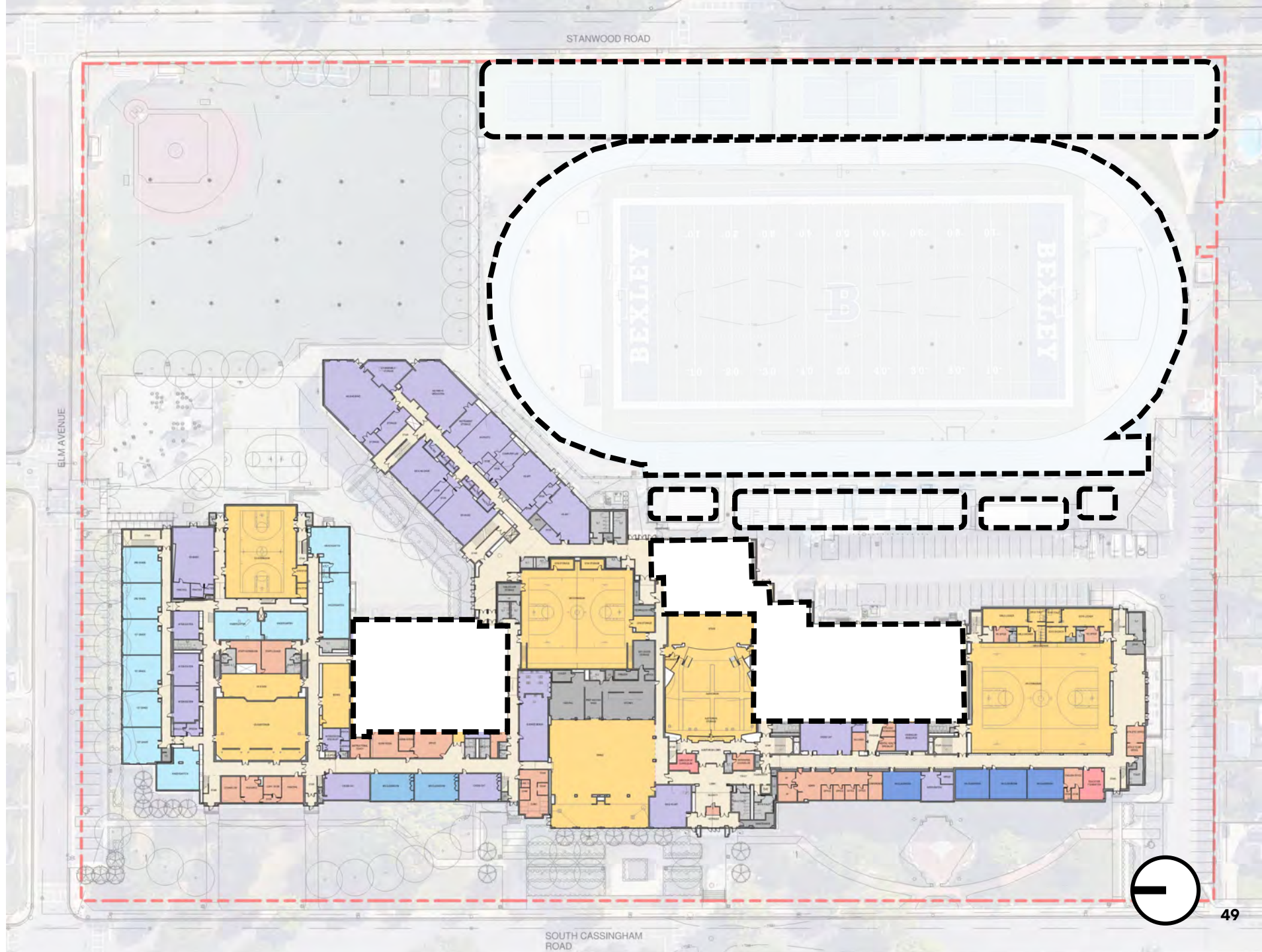



# Option A

\$

- Rebuild: 2 story ES addition and 3 story HS addition with structure for future third floor or third floor district admin offices
- Right sized classrooms, add collaboration and small group spaces
- Right sized cafeterias (separate ES from MS/HS)
- Right sized support spaces (admin, offices, specials, arts, athletics)
- Improved accessibility, circulation and adjacencies
- Natural light for all classrooms
- Tennis or softball relocated off campus

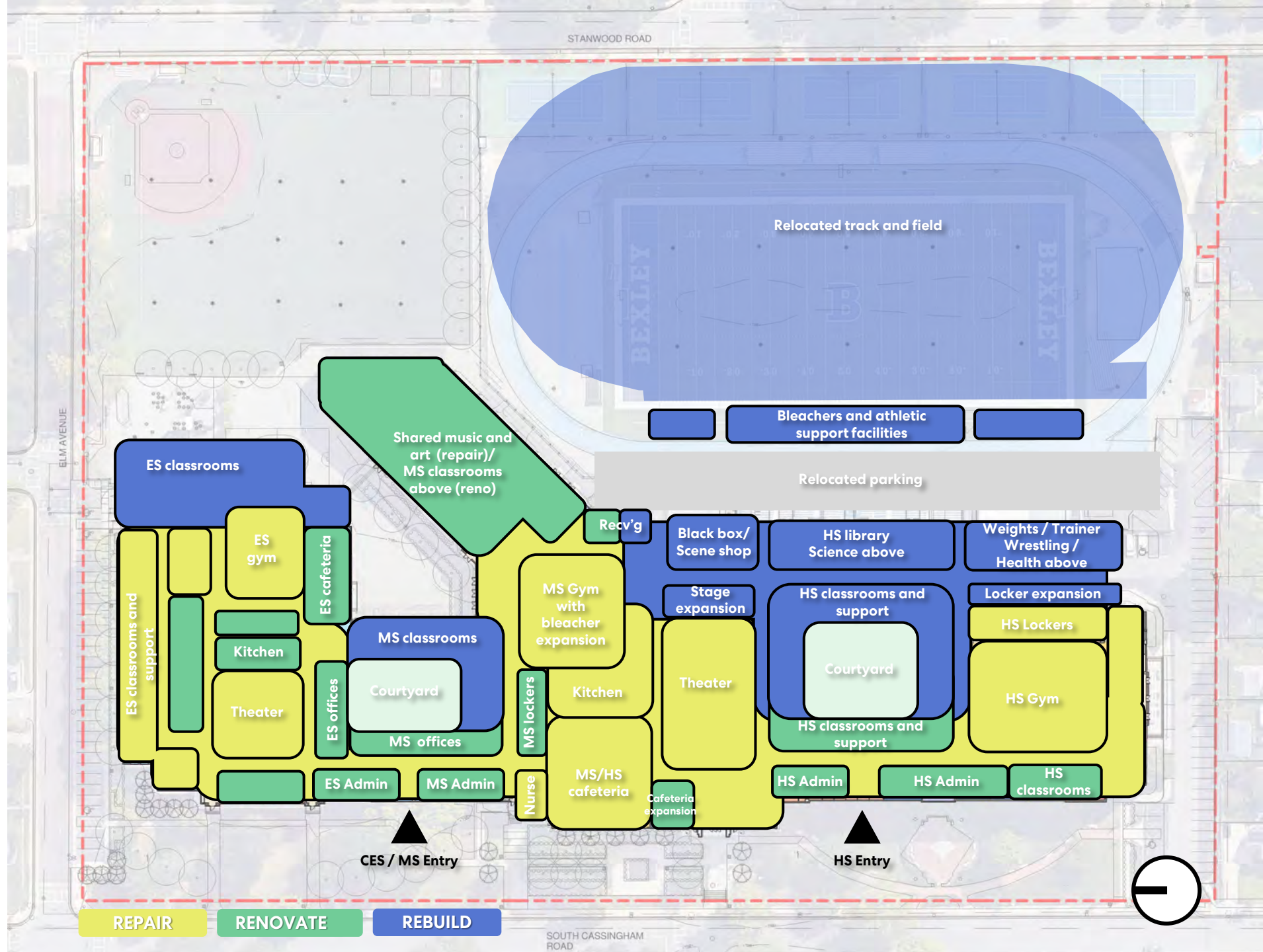



# Option B Demolition

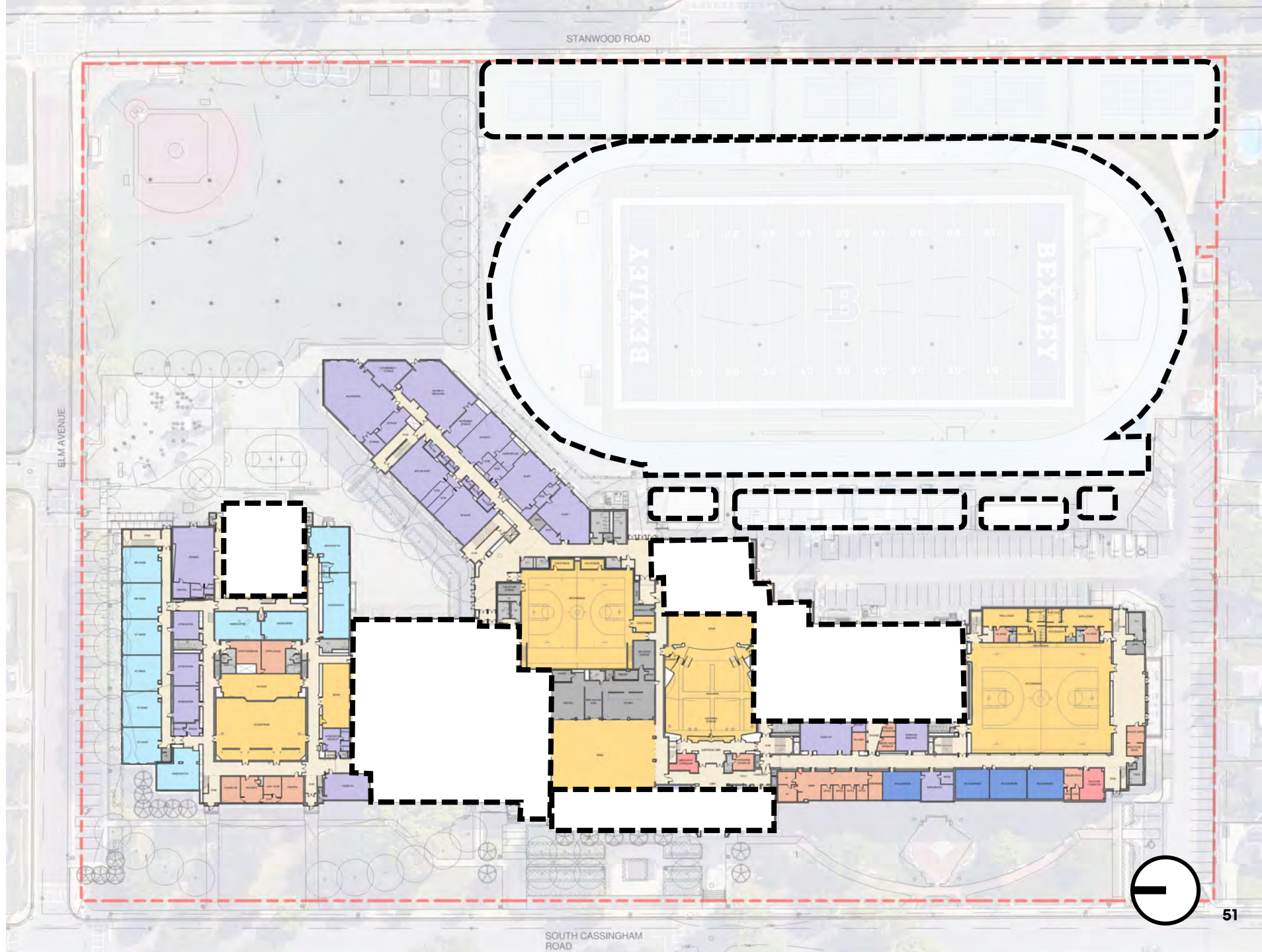



# Option B

\$\$

- Rebuild: 2 story ES, 3 story MS/HS addition across portion of east face, 3 story HS addition with structure for future third floor or third floor district admin offices
- Right sized classrooms, add collaboration and small group spaces
- Right sized cafeterias (new MS/HS location, separate ES from MS/HS)
- Right sized support spaces (admin, offices, specials, arts, athletics)
- Improved accessibility, circulation and adjacencies
- Natural light for all classrooms
- Tennis or softball relocated off campus

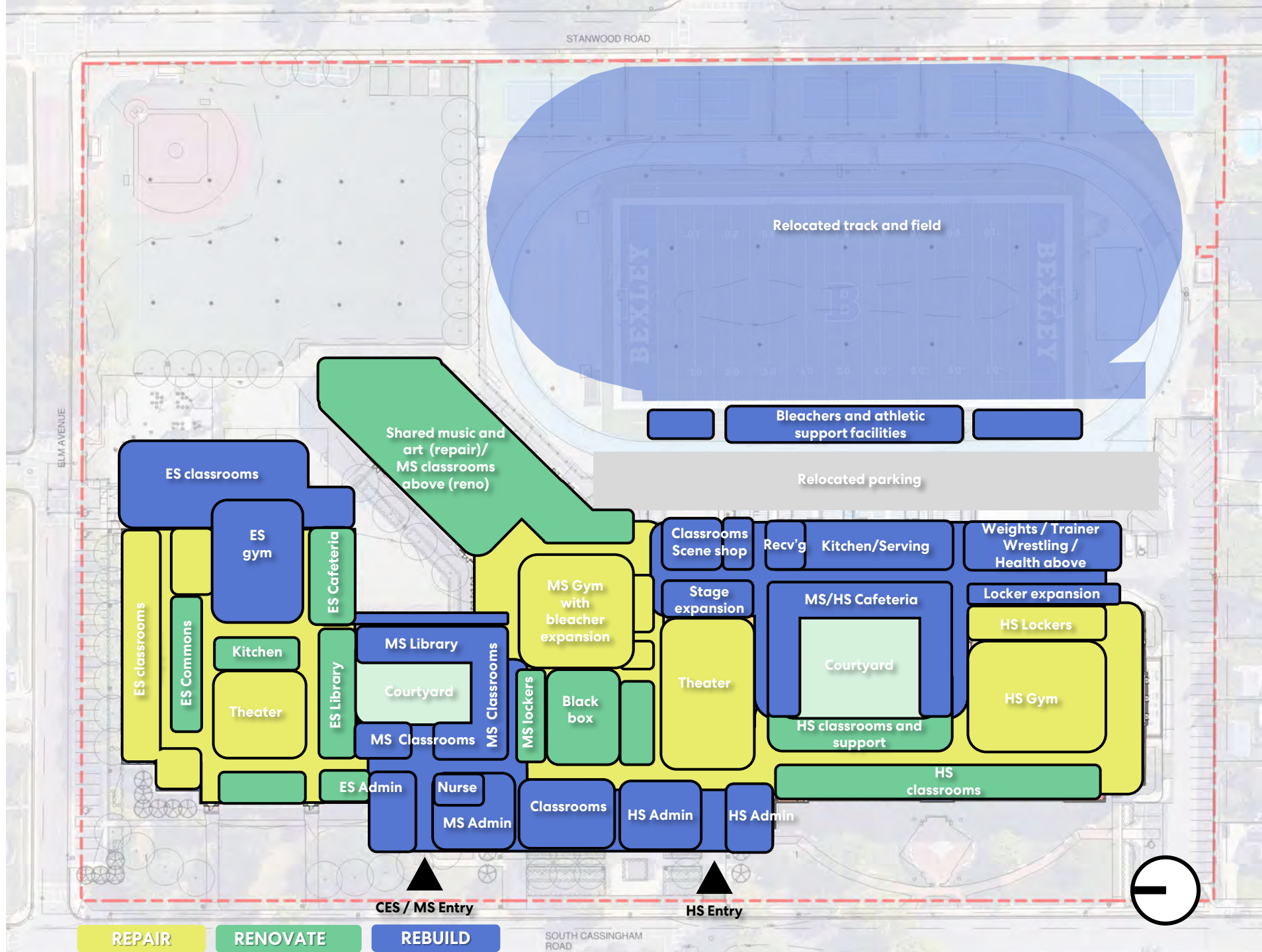

# Option C Demolition

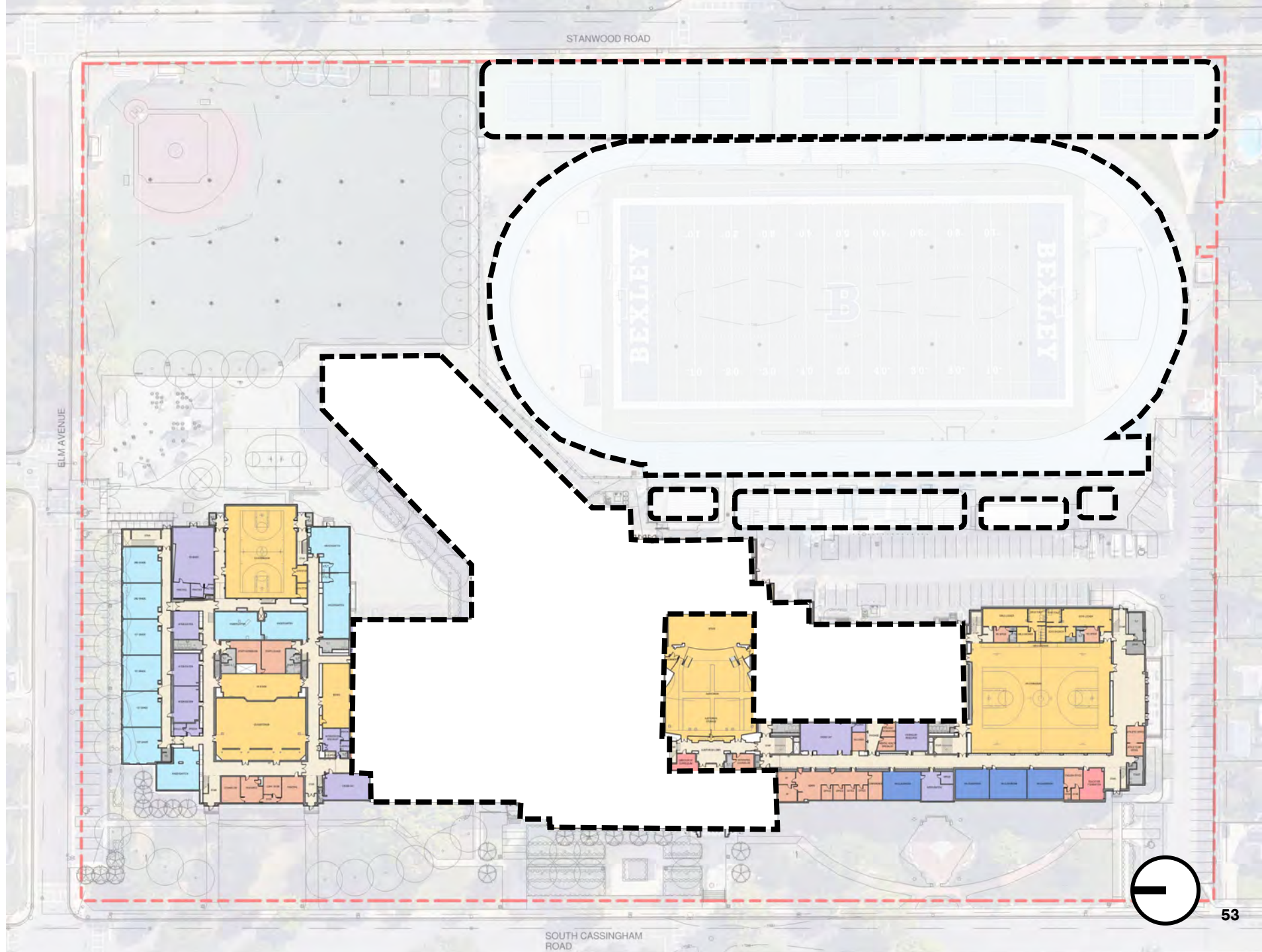



# Option C

\$\$\$

- Rebuild: 3 story MS, Arts Wing, 2 story ES addition, 3 story HS addition with structure for future third floor or third floor district admin offices
- Right sized classrooms, add collaboration and small group spaces
- Right sized cafeterias (separate ES from MS/HS)
- Right sized support spaces (admin, offices, specials, arts, athletics)
- Improved circulation and adjacencies
- Natural light for all classrooms
- Tennis or softball relocated off campus

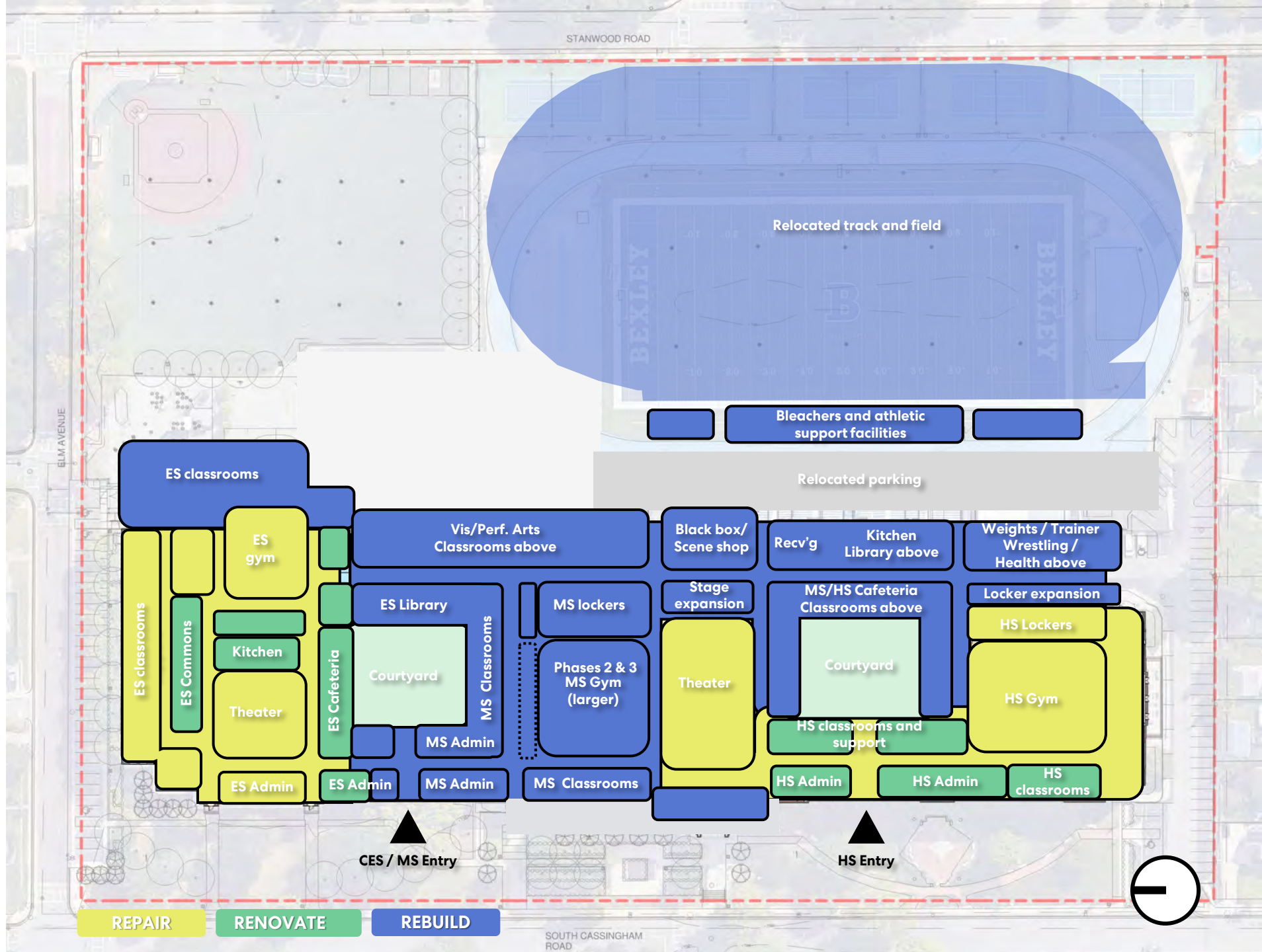

# Option D Demolition

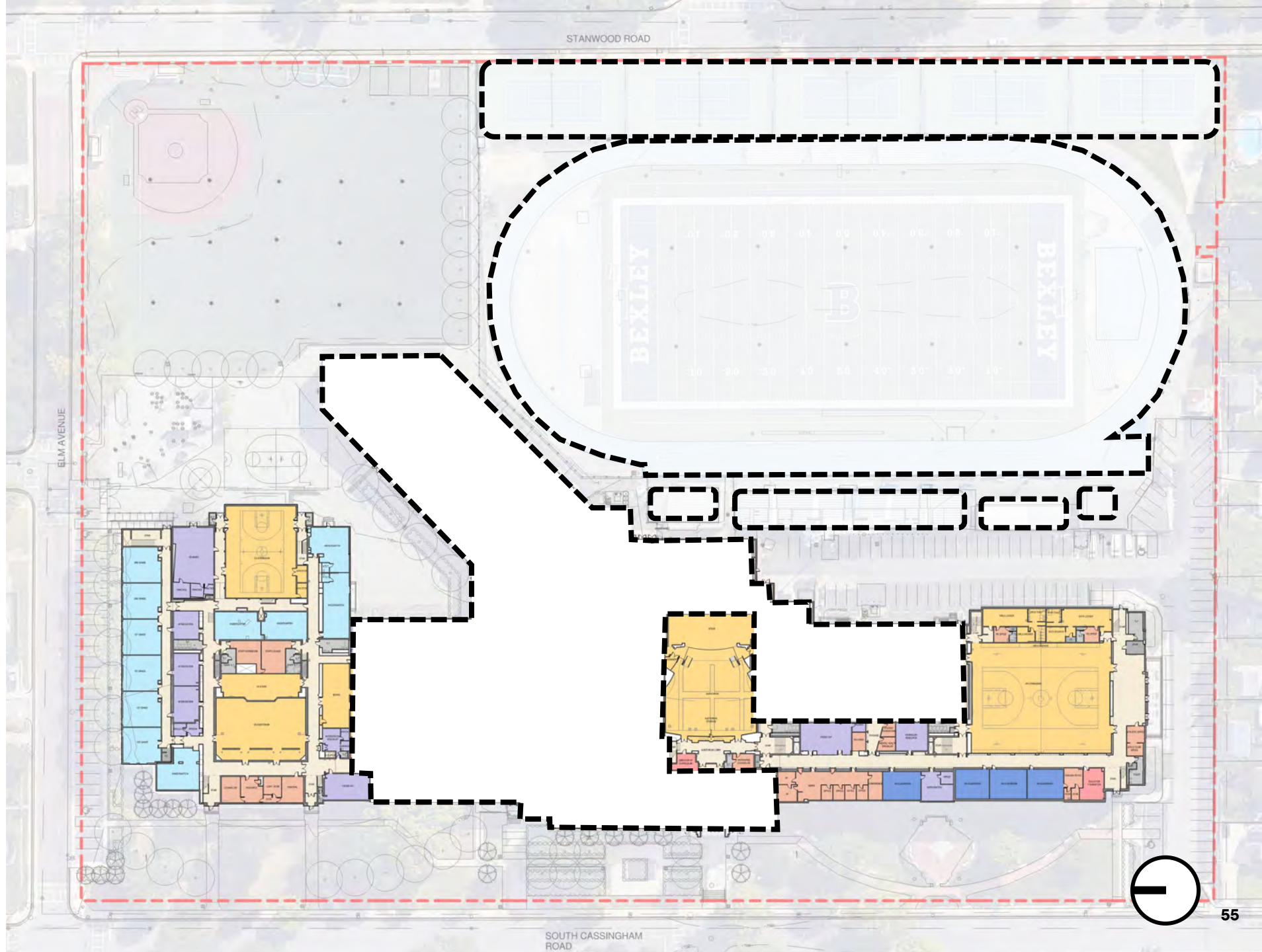



# Option D

\$\$\$

- Rebuild: 3 story MS, 2 story ES addition and 3 story HS addition with structure for future third floor or third floor district admin offices
- Right sized classrooms, add collaboration and small group spaces
- Right sized cafeterias (separate ES from MS/HS)
- Right sized support spaces (admin, offices, specials, arts, athletics)
- Improved accessibility, circulation and adjacencies
- Natural light for all classrooms
- Tennis AND softball relocated off campus

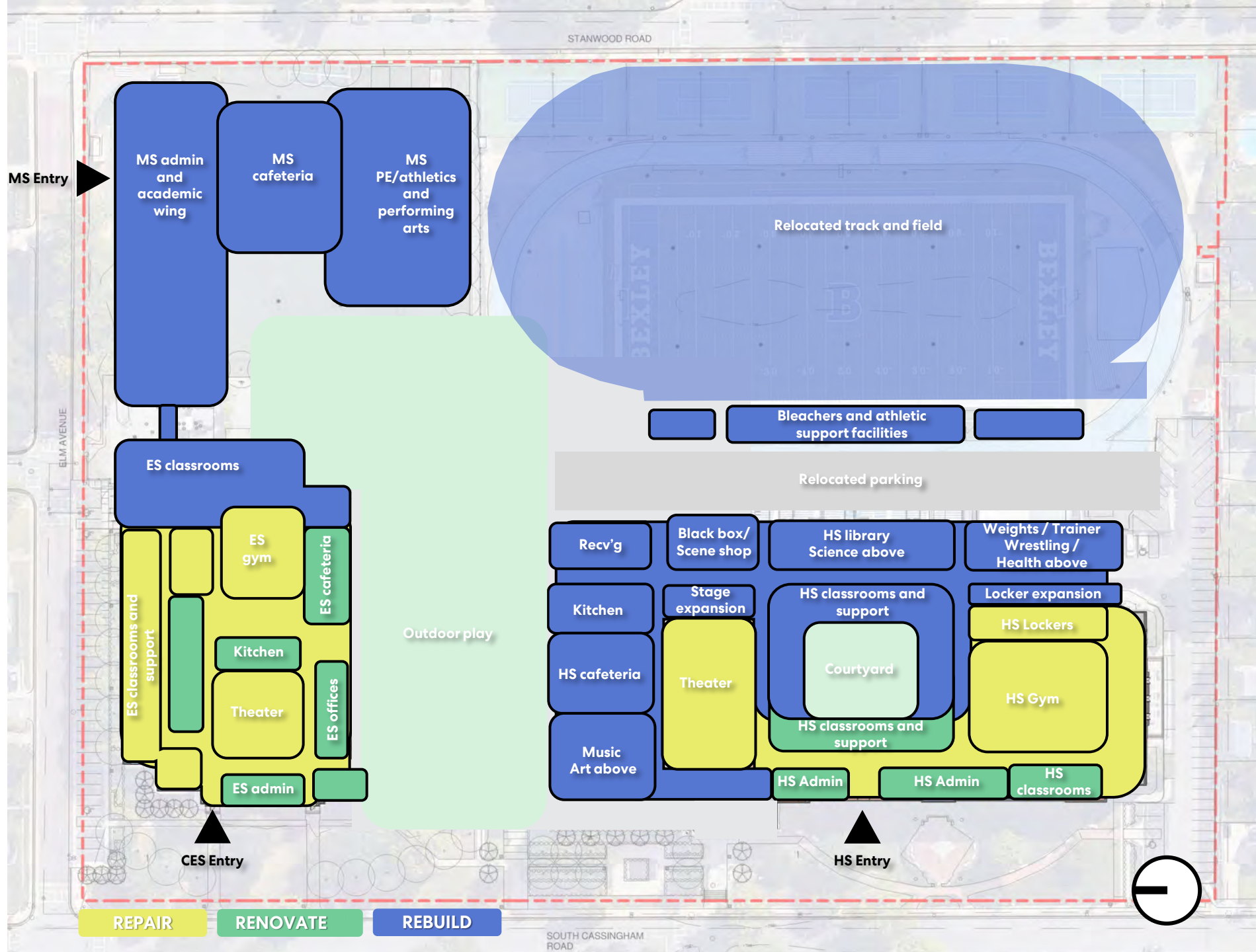

# Option Comparison

## Option A

**Option A**    \$

- Rebuild: 2 story ES addition and 3 story HS addition with structure for future third floor or third floor district admin offices
- Right sized classrooms, add collaboration and small group spaces
- Right sized cafeterias (separate ES from MS/HS)
- Right sized support spaces (admin, offices, specials, arts, athletics)
- Improved accessibility, circulation and adjacencies
- Natural light for all classrooms
- Tennis or softball relocated off campus

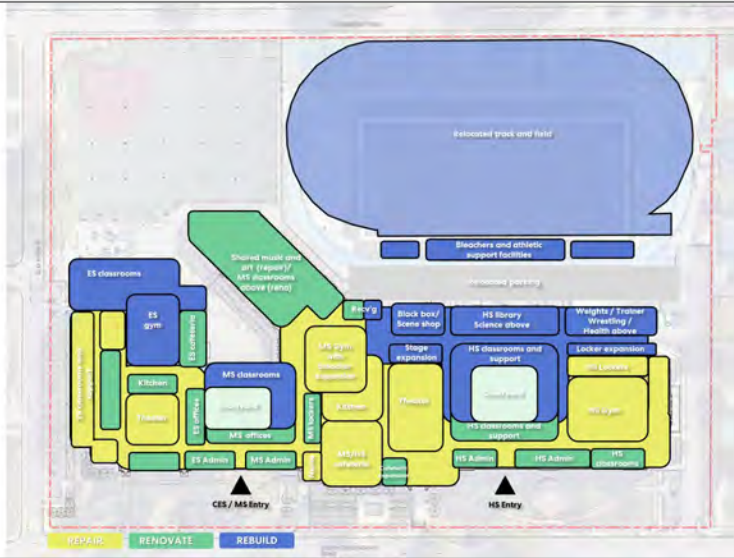

## Option B

**Option B**    \$\$

- Rebuild: 2 story ES, 3 story MS/HS addition across portion of east face, 3 story HS addition with structure for future third floor or third floor district admin offices
- Right sized classrooms, add collaboration and small group spaces
- Right sized cafeterias (new MS/HS location, separate ES from MS/HS)
- Right sized support spaces (admin, offices, specials, arts, athletics)
- Improved accessibility, circulation and adjacencies
- Natural light for all classrooms
- Tennis or softball relocated off campus

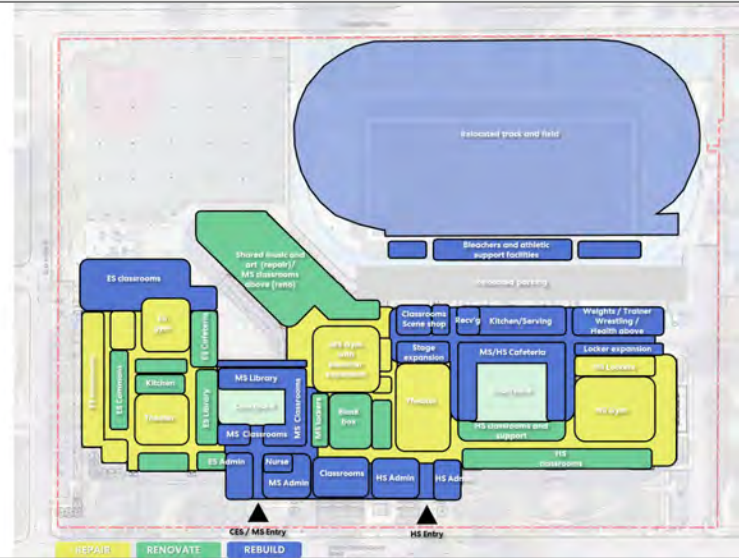

## Option C

**Option C**    \$\$\$

- Rebuild: 3 story MS, Arts Wing, 2 story ES addition, 3 story HS addition with structure for future third floor or third floor district admin offices
- Right sized classrooms, add collaboration and small group spaces
- Right sized cafeterias (separate ES from MS/HS)
- Right sized support spaces (admin, offices, specials, arts, athletics)
- Improved circulation and adjacencies
- Natural light for all classrooms
- Tennis or softball relocated off campus

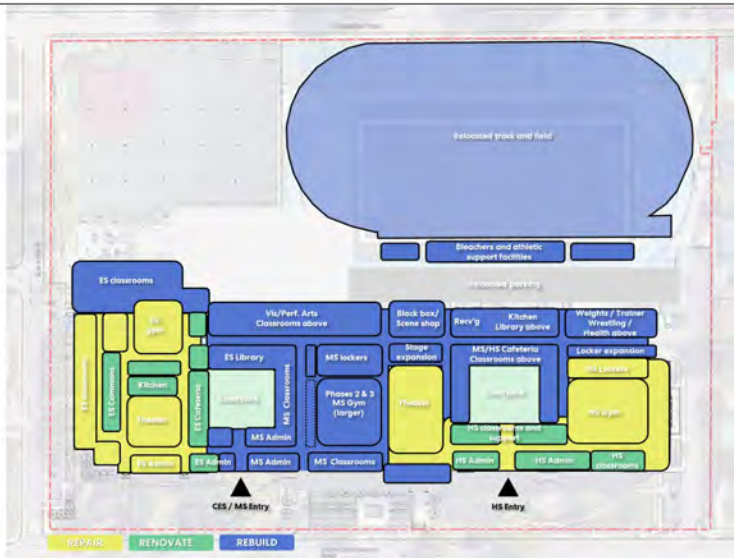

## Option D

**Option D**    \$\$\$

- Rebuild: 3 story MS, 2 story ES addition and 3 story HS addition with structure for future third floor or third floor district admin offices
- Right sized classrooms, add collaboration and small group spaces
- Right sized cafeterias (separate ES from MS/HS)
- Right sized support spaces (admin, offices, specials, arts, athletics)
- Improved accessibility, circulation and adjacencies
- Natural light for all classrooms
- Tennis AND softball relocated off campus

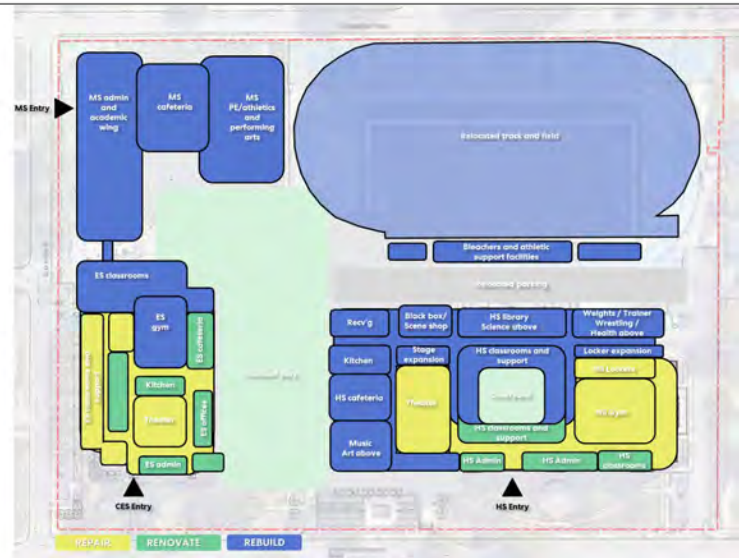



## Building Team Summary Comments – Cassingham Elementary School

\*Blue highlight aligns with BMS/BHS BTM

- Like the daylight/courtyards in all options
- Like the larger elementary school gym
- Like the dedicated elementary school cafeteria and the outdoor recess connection
- Like re-using existing building footprint, especially historic buildings
- Like moving non-academic program off site
- Option A: Like how it is cost effective but not the best long-term solution
- Option C: Like how the end result fixes many challenges and maintains contiguous building
- Option D: Like how it provides each school a separate identity, could alleviate some traffic
- Option D: Like the outdoor space but limits athletic space
  
- Explore an option where the stadium and tennis does not move
- Explore how to enhance elementary play areas in Options A and B / line of sight / maximizing playground space
- Option D: Explore if elementary and middle school can swap for MS/HS adjacency
- Explore an option where we start with a clean slate, new building
- Explore where athletic components will go if not on the campus

## Building Team Summary Comments – Bexley Middle School and High School

\*Blue highlight aligns with CES BTM

- Like maximizing height with a 3<sup>rd</sup> floor and ability to expand vertically
- Like the daylight in all options
- Like the larger elementary school gym to alleviate pressures on MS/HS athletic space
- Like the clarity of the new circulation (reducing dead ends), accessibility
- Option C: Like how the end result fixes many challenges and maintains contiguous building
- Option D: Like how it gives each school a separate identity, could alleviate some traffic
- Option D: Like the long-term thinking
  
- Explore an option where the stadium and tennis do not move
- Explore if tennis/softball can remain on district campuses (turf at all ES)
- Explore how to enhance elementary play areas in Options A and B
- Option D: Explore if elementary and middle school can swap for MS/HS adjacency