



Sylvania City Schools Master Facilities Plan

April 2024

Current Facilities & Future Needs

Sub Committee Workshop



web

We will be using Poll Everywhere, to prepare please open the website:
PollEv.com/daveserra492

text

You can also respond by text by sending daveserra492 “22333”

THE COLLABORATIVE



Preliminary Schedule

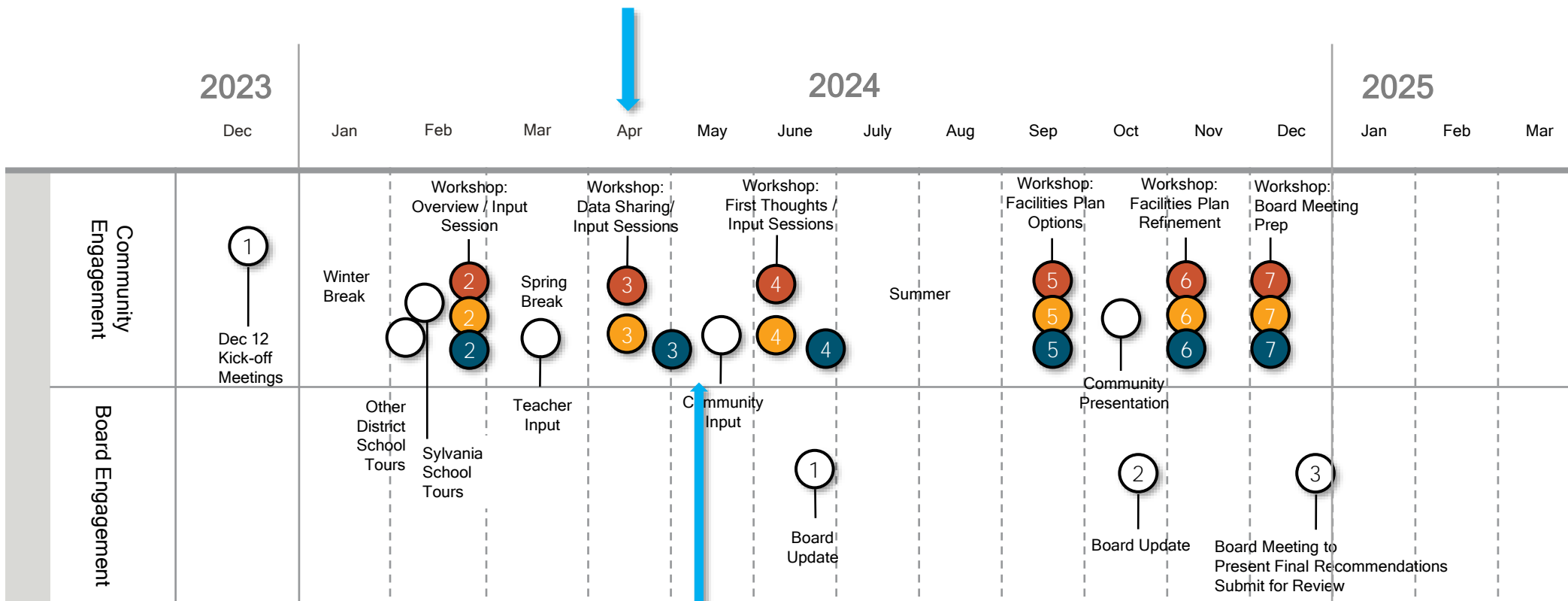

- X Current & Future Facilities
- X Teaching & Learning Environments
- X Fiscal Responsibility

Dedicated Meeting to Discuss Special Education & Preschool

Agenda

- 1 Introductions
- 2 What we heard...
- 3 Projected Enrollment & Capacity
- 4 Critical Infrastructure Improvements
- 5 Existing Learning Environments
- 6 Next Steps

Agenda

- 1 Introductions
- 2 What we heard...
- 3 Projected Enrollment & Capacity
- 4 Critical Infrastructure Improvements
- 5 Existing Learning Environments
- 6 Next Steps

Considerations for the Master Facilities Plan Committee will include:

- Enrollment and residential trends
- Reviewing the maintenance costs associated with the varying ages of buildings across the district (some that require/demand repair beyond typical upkeep.)
- **Preschool** services being provided are currently decentralized in classrooms designed for K-5 students.
- Explore potential grade configurations, redistricting to maximize, build/repurpose current buildings.
- Increase in diverse learning needs that require unique/special learning spaces.



THE COLLABORATIVE

Current Facilities & Future Needs

Enrollment trends and future needs and options

- Contribute unique insight/perspective and expertise relating to condition and viability (current/future) of existing facilities
- Lead exploration of enrollment trends and their affect on future facility needs
- Consider need for renovation of existing and/or creation of new facilities
- Understand deferred maintenance requirements, provide planning approaches to accomplish identified needs, and assist Financial Responsibility Committee to develop funding strategies
- Understand population growth and current and future space needs



THE COLLABORATIVE

Current Facilities & Future Needs

Sub Committee Members

- Mellisa McDonald
- Jeremy McDonald
- Emma Gess
- Julie Hoffman
- Brian Bollinger
- Ray Holston
- Tim Dillon
- Sean McCarthy
- Libby Langenderfer
- Ben Bolbach
- Justin Hittler
- Kim Conklin
- Khallil Daher
- Steffon Thomas
- Chris White
- Kimberly Beil
- John LePla
- Jill Johnson
- Michael Quick
- Jen Pollard
- Pamela Richmond
- Dawn Watson
- Sheryl O'Shea
- Darren Estelle
- Julie Gault
- Kelly Koller
- Nathan Blust



Agenda

- 1 Introductions
- 2 What we heard...
- 3 Projected Enrollment & Capacity
- 4 Critical Infrastructure Improvements
- 5 Existing Learning Environments
- 6 Next Steps

2

In-person Meetings

91

Participants



THE COLLABORATIVE

Based on teachers' responses, key concerns in their district are:

1. **Space and Overpopulation:** need for more classrooms due to increased enrollment, lack of appropriate space for preschool growth, and challenges accommodating new students
2. **Student Behavior and Needs:** managing intense behaviors, supporting special needs students, and addressing student apathy, especially among those entering high school unprepared academically
3. **Support and Resources:** lack of intervention teachers, administrative support, and funding, emphasizing the need for more resources to support both teachers and students
4. **Follow-Through:** frustration with management issues and inconsistent follow-through on plans was highlighted, including rumors of organizational changes like redistricting



THE COLLABORATIVE

Based on teachers' responses, key concerns in their district are:

- 5. Safety and Mental Health Support:** importance of creating a positive emotional climate, providing mental health support, and addressing safety concerns such as discipline issues
- 6. Educational Quality and Equity:** maintaining educational standards, ensuring equity of resources, and meeting diverse student needs, including concerns about disappearing libraries and the need for career tech labs
- 7. Infrastructure and Academic Structure:** limitations of the daily class schedule, inadequate storage, and the need for changes to the physical environment were noted to support a conducive academic schedule



Which areas/aspects of your school facility do you think need the most improvement?
Please select up to five

What we heard...

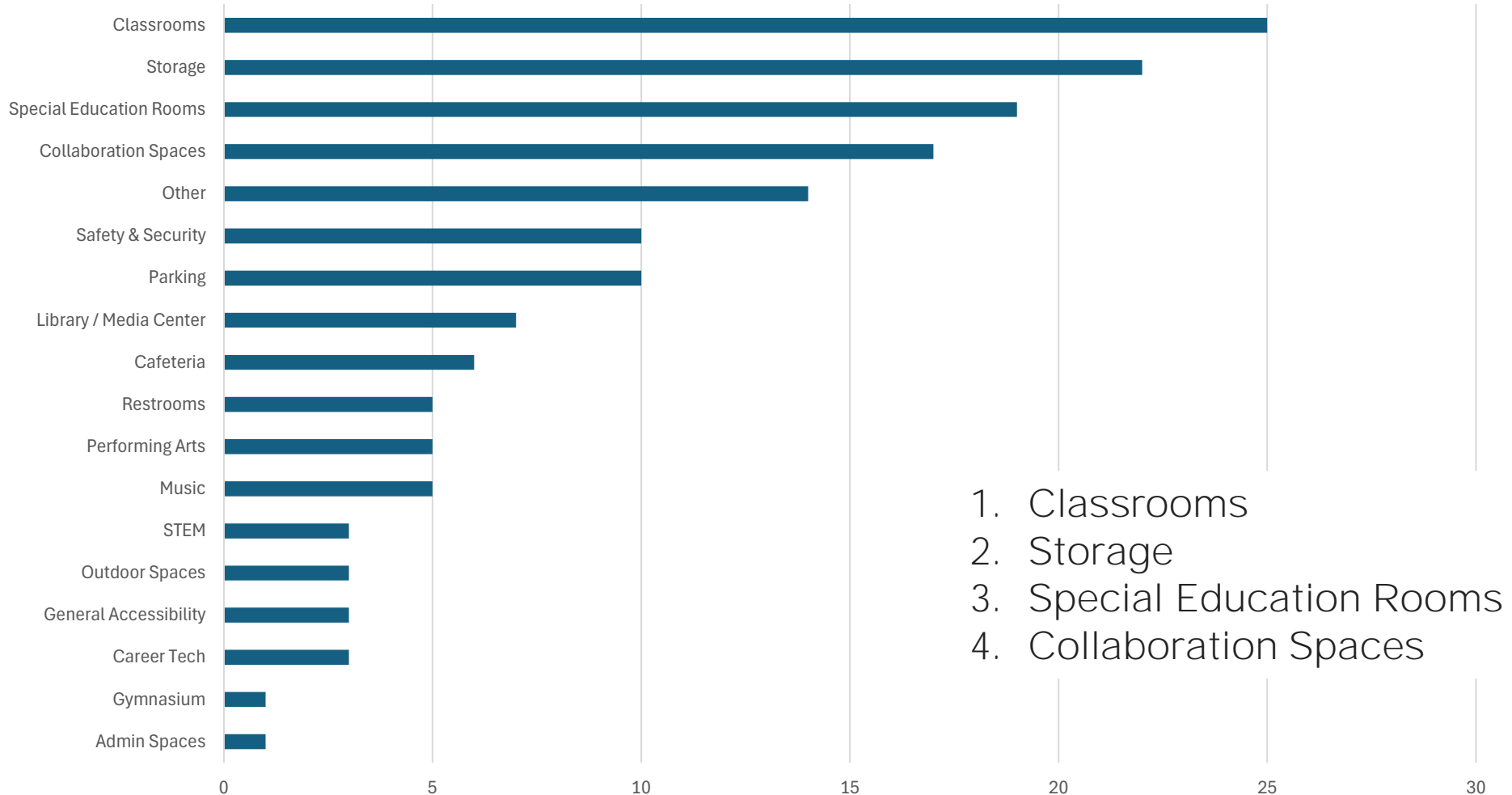

What improvements to your teaching environment would help you better serve your students?

What we heard...

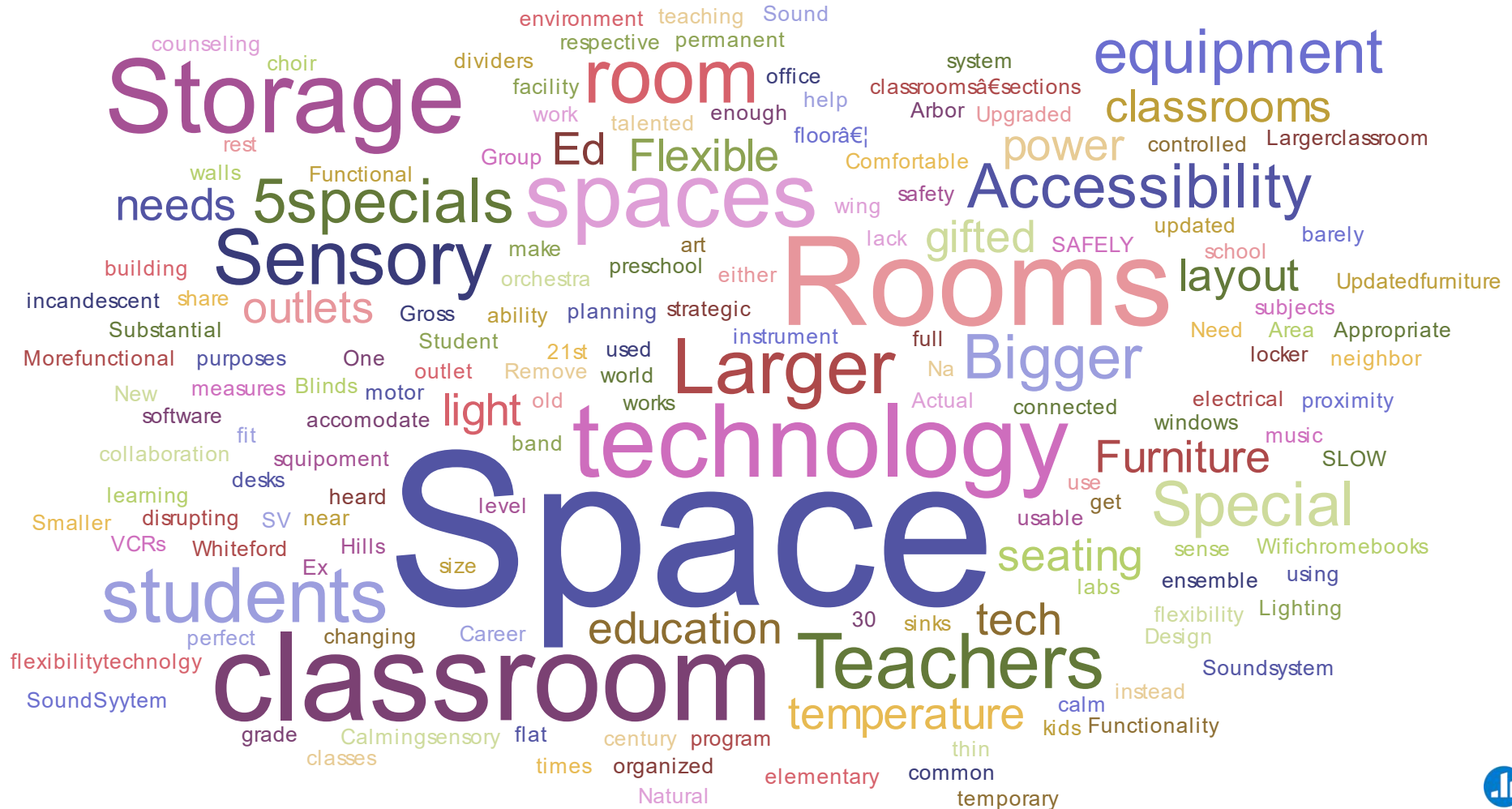

THE COLLABORATIVE

The following are themes that reflect the most cited improvements....

1. **More Space(s):** desire for larger classrooms and functional, dedicated intervention spaces - rooms for group counseling, 5 specials gross motor activities, sensory rooms, and career tech classrooms connected to labs
2. **Technology:** updated technology, including sound systems, more outlets for power, reliable wi-fi and Chromebooks, and access to 21st-century technology for teaching
3. **Storage:** for modalities within individual classrooms, for specialty equipment and instruments within a building, and district wide solutions for furniture, technology, and other equipment



THE COLLABORATIVE

The following are themes that reflect the most cited improvements....

4. **Flexible Furniture:** updated furniture options with flexibility, functional layouts, and the ability to use space for changing educational needs
5. **Lighting and Temperature:** requests for improved lighting, including natural light, and maintaining comfortable temperatures in classrooms
6. **Safety Measures:** general concern for create safe teaching environments, visibility into classrooms was a concern
7. **Accessibility:** more accessible spaces and technology to meet the needs of all students, including those with disabilities



THE COLLABORATIVE

Most mentioned missing facilities include....

1. **Preschool Building:** desire for a centralized solution
2. **Career Tech Facility:** desire for a centralized solution
3. **Special Education Spaces:** desire for more dedicated, purpose-built spaces including, intervention areas, sensory rooms, autism-specific facilities
4. **Storage :** desire for improved solutions

Other responses include...

- Music Rooms
- Additional Elementary Building
- Larger Gyms and Indoor Sports Facilities
- Employee Break Rooms



1

On-line Survey
(in-progress)

119

Responses

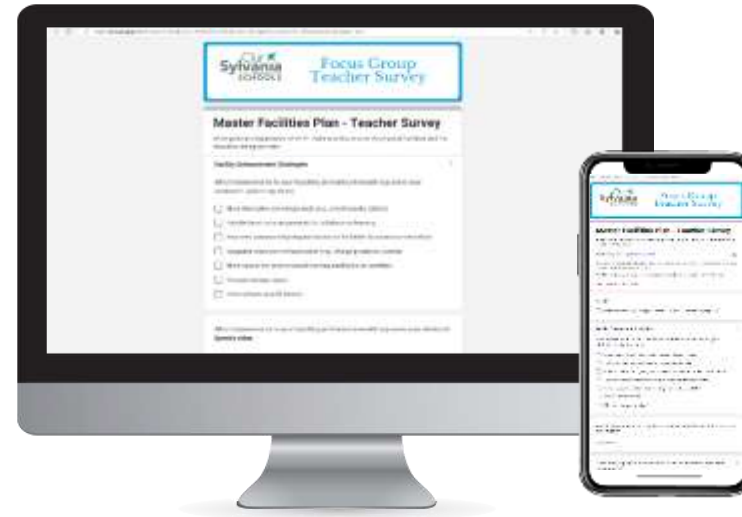

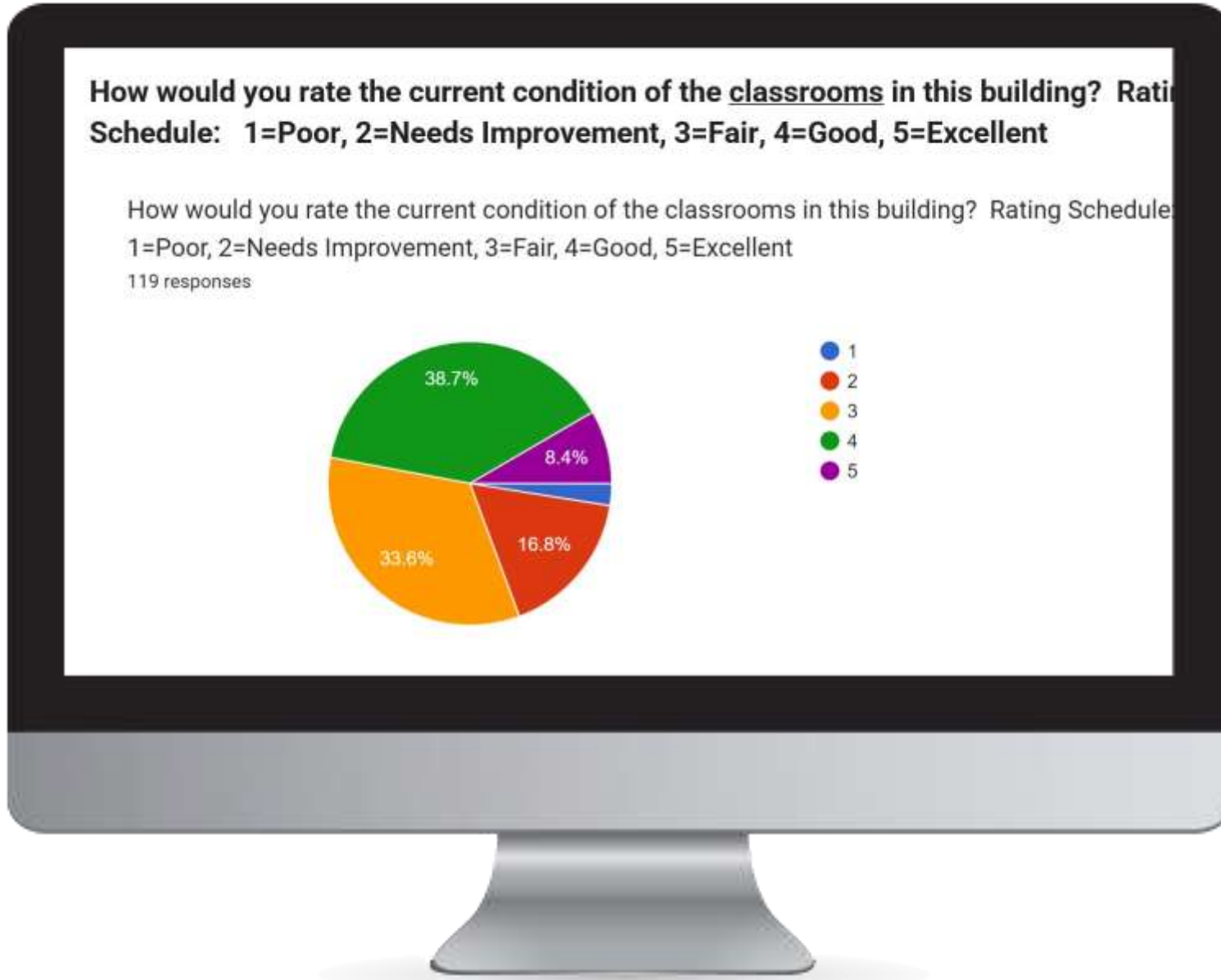

“this building” refers to the facility that they teach or work in – responses will be organized by facility when survey ends

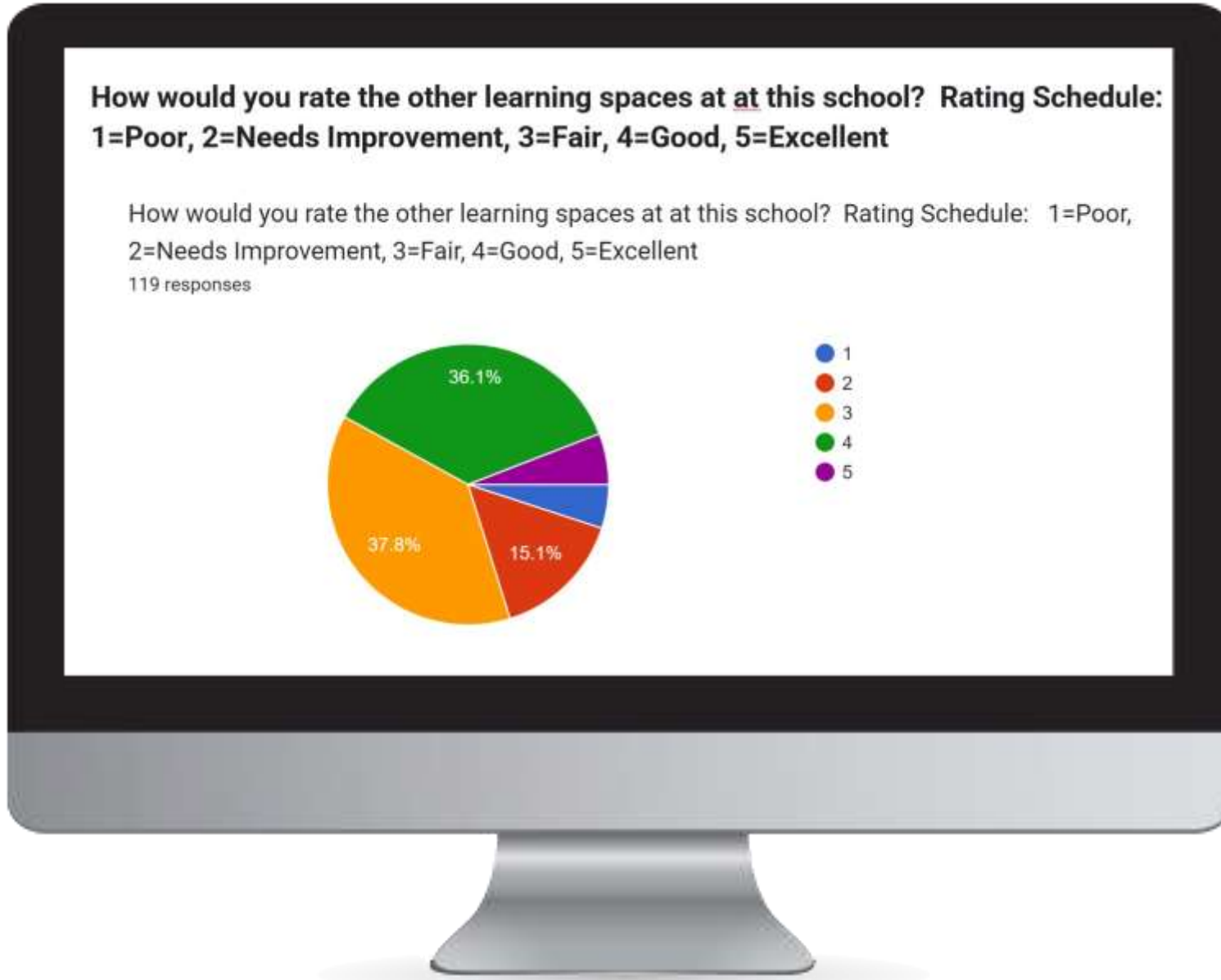

“this school” refers to the facility that they teach or work in – responses will be organized by facility when survey ends

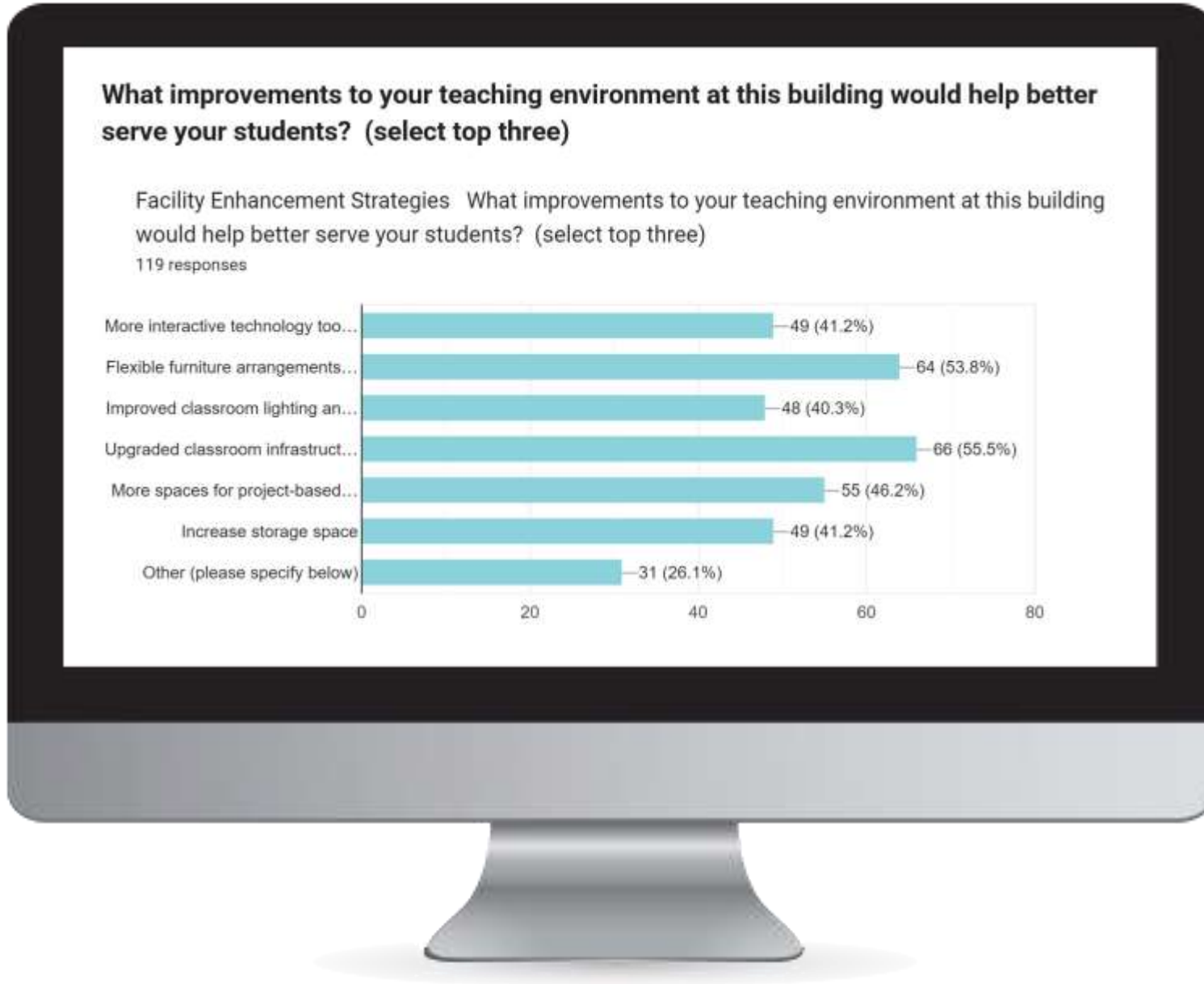

“this building” refers to the facility that they teach or work in – responses will be organized by facility when survey ends

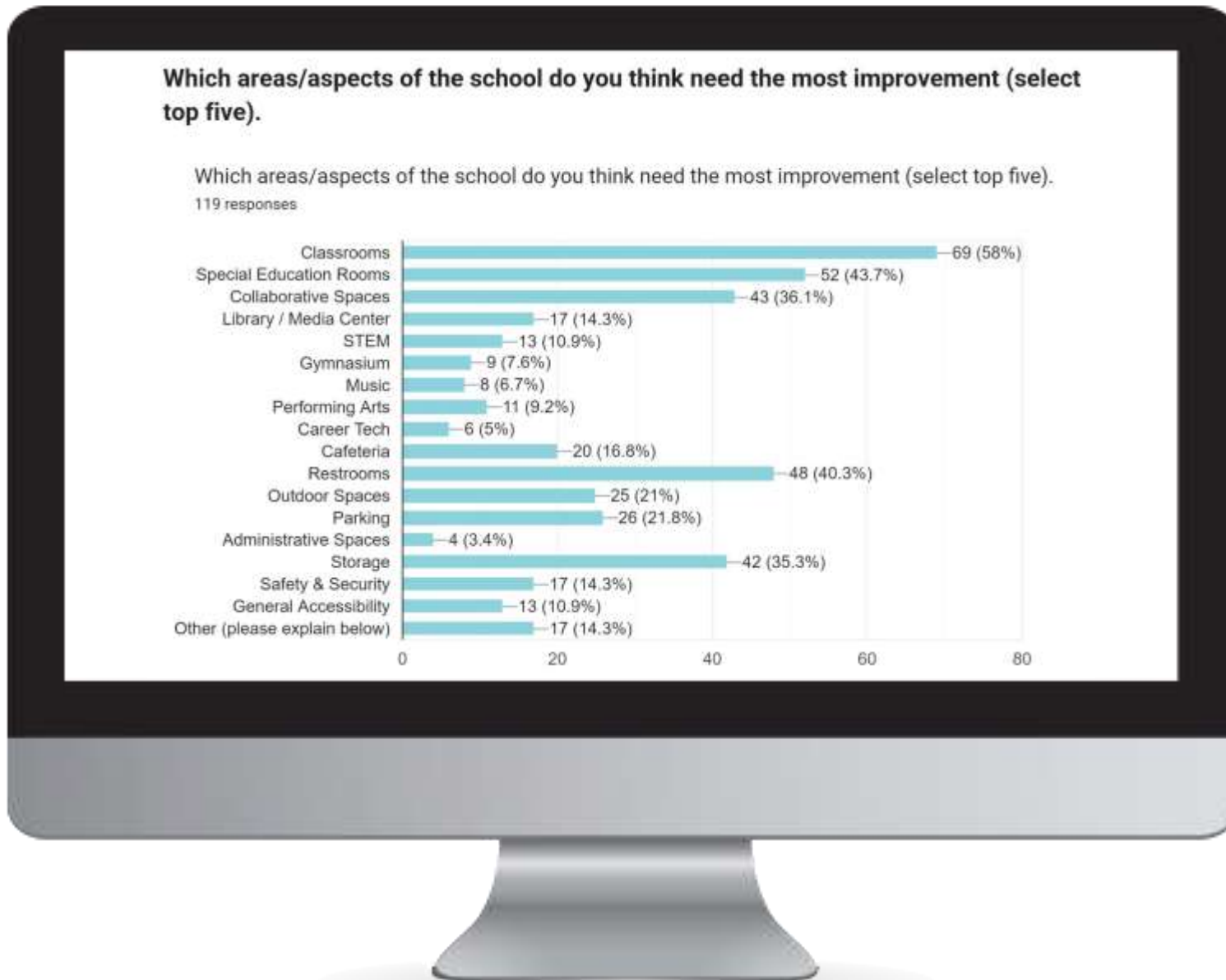

1. Classrooms
2. Special Education Rooms
3. Restrooms
4. Collaboration Spaces
5. Storage

“the school” refers to the facility that they teach or work in – responses will be organized by facility when survey ends

Do you feel like these accurately reflect the comments you've heard to date?



Do you feel like these accurately reflect the comments you've heard to date?

Yes

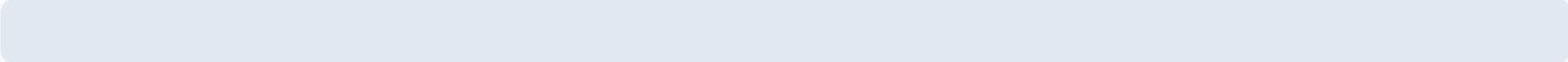

0%

No

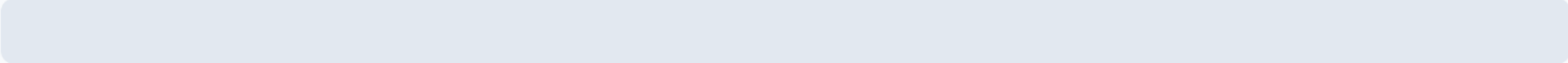

0%

I don't know

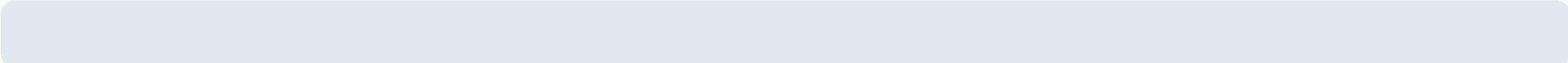

0%

Agenda

- 1 Introductions
- 2 What we heard...
- 3 Projected Enrollment & Capacity**
- 4 Critical Infrastructure Improvements
- 5 Existing Learning Environments
- 6 Next Steps

Enrollment (Moderate Approach)

— Kindergarten — K to 5 Grade — 6 to 8 Grade — 9 to 12 Grade — Totals

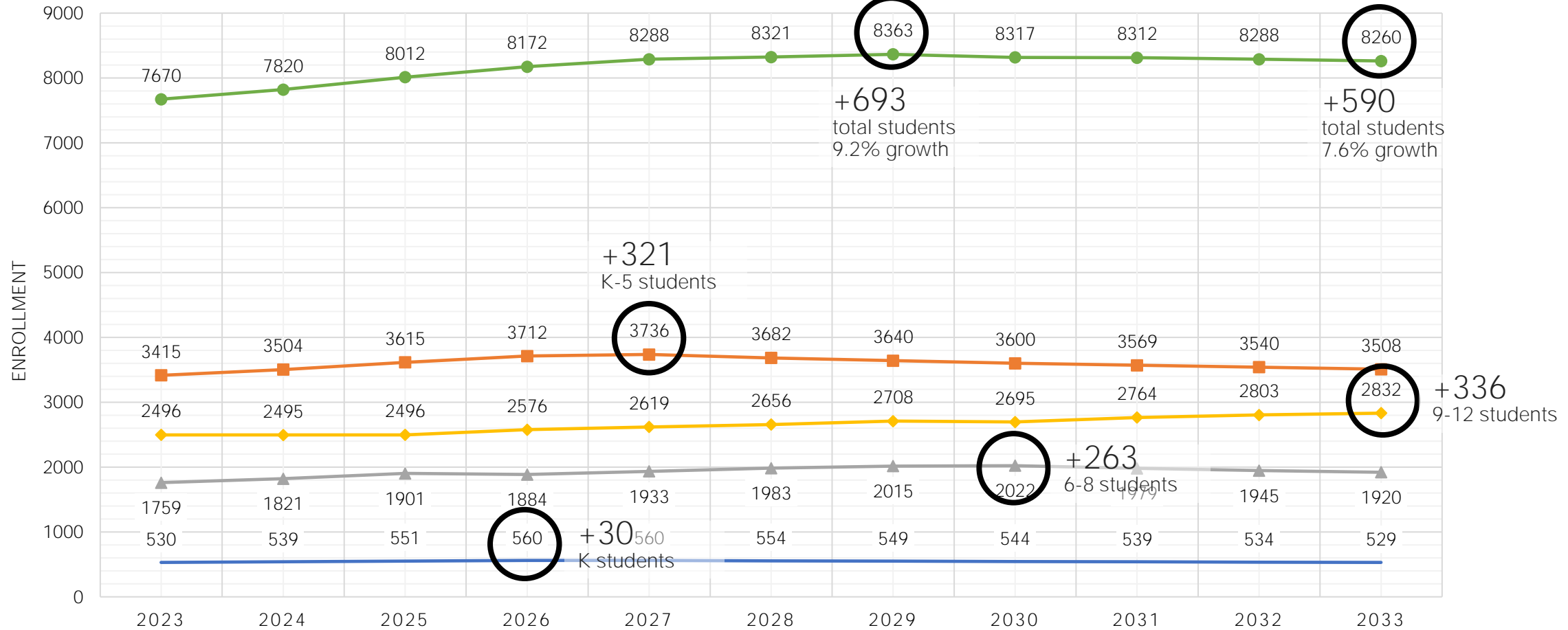

Enrollment Projections - Fall 2024

* Moderate projection is more suitable for facilities planning purposes

Analysis of Enrollment Projections Fall 2024 by Power Schools (March 27, 2024)

Sylvania Schools District
1-Mile Radius



- Central Trail Elementary School
- Maplewood Elementary School
- Sylvan Elementary School
- Highland Elementary School
- Stranahan Elementary School
- Whiteford Elementary School
- Hill View Elementary School
- Timberstone Junior High
- McCord Junior High
- Arbor Hills Junior High
- Northview High School
- Southview High School

Projected District Growth



- Proposed New Developments
- Schools with Projected Impact
 - Central Trail E.S.
 - Maplewood E.S.
 - Sylvan E.S.
 - Timberstone J.H.
 - Whiteford E.S.

- Central Trail Elementary School
- Maplewood Elementary School
- Sylvan Elementary School
- Highland Elementary School
- Stranahan Elementary School
- Whiteford Elementary School
- Hill View Elementary School
- Timberstone Junior High
- McCord Junior High
- Arbor Hills Junior High
- Northview High School
- Southview High School

Projected District Growth

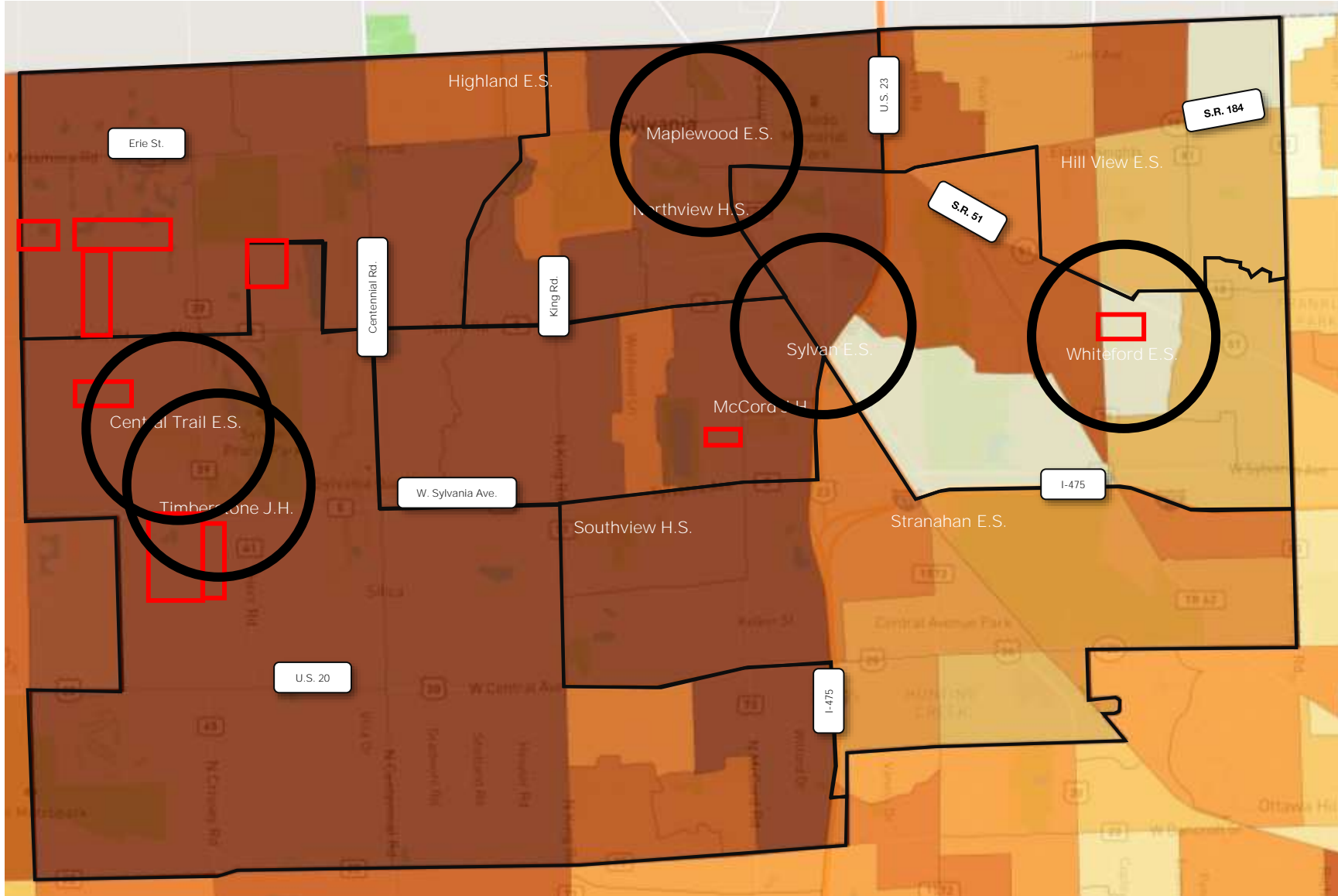

- Proposed New Developments
- Schools with Projected Impact
 - Central Trail E.S.
 - Maplewood E.S.
 - Sylvan E.S.
 - Timberstone J.H.
 - Whiteford E.S.

Population/Households Forecast (Households) 2023 - 2028 Percent Change By Blockgroup

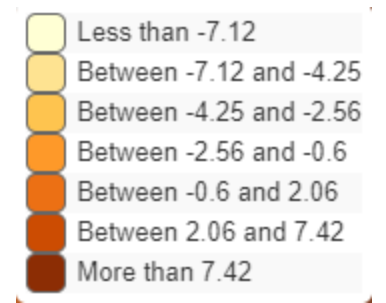

Information from Power Schools Predictive Enrollment Analytics – Sylvania Schools 2024 Moderate Study

New Development



View from Central Trail

Capacity Generating Classrooms

Design Capacity calculated based on the OFCC standard of 25 students per classroom. Capacity Generating Classrooms are based on OFCC traditional standards

Elementary School (K-5)

- General Classrooms

Jr. High School (6-8)

- General Classrooms
- Science Labs
- STEM

High School (9-12)

- General Classrooms
- Science Labs
- STEM
- Art
- Music
- Career Tech

PROGRAMMING KEY :

- FACULTY & STAFF
- CLASSROOM
- COMPUTER LAB / MEDIA CENTER
- SPECIALTY CLASSROOM
- MUSIC ROOM
- GYM
- PRE K / KINDERGARTEN ROOM
- SPECIAL EDUCATION / INTERVENTION
- SUPPORT AREAS

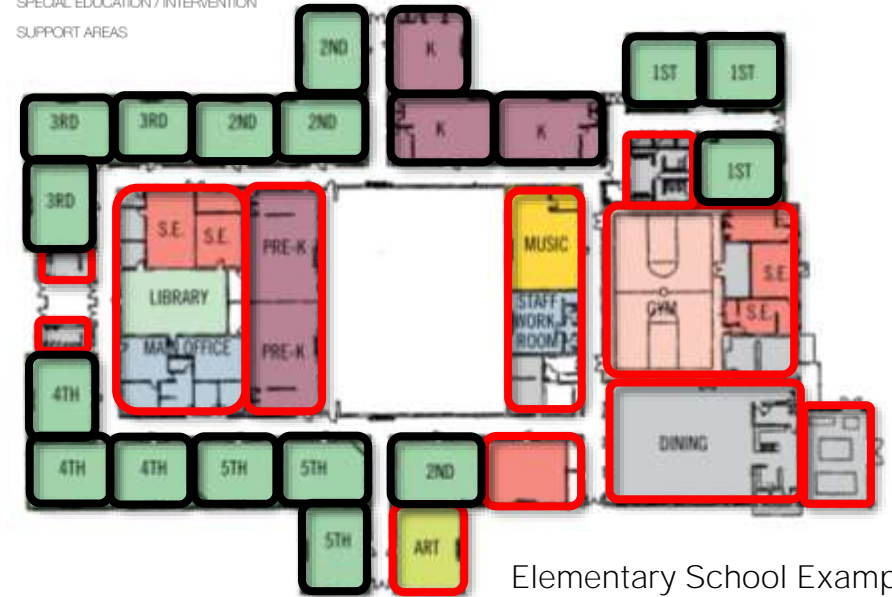

Elementary School Example

Please note that although they are growing contributors to space needs, Special Education classrooms and Pre-K are not capacity generating classrooms

Based on OFCC guidelines

In Addition to Enrollment Growth...

1. Increase in demand for dedicated Special Education classrooms
 - Percentage of moderate to intense cases have been rising each year
 - 7 additional dedicated Special Education Classrooms will need to be added across the district next year
2. Reducing class size (occupancy) / student to teacher ratio to align with education goals
3. The desired addition collaboration spaces to facilitate 21st century teaching and learning
4. Potential additional specialty spaces to accommodate number of students
5. Improving quality of space i.e. reorganizing facilities to add natural light
6. ...

1. Teacher's Lounge and Sensory Room will be converted to dedicated S.E. classrooms
2. Existing larger dedicated S.E. classroom will be split into a smaller classroom and the Sensory Room

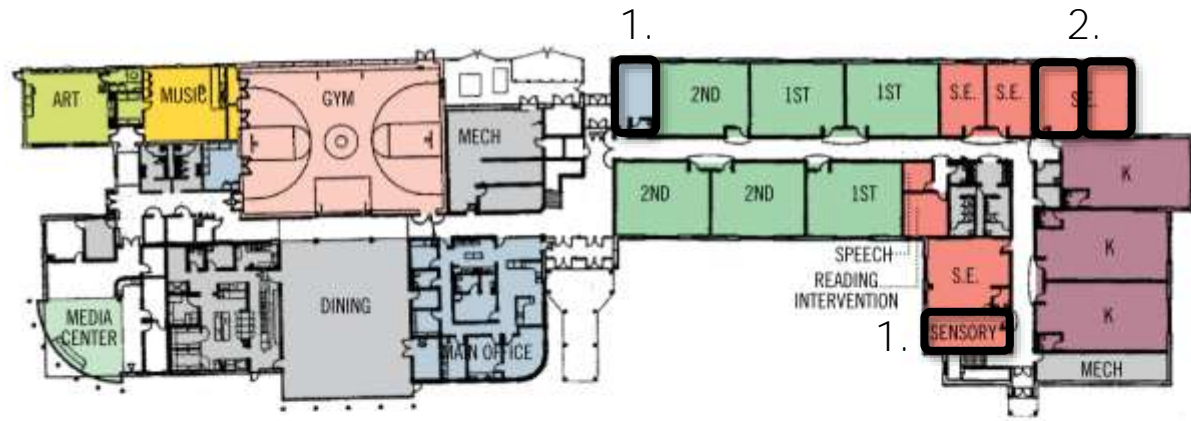

PROGRAMMING KEY :

	FACULTY & STAFF
	CLASSROOM
	COMPUTER LAB / MEDIA CENTER
	SPECIALTY CLASSROOM
	MUSIC ROOM
	GYM
	PRE K / KINDERGARTEN ROOM
	SPECIAL EDUCATION / INTERVENTION
	SUPPORT AREAS

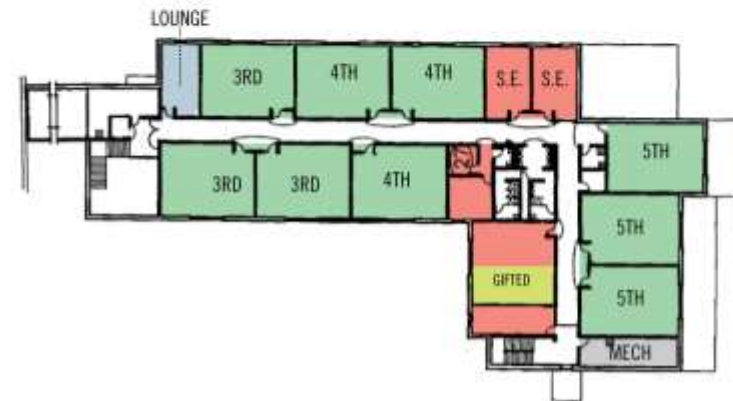

Hill View Example

THE COLLABORATIVE

Building	# of Classrooms	# of Sections	Class Size	Current Enrollment
Northview	1	1	17	17
Maplewood	4	5	27	135
Whiteford	2	4	16	64
Total:				216

Existing Preschool



Maplewood
4 Classrooms



Whiteford
2 Classrooms



Northview
1 Classroom / Career Tech Lab

Board Recommended Capacity

Class and Special Program Size by District Contract

- K-3 | 25 students per class
- 4-5 | 29 students per class
- 6-8 | 29 students per class
- 9-12 | 29 students per class

Special Education requirements vary from 16 to 6 students max based on intervention need*

**2014 Ohio Operating Standards for the Education of Children with Disabilities*

**ARTICLE VIII
CLASS AND SPECIAL PROGRAM SIZE**

A. Class Size Relief

1. When a class size exceeds 25 K-3 or exceeds 29 4-5, or exceeds 29 6-8, or exceeds 29 9-12, one of the following remedies will be exercised by the Superintendent or designee or the building principal, where applicable:
 - a. Leveling at the appropriate grade level within a building.
 - b. Transferring students to the appropriate grade level at another building.
 - c. Employment of a certificated aide. An aide added as relief will be assigned to the grade level, and schedules for the aide will be developed in collaboration with the building administration. Aides will travel with the class to special area classes.
 - d. Employment of an additional educator.
2. Elementary Procedure of Special Areas, i.e., Art, Music, Physical Education
 When a class size exceeds the above guidelines as stated in A above, one of the four options listed in A1 above, may be used. Class size will be limited to the same number of students as that of the homeroom teacher for whom the specialist is serving.
3. Secondary Procedures for Regular Classes and Special Areas, IE, Art, Music, Physical Education and Health
 When the average class size for any educator exceeds the number stated in A above in grades 6-12, relief will be provided as stated in A 1 a-d above.

B. Educating Students with Special Needs (formerly: Integrating Special Needs Students)

THE COLLABORATIVE

Classrooms

Scale

- Varying scales of classrooms across facilities
- Smallest 720 sf, largest 1350 sf, doesn't include dedicated SE classrooms
- 25-35+ sf per student – inline with space needed to facilitate active learning

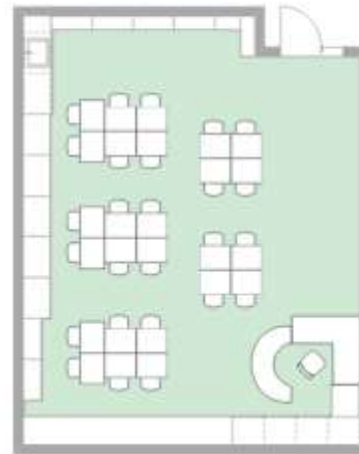

Central Trail / Stranahan
720-750 sf

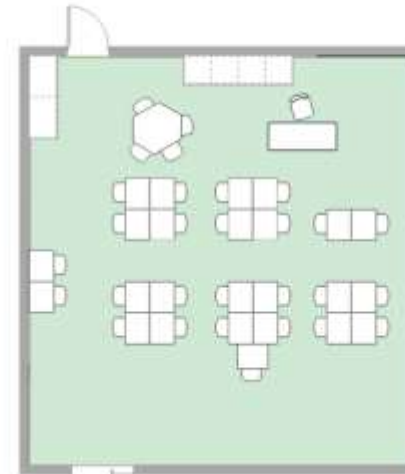

Sylvan / Whiteford / Highland
850 - 950 sf

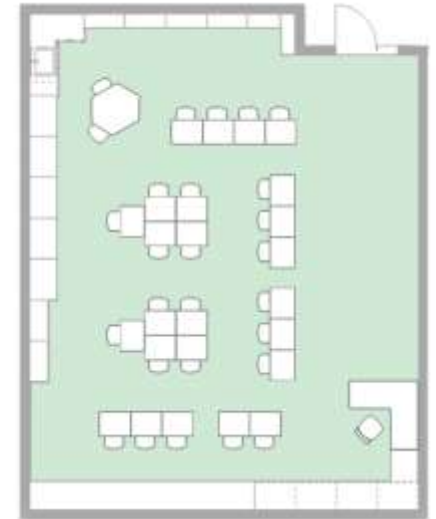

Hill View / Maplewood
970 - 1100 sf



What is the right classroom size for K-3 the district?

Class sizes currently range from 15-25 students



What is the right classroom size for K-3 the district?

20-22

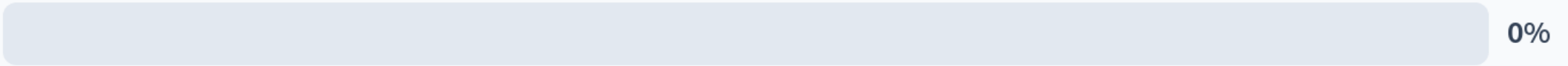

22-25

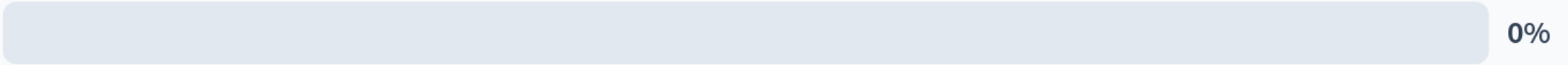

25



None of the above

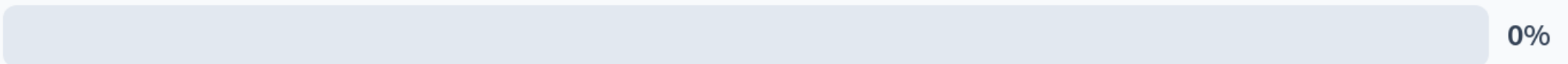

What is the right classroom size for 4-5 the district?

Class sizes currently range from 20-26 students



What is the right classroom size for 4-5 the district?

20-25

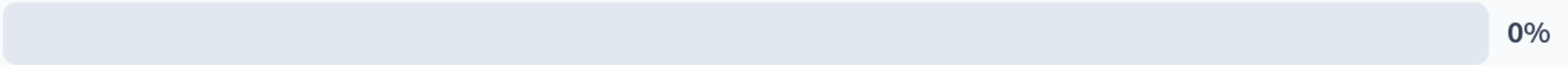

25-29

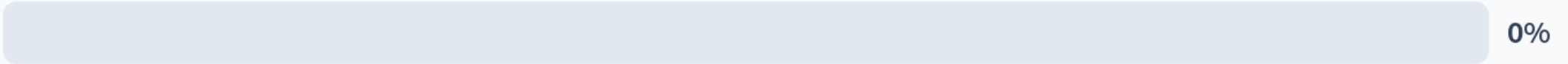

None of the above

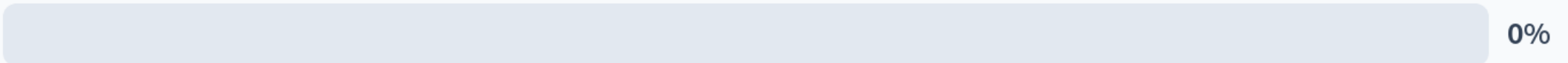

What is the right classroom size for Jr High and High School in the district?

Class sizes are 29 students maximum



What is the right classroom size for Jr High and High School in the district?

20-25

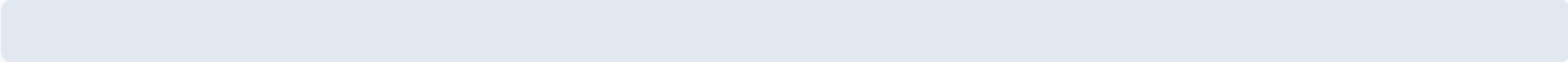

0%

25-29

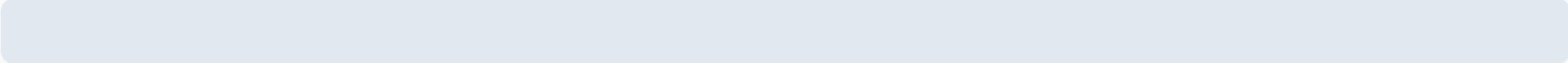

0%

>29

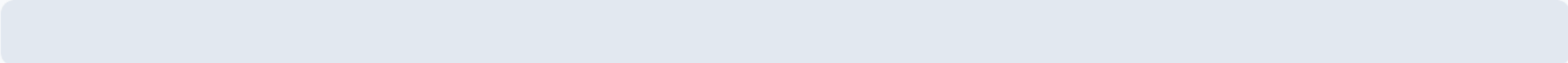

0%

None of the above

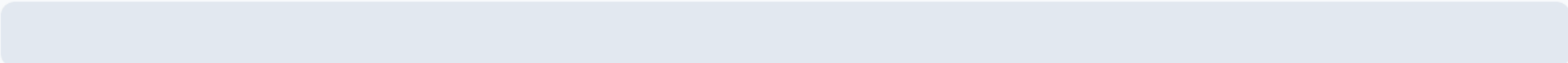

0%

Sub Committee Preference

Poll Everywhere

K-3 | 20-22 students per class

4-5 | 20-25 students per class

6-8 | 25-29 students per class

9-12 | 25-29 students per class

Special Education requirements vary from 16 to 6 students max based on intervention need*

**2014 Ohio Operating Standards for the Education of Children with Disabilities*



What is the right classroom size for K-3 the district?

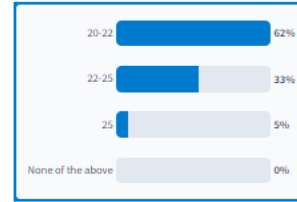

Response options	Count	Percentage
20-22	13	62%
22-25	7	33%
25	1	5%
None of the above	0	0%

What is the right classroom size for 4-5 the district?

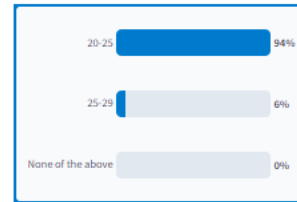

Response options	Count	Percentage
20-25	17	94%
25-29	1	6%
None of the above	0	0%

What is the right classroom size for Jr High and High School in the district?

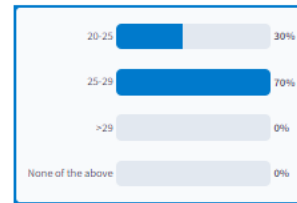

Response options	Count	Percentage
20-25	6	30%
25-29	14	70%
>29	0	0%
None of the above	0	0%

How should Sylvania Schools incorporate collaboration within learning environments?

Select all that apply

Teaching and Learning Environments
Subcommittee Responses

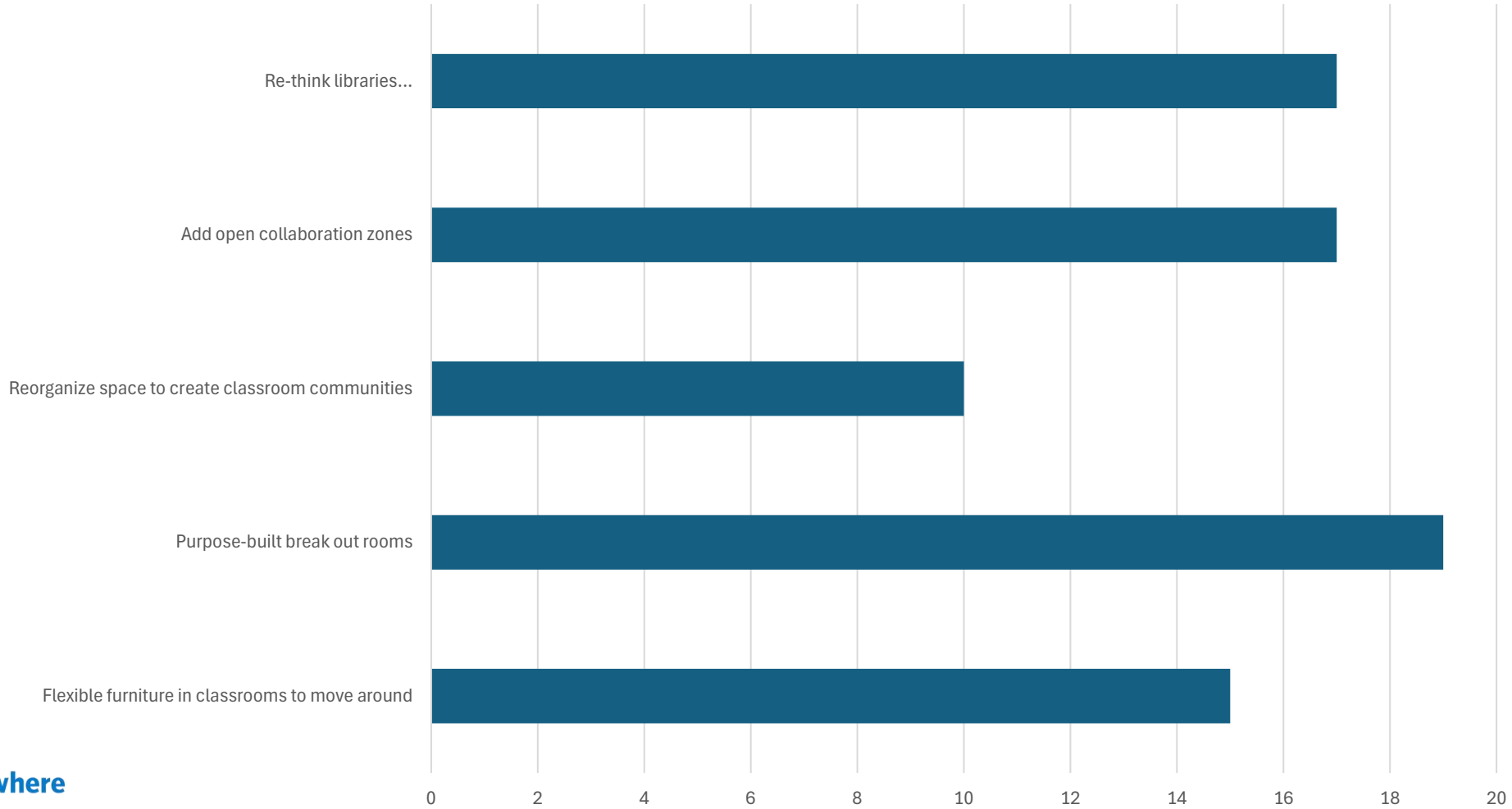

Building	# of Classrooms	Avg. sq-ft per room	Existing Design Capacity*	Current Enrollment (March 2024)	Delta
Central Trail	30	750	750	702	48
Highland	30	880	750	616	134
Hill View	18	970	450	364	86
Maplewood	20	1100	500	433	67
Stranahan	25	750	625	521	104
Sylvan	19	850	475	420	55
Whiteford	19	950	475	390	85
Arbor Hills	26	830	650	551	99
McCord	31	880	775	579	196
Timberstone	27	980	675	626	49
Northview	70	1000	1750	1329	421
Southview	60	880	1500	1169	331
Total:			9375	7700	1675

Facilities with Slight Current Space Deficits by Grade Level*

*Design Capacity calculated based on the OFCC standard of 25 students per classroom. Capacity Generating Classrooms are based on OFCC traditional standards for elementary, jr high, and high school. Special Education Classrooms and Pre-K are not factored into the Existing Design Capacity shown above. Other specialty spaces vary by Grade Bracket. Current Enrollment based on SYLVANIA SCHOOLS: Student Enrollment for 2023-2024 as of 3.18.2024

THE COLLABORATIVE

IN-PROGRESS Draft



 Facilities with Projected Space Deficits Overall*

 Facilities with Projected Space Deficits by Grade Level*

Building	# of Classrooms	Avg. sq-ft per room	Existing Design Capacity*	Current Enrollment (March 2024)	Delta	Projected Enrollment (Peak)	Projected Delta (Peak)
Central Trail	30	750	750	702	48	859	-109
Highland	30	880	750	616	134	592	158
Hill View	18	970	450	364	86	368	82
Maplewood	20	1100	500	433	67	425	75
Stranahan	25	750	625	521	104	568	57
Sylvan	19	850	475	420	55	483	-8
Whiteford	19	950	475	390	85	442	33
Arbor Hills	26	830	650	551	99	633	17
McCord	31	880	775	579	196	605	170
Timberstone	27	980	675	626	49	784	-109
Northview	70	1000	1750	1329	421	1377	373
Southview	60	880	1500	1169	331	1494	6
Total:			9375	7700	1675		

2027
2030
2033

*Design Capacity calculated based on the OFCC standard of 25 students per classroom. Capacity Generating Classrooms are based on OFCC traditional standards for elementary, jr high, and high school. Special Education Classrooms and Pre-K are not factored into the Existing Design Capacity shown above. Other specialty spaces vary by Grade Bracket. Current Enrollment based on SYLVANIA SCHOOLS: Student Enrollment for 2023-2024 as of 3.18.2024. Projected enrollment based on Moderate Enrollment Projections done by Power Schools

Existing Facilities Design Capacity by Building
Projected Peak Enrollment (Moderate Growth)*

Existing Facilities Design Capacity by Grade
Projected Peak Enrollment (Moderate Growth)*

Grade	# of Classrooms	Occupancy per Room	Avg. sq-ft per room	Existing Design Capacity*	Current Enrollment	Delta	Projected Enrollment (Peak)	Projected Delta	
K	26	25	1169	650	538	112	559	91	2027
1st	28	25	917	700	570	130	591	109	
2nd	28	25	889	700	568	132	607	93	
3rd	26	25	889	650	577	73	642	8	
4th	27	25	891	675	587	88	656	19	
5th	26	25	891	650	606	44	682	-32	
6th-8th	84	25	897	2100	1756	344	2022	78	2030
9th-12th, 23	130	25	940	3250	2498	752	2831	419	2033
Total:	375			9375	7700	1675	8590	785	

*Design Capacity calculated based on the OFCC standard of 25 students per classroom. Capacity Generating Classrooms are based on OFCC traditional standards for elementary, jr high, and high school. Special Education Classrooms and Pre-K are not factored into the Existing Design Capacity shown above. Other specialty spaces vary by Grade Bracket. Current Enrollment based on SYLVANIA SCHOOLS: Student Enrollment for 2023-2024 as of 3.18.2024. Projected enrollment based on Moderate Enrollment Projections done by Power Schools

THE COLLABORATIVE

**Design Capacity calculated based on the OFCC standard of 25 students per classroom. Capacity Generating Classrooms are based on OFCC traditional standards for elementary, jr high, and high school. Special Education Classrooms and Pre-K are not factored into the Existing Design Capacity shown above. Other specialty spaces vary by Grade Bracket. Current Enrollment based on SYLVANIA SCHOOLS: Student Enrollment for 2023-2024 as of 3.18.2024. Projected enrollment based on Moderate Enrollment Projections done by Power Schools*

Facilities with Grade Levels
Currently Just Over Capacity*



Highland Elementary
– 5th Grade (-4)

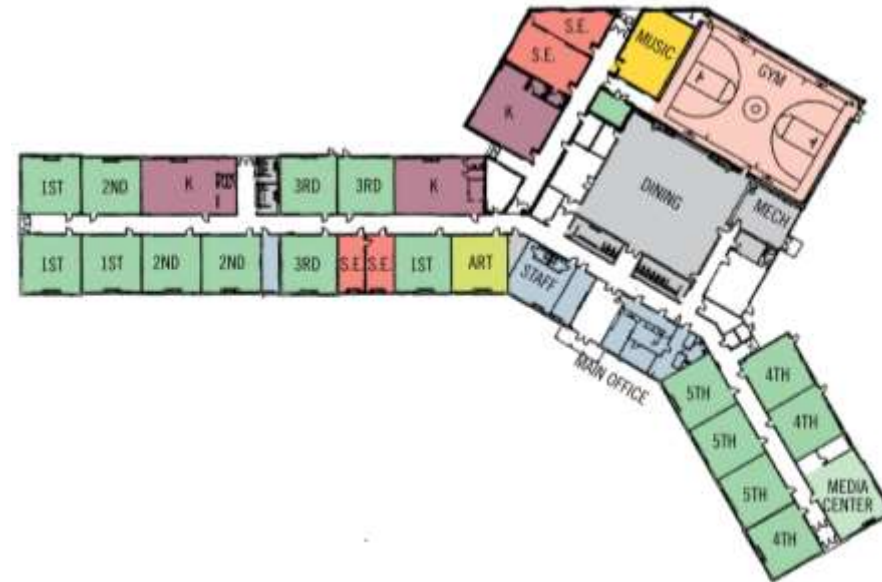

Sylvan Elementary
– Kindergarten (-1)

THE COLLABORATIVE

**Design Capacity calculated based on the OFCC standard of 25 students per classroom. Capacity Generating Classrooms are based on OFCC traditional standards for elementary, jr high, and high school. Special Education Classrooms and Pre-K are not factored into the Existing Design Capacity shown above. Other specialty spaces vary by Grade Bracket. Current Enrollment based on SYLVANIA SCHOOLS: Student Enrollment for 2023-2024 as of 3.18.2024. Projected enrollment based on Moderate Enrollment Projections done by Power Schools*



Facilities with Grade Levels Projected Over Capacity in Fall 2024*



Sylvan Elementary
– 3rd, 4th, 5th



Whiteford Elementary
– 5th

Central Trail Elementary
– 1st, 2nd, 3rd, 4th, 5th



Maplewood Elementary
– 3rd, 5th

THE COLLABORATIVE



**Design Capacity calculated based on the OFCC standard of 25 students per classroom. Capacity Generating Classrooms are based on OFCC traditional standards for elementary, jr high, and high school. Special Education Classrooms and Pre-K are not factored into the Existing Design Capacity shown above. Other specialty spaces vary by Grade Bracket. Current Enrollment based on SYLVANIA SCHOOLS: Student Enrollment for 2023-2024 as of 3.18.2024. Projected enrollment based on Moderate Enrollment Projections done by Power Schools*



Facilities with Projected to be Over Capacity in Fall 2026*

THE COLLABORATIVE

**Design Capacity calculated based on the OFCC standard of 25 students per classroom. Capacity Generating Classrooms are based on OFCC traditional standards for elementary, jr high, and high school. Special Education Classrooms and Pre-K are not factored into the Existing Design Capacity shown above. Other specialty spaces vary by Grade Bracket. Current Enrollment based on SYLVANIA SCHOOLS: Student Enrollment for 2023-2024 as of 3.18.2024. Projected enrollment based on Moderate Enrollment Projections done by Power Schools*

Learning Environments without access to Natural Light



Arbor Hills Junior High School



Southview High School

Facilities Projected to be Near Capacity*

THE COLLABORATIVE



The following are examples not recommendations at this point...

Reorganizing, not adding capacity

- Shifting Classroom / space designations in individual buildings i.e. flipping a 4th grade classroom to 5th grade based on the need from year to year
- Adjusting neighborhood school boundaries, could be year by year i.e. a portion of Central Trail's northern boundary shifts to Highland, or a portion of Timberstone's northern boundary shifts to McCord

Adding capacity, but decreasing quality

- Increasing class sizes in existing facilities
- Adding Trailers / Portable classrooms to existing facilities

Adding capacity and potential to enhance quality

- Reconfigure grade bands / configurations within existing facilities (may require renovation to make suitable for shift in use) i.e. Elementary schools shift to K-4, an existing facility becomes 7-8 and potentially combine, one high school becomes 9th grade and Career Tech and the other becomes 10-12
- Expanding and renovating existing facilities to accommodate growth
- Building new facilities

Which strategies for accommodating growth do you prefer? *Please select up to three*

- a. Increase class sizes in existing facilities
- b. Install trailers/portable classrooms outside existing facilities
- c. Expand existing facilities to accommodate growth
- d. Construct a new facility
- e. Adjust neighborhood school boundaries to maximize building capacity
- f. Change existing grade configurations within facilities (e.g., transition a facility to an intermediate school serving grades 5-6)
- g. Not sure



We're exploring different strategies to address increased enrollment in our district's facilities. Which of the following options would you prefer? Please select up to three



We're exploring different strategies to address increased enrollment in our district's facilities.
Which of the following options would you prefer?

Please select up to three

Teacher/Staff Responses

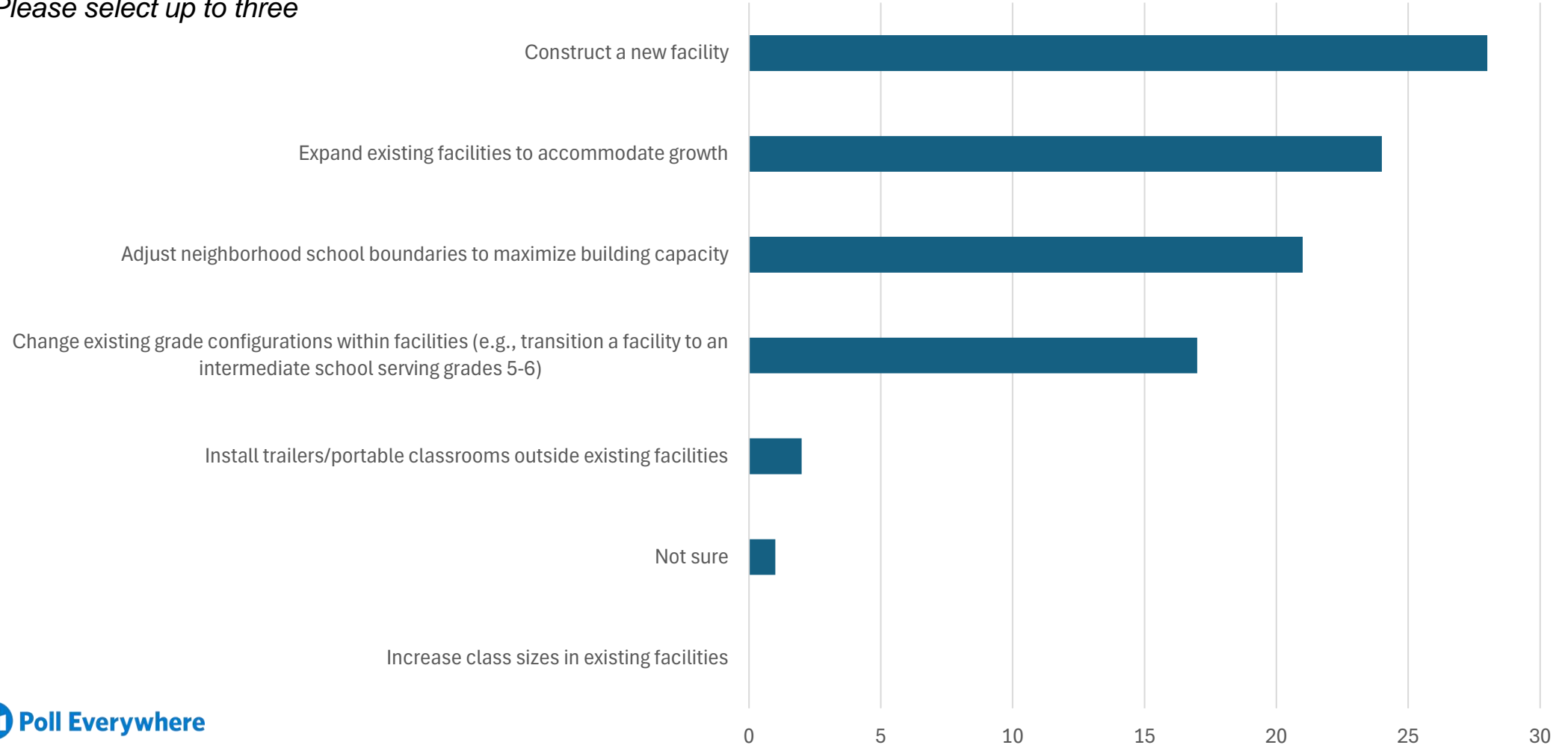

Agenda

- 1 Introductions
- 2 What we heard...
- 3 Projected Enrollment & Capacity
- 4 Critical Infrastructure Improvements**
- 5 Existing Learning Environments
- 6 Next Steps

THE COLLABORATIVE

Elementary Schools (7)

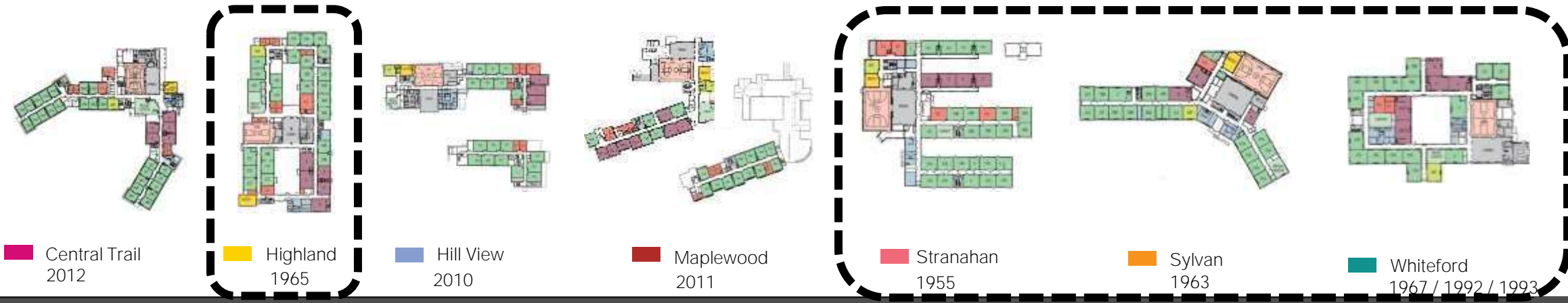

Built 1970 or before

Junior High Schools (3)

High Schools (2)

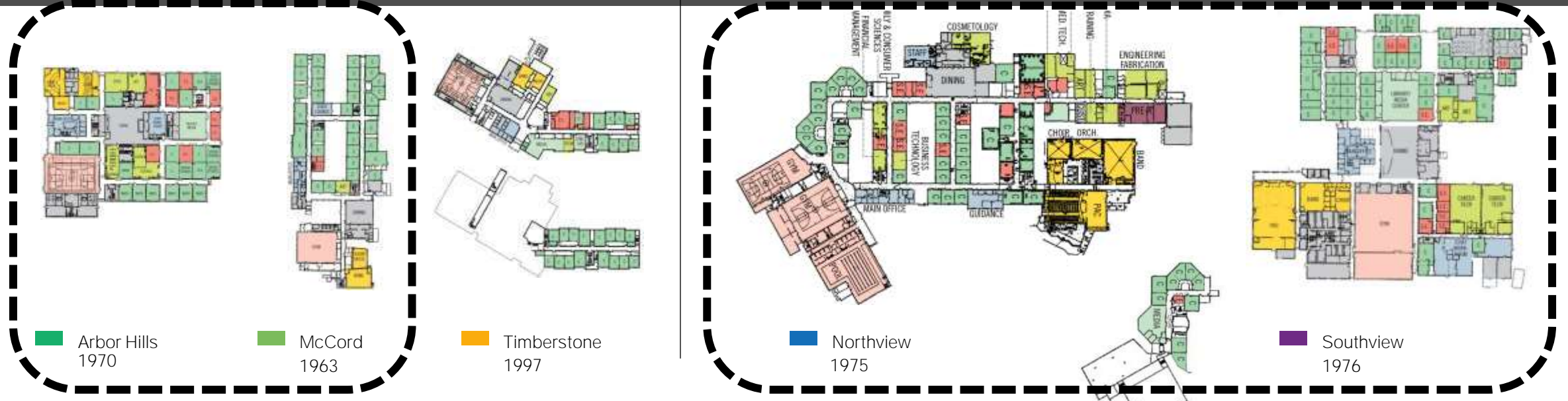

Summary

System	2022	2023	2024	2025	2026	2027	2028	2029	2030	2031	2032	2033	2034	2035	2036	2037	2038	2039	2040	2041	2042
Cumulative Needs by Year	\$ 25,148,474	\$ 25,388,474	\$ 25,528,775	\$ 25,852,473	\$ 27,554,427	\$ 32,809,009	\$ 34,211,434	\$ 39,516,751	\$ 52,386,171	\$ 53,512,949	\$ 60,683,370	\$ 73,559,538	\$ 97,348,825	\$ 101,791,870	\$ 104,745,813	\$ 114,285,813	\$ 115,925,940	\$ 117,571,600	\$ 120,006,400	\$ 123,878,477	\$ 130,729,014
Needs by Year	\$ 25,148,474	\$ 240,000	\$ 140,301	\$ 323,698	\$ 1,701,954	\$ 5,054,582	\$ 1,602,425	\$ 5,305,317	\$ 12,869,420	\$ 1,126,778	\$ 7,170,421	\$ 12,876,168	\$ 23,789,287	\$ 4,443,045	\$ 2,953,943	\$ 9,540,000	\$ 1,840,127	\$ 1,645,660	\$ 2,434,800	\$ 3,872,077	\$ 7,050,537
Exterior Enclosure									1,347,252			303,451	1,507,024	431,158	423,378	816,885	49,715			82,543	165,212
Exterior Wall (Finishes)									1,243,018					1,103,976	390,702	303,107	229,416				
Exterior Windows																71,507	553,948	49,715			82,543
Exterior Doors									104,274			42,056	403,048	40,466							
Roofing	4,313,320							794,640	3,617,882	420,310	681,120				196,020			544,896			211,200
Roof Coverings	4,313,320							794,640	3,617,882	420,310	681,120				196,020			544,896			211,200
Interior Construction													670,875	7,516,661	1,271,770	555,329	985,890				
Interior Doors									16,000				115,597	1,234,355	361,516	138,334	195,315				
Specialties									420,89				5,078	6,380	11,8254	10,475					
Interiors				65,472	110	2,032,09	2,123	141,14	678	4,910,016	88,069	1,64,931	6,168				87,211				1,460,615
Ceiling Finishes						195,74				678			4,910,016	79,026		91,412					87,211
Floor Finishes						672,33		89,125	141,14				1,13,519	618							
Wall Finishes				65,472	65,559	2,332															
Plumbing	7,611,899	98,357			460,728	1,045,795									540,159	6,193,980	677,934	528,245	1,151,039	1,677,973	1,930,754
Domestic Water Distribution	2,537,932	22,859			192,889	367,868												122,766	371,991	220,703	253,950
Plumbing Fixtures															540,159	6,193,980	677,934			728,320	838,045
Sanitary Waste	5,073,967	75,498			267,839	677,927												405,479	779,048	728,950	838,759
HVAC	3,945,830	14,000		282,9	1,27,085	76,632	1,035,540	360,700	1,421,5	7,343,28	671,7	224,007					426,030	185,730	778,127	370,185	379,648
Controls and Instrumentation										1,069,1		3,047,209	1,146,991	220,407							
Cooling Generation		14,000		6,9			1,030,260	38,2		728,330	476,770										15,540
Distribution System	3,828,560	111,03		275,8	38,89	1,522,290	20,900	38,160	279,7	1,326,655	52,750						152,570	175,555	607,352	319,235	363,148
Heat Generation	17,270								221,870	60,225							254,760	5,500	155,375		16,500
Terminal & Package Units		15,00			83,22	24,34	82,140	5,280		3,000	2,182,785										
Fire Protection			140,301	258,226	189,174	217,671		4,148,512							1,435,077	684,234					
Fire Alarms			140,301	258,226	189,174	217,671		4,148,512													
Sprinklers & Standpipe															1,435,077	684,234					
Electrical	8,747,625				708,176	1,131,981	25,795		109,093	78,823	128,701	3,695,969	11,414,160	1,611,264		63,635	486,448	386,789	505,634	1,541,396	2,903,108
Branch Wiring	8,642,520				708,176	1,131,981													377,769	421,979	781,439
Lighting												3,465,079	10,291,079	1,350,599							63,094
Service Distribution												34,491	115,870	234,389							
Exit Signs and Emergency Lighting	105,105						25,795		109,093	78,823	128,701	196,399	1,007,211	26,276				63,635	486,448	9,020	83,655
Site Infrastructure	629,800																				
Pedestrian Pavements	27,500																				
Veicular Pavements	602,300																				
Conveying									180,400					125,400	90,200						
Conveying Systems									180,400					125,400	90,200						

\$130 Million over the next 20 Years

*Info from Facilities Assessment prepared by Alpha Facilities Solutions in 2022

Summary														
System	Central Trail Elementary School	Highland Elementary School	Hill View Elementary School	Maplewood Elementary School	Whiteford Elementary School	Stranahan Elementary School	Sylvan Elementary School	Timberstone Junior High School	Arbor Hills Junior High	McCord Junior High School	Northview High School	Southview High School		
Total	\$ 7,978,134	\$ 8,665,413	\$ 5,755,684	\$ 6,654,826	\$ 6,390,577	\$ 7,492,066	\$ 5,505,642	\$ 11,313,964	\$ 8,712,422	\$ 8,775,867	\$ 28,368,264	\$ 25,971,616		

Summary														
System	Central Trail Elementary School	Highland Elementary School	Hill View Elementary School	Maplewood Elementary School	Whiteford Elementary School	Stranahan Elementary School	Sylvan Elementary School	Timberstone Junior High School	Arbor Hills Junior High	McCord Junior High School	Northview High School	Southview High School		
Total	\$ 7,978,134	\$ 8,665,413	\$ 5,755,684	\$ 6,654,826	\$ 6,390,577	\$ 7,492,066	\$ 5,505,642	\$ 11,313,964	\$ 8,712,422	\$ 8,775,867	\$ 28,368,264	\$ 25,971,616		
Exterior Enclosure	428,149	308,198	374,958	434,414	253,667	435,943	286,081	480,883	326,191	396,144	863,412	538,628		
Exterior Wall (Finishes)	229,416	226,635	261,395	303,107	196,046	303,107	189,094	390,702	240,539	251,662	624,290	400,435		
Exterior Windows	165,212	41,669	71,507	82,543	22,119	151,564	52,927	49,715	27,968	82,561	138,767	36,373		
Exterior Doors	33,521	39,894	42,056	48,764	35,502	66,086	44,060	40,468	57,684	61,921	100,355	101,820		
Roofing	681,120	794,640	263,938	420,310	601,656	726,528	433,272	559,680	860,310	998,976	2,236,476	2,466,420		
Roof Coverings	681,120	794,640	263,938	420,310	601,656	726,528	433,272	559,680	860,310	998,976	2,236,476	2,466,420		
Interior Construction	985,690	928,295	670,675	555,329	657,514	840,139	107,422	1,271,770	1,006,057	711,276	2,511,977	2,191,470		
Interior Doors	165,215	107,259	115,597	148,857	74,274	74,274	107,422	181,518	140,803	148,708	282,849	273,404		
Specialties	820,475	821,036	555,078	406,472	583,240	724,057	-	1,090,254	865,254	562,568	2,229,128	1,918,066		
Interiors	895,908	1,160,263	704,698	844,142	779,000	827,731	847,655	1,664,602	1,272,287	1,067,305	4,336,035	2,960,292		
Ceiling Finishes	423,810	468,623	273,171	368,328	336,440	312,159	415,184	559,578	464,094	554,888	1,359,621	1,116,633		
Floor Finishes	385,900	130,255	375,968	400,901	379,696	334,969	343,331	980,158	713,802	408,735	1,925,912	1,581,753		
Wall Finishes	86,198	561,375	55,559	74,913	62,864	77,578	192,165	124,865	94,391	103,682	1,050,502	261,868		
Plumbing	1,930,754	1,866,718	1,244,486	1,677,973	1,408,122	1,737,702	1,306,498	1,723,729	1,303,052	1,431,300	3,548,354	2,914,257		
Domestic Water Distribution	253,950	245,529	163,688	220,703	185,210	228,562	171,843	367,868	278,089	305,459	939,428	771,551		
Plumbing Fixtures	838,045	810,244	540,159	728,320	611,191	754,238	567,082	677,934	512,485	562,924	1,304,463	1,071,353		
Sanitary Waste	838,759	810,945	540,639	728,950	611,721	754,902	567,573	677,927	512,478	562,917	1,304,463	1,071,353		
HVAC	945,405	1,440,246	790,805	790,216	887,751	926,552	905,352	1,724,749	1,193,725	1,419,854	4,967,482	5,537,362		
Controls and Instrumentation	326,507	315,675	210,452	283,761	238,122	293,855	220,937	472,973	357,543	392,733	1,301,779	1,069,144		
Cooling Generation	-	145,145	38,280	102,630	109,450	114,510	116,380	223,630	-	145,145	619,080	1,380,500		
Distribution System	507,413	860,461	385,048	315,605	429,629	451,527	414,860	1,018,796	415,542	581,511	2,821,783	1,582,423		
Heat Generation	16,500	72,270	20,350	61,160	66,660	69,740	-	-	-	157,850	41,360	227,370		
Terminal & Package Units	94,985	46,695	136,675	88,220	49,390	-	83,435	9,350	420,640	142,615	183,480	1,277,925		
Fire Protection	217,671	210,450	140,301	189,174	158,748	195,903	147,291	1,025,825	258,226	283,641	1,543,346	2,702,619		
Fire Alarms	217,671	210,450	140,301	189,174	158,748	195,903	147,291	1,025,825	258,226	283,641	1,543,346	2,702,619		
Sprinklers & Standpipe	-	-	-	-	-	-	-	884,234	-	-	-	1,435,077		
Electrical	1,855,037	1,848,113	1,244,623	1,620,668	1,556,119	1,778,168	1,400,571	2,772,526	2,377,074	2,467,371	8,119,682	6,624,568		
Branch Wiring	781,439	755,526	503,692	679,135	569,916	703,313	528,785	1,131,961	855,720	939,941	3,449,043	2,832,692		
Lighting	932,357	901,428	600,956	810,295	679,971	839,118	630,910	1,350,599	1,020,997	1,121,471	3,449,056	2,832,693		
Service Distribution	12,540	103,471	43,511	11,000	240,087	154,111	179,505	132,770	401,039	296,866	827,553	683,630		
Exit Signs and Emergency Lighting	128,701	87,688	96,464	120,238	66,145	81,626	61,371	157,176	99,318	109,093	394,030	275,553		
Site Infrastructure	38,400	108,500	231,000	32,400	88,000	23,400	71,500	-	115,500	-	116,100	36,000		
Pedestrian Pavements	-	-	-	-	11,000	-	-	-	-	-	-	16,500		
Vehicular Pavements	38,400	108,500	231,000	32,400	77,000	23,400	71,500	-	115,500	-	99,600	36,000		
Conveying	-	-	90,200	90,200	-	-	-	-	90,200	-	-	125,400		
Conveying Systems	-	-	90,200	90,200	-	-	-	-	90,200	-	-	125,400		

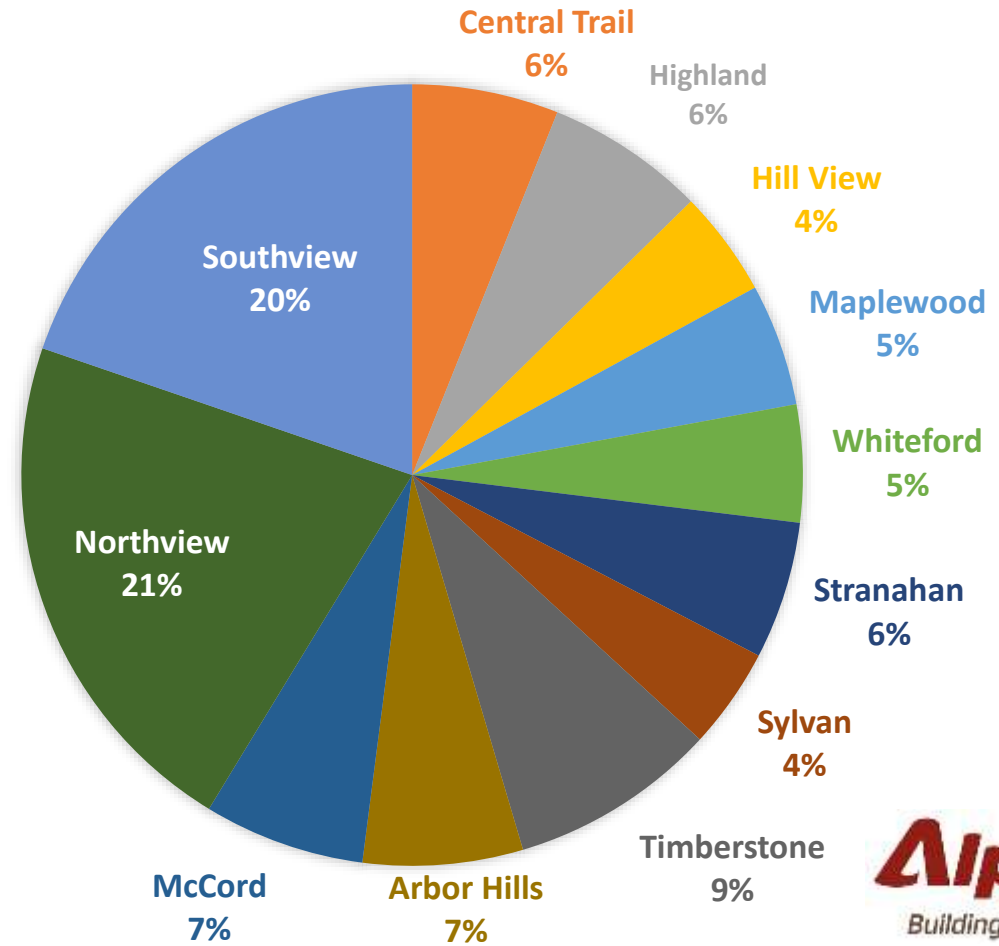

*Info from Facilities Assessment prepared by Alpha Facilities Solutions in 2022

THE COLLABORATIVE

The Ohio Facilities Construction Commission’s guideline establishes a benchmark to replace versus renovate standards for school facilities at $\frac{2}{3}$ (66%) of the cost of a new building. This means that if the cost of renovation exceeds $\frac{2}{3}$ the cost of a new building, the state will only fund new construction.



School	Square Footage	Deferred Maintenance Cost	Sf cost (New Construction)	Replacement Cost	% of Renovation vs Replacement Cost
Central Trail	72,557	\$ 7,978,134	\$310.27	\$22,512,260	35%
Highland	70,150	\$ 8,665,413	\$310.27	\$21,765,440	39%
Hill View	46,767	\$ 5,755,684	\$336.26	\$15,722,508	36%
Maplewood	63,058	\$ 6,654,826	\$323.81	\$20,418,811	32%
Whiteford	52,916	\$ 6,390,577	\$336.26	\$17,793,534	35%
Stranahan	65,301	\$ 7,492,066	\$323.81	\$21,145,116	35%
Sylvan	49,097	\$ 5,505,642	\$336.26	\$16,509,357	33%
Timberstone	105,105	\$ 11,313,964	\$299.00	\$31,426,395	36%
Arbor Hills	79,454	\$ 8,712,422	\$318.15	\$25,278,290	34%
McCord	87,274	\$ 8,775,867	\$318.15	\$27,766,223	31%
Northview	268,408	\$ 28,368,264	\$302.91	\$81,303,467	34%
Southview	220,442	\$ 25,971,616	\$302.91	\$66,774,086	38%

*Info from Facilities Assessment prepared by Alpha Facilities Solutions in 2022



Deferred Maintenance - Priorities

THE COLLABORATIVE



Cost of Cumulative Needs

High Priority (2022-2027) | \$32,609,009

Medium Priority (2028-2035) | \$69,182,861

Low Priority (2036-2042) | \$28,937,144

Summary			
System	High 2022 - 2027	Medium 2028 - 2035	Low 2036 - 2042
Cumulative Needs	\$ 32,609,009	\$ 69,182,861	\$ 28,937,144
Exterior Enclosure	-	3,588,935	1,537,733
Exterior Wall (Finishes)	-	2,999,091	532,523
Exterior Windows	-	-	922,925
Exterior Doors	-	589,844	82,285
Roofing	4,313,320	5,709,972	756,096
Roof Coverings	4,313,320	5,709,972	756,096
Interior Construction	-	10,896,595	1,541,019
Interior Doors	-	1,547,914	314,072
Specialties	-	9,348,681	1,226,947
Interiors	2,158,636	13,673,446	1,527,826
Ceiling Finishes	201,270	6,384,069	67,211
Floor Finishes	672,003	7,289,377	-
Wall Finishes	1,285,363	-	1,460,615
Plumbing	9,216,779	-	12,700,084
Domestic Water Distribution	3,121,548	-	969,410
Plumbing Fixtures	-	-	8,978,438
Sanitary Waste	6,095,231	-	2,752,236
HVAC	4,897,320	13,705,596	2,868,065
Controls and Instrumentation	-	5,483,481	-
Cooling Generation	21,670	2,267,540	705,540
Distribution System	4,754,760	3,339,985	1,631,335
Heat Generation	17,270	283,855	432,135
Terminal & Package Units	103,620	2,330,735	99,055
Fire Protection	805,372	4,148,512	2,119,311
Fire Alarms	805,372	4,148,512	-
Sprinklers & Standpipe	-	-	2,119,311
Electrical	10,587,782	17,063,805	5,887,010
Branch Wiring	10,482,677	-	3,122,583
Lighting	-	15,106,757	63,094
Service Distribution	-	384,750	2,701,333
Exit Signs and Emergency Lighting	105,105	1,572,298	-
Site Infrastructure	629,800	-	-
Pedestrian Pavements	27,500	-	-
Vehicular Pavements	602,300	-	-
Conveying	-	396,000	-
Conveying Systems	-	396,000	-

*Info from Facilities Assessment prepared by Alpha Facilities Solutions in 2022



When considering the future of a school building, which factors should be prioritized?

Please select up to three

- a. Safety and security of the school
- b. Physical condition of the school
- c. Ability to accommodate increase in enrollment
- d. Ability to accommodate increase in enrollment on current site
- e. Facility is overcrowded or underutilized
- f. The school building doesn't have the right spaces for the current programs being taught
- g. Overall cost of the project
- h. Other
- i. Not sure



When considering the future of a school building, which factors should be prioritized? Please select up to three

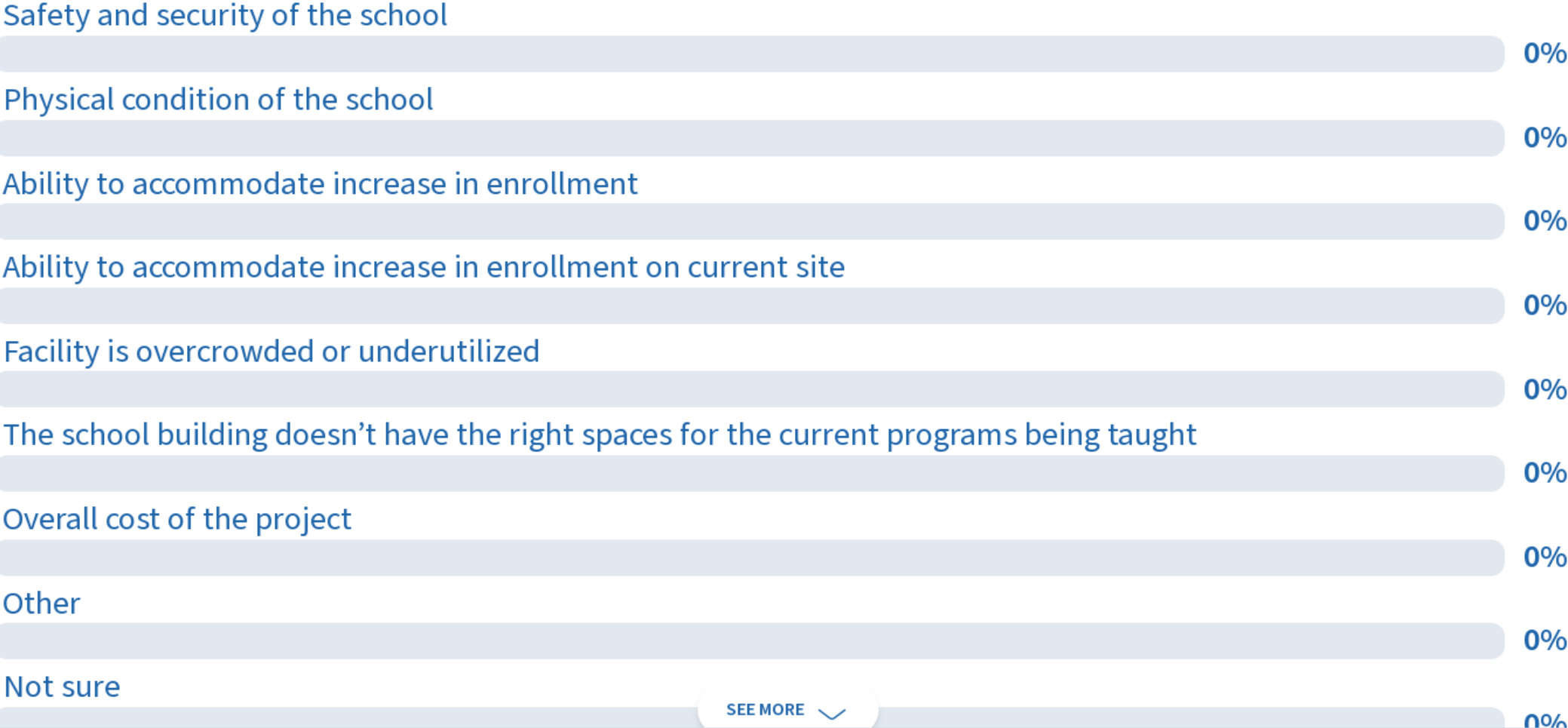

SEE MORE

When considering the future of a school building, which factors should be prioritized?

Please select up to three

Teacher / Staff Responses

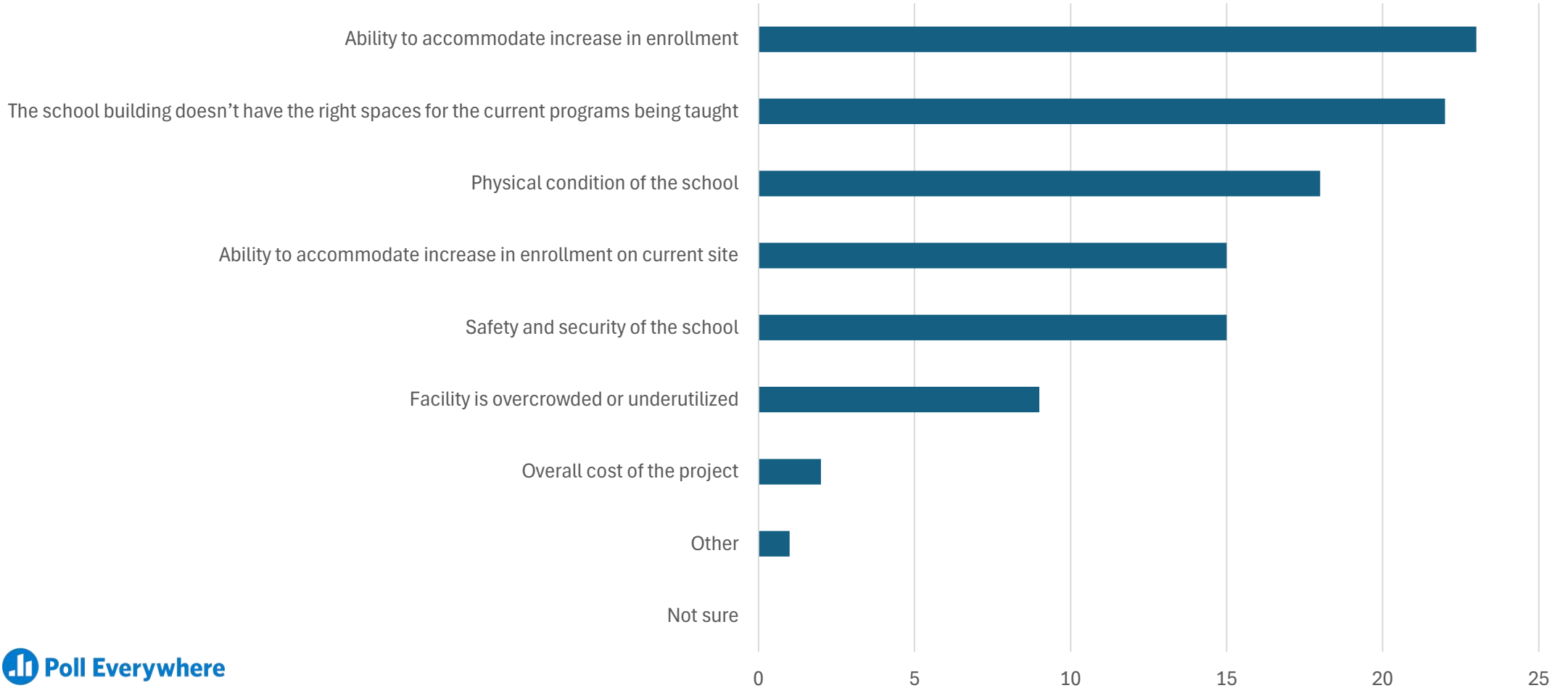

Agenda

- 1 Introductions
- 2 What we heard...
- 3 Projected Enrollment & Capacity
- 4 Critical Infrastructure Improvements
- 5 Existing Learning Environments**
- 6 Next Steps

THE COLLABORATIVE

Quality of Light

- Natural light in most classrooms, but some lacking e.g. Southview, Arbor Hills
- Many classrooms have opted for “light filters” over fluorescent lights



Maplewood Elementary School



Southview High School

THE COLLABORATIVE

Furniture, Storage & Technology

- Varying amounts of in-classroom storage based on vintage, Jr. High and High Schools have less
- Varying amount modalities in each classroom – impacts on storage
- Functional furniture, not necessarily flexible
- Limited power outlets
- Technology improves from Elementary, to Jr High, and High School
 - Smart Boards & Projectors in K-8 classrooms
 - Interactive displays in High School Classrooms



THE COLLABORATIVE

Furniture, Storage & Technology

- Varying amounts of in-classroom storage based on vintage, Jr. High and High Schools have less
- Varying amount modalities in each classroom – impacts on storage
- Functional furniture, not necessarily flexible
- Limited power outlets
- Technology improves from Elementary, to Jr High, and High School
 - Smart Boards & Projectors in K-8 classrooms
 - Interactive displays in High School Classrooms



McCord Jr. High School



Northview High School

THE COLLABORATIVE

Break Out Spaces

- Vary by building
- Group work, intervention done within classroom spaces
- Observed in hallways
- Some facilities have dedicated “pod” type spaces, like Timberstone
- Cafeterias utilized for commons type environment



Stranahan Elementary



Maplewood Elementary



Timberstone Jr. High School



Southview High School

THE COLLABORATIVE

Elementary Schools

- Stacks and desktop computers
- Some integrated technology
- Larger, stationary furniture
- Newer facilities have broader array of seating options
- Considerable amount of space, potential opportunity



Highland Elementary



Central Trail Elementary

THE COLLABORATIVE

Jr. High Schools

- Varying amount of stacks and desktop computers
- Some integrated technology
- More lounge type furniture, some moveable at Arbor Hills and McCord
- Considerable amount of space, potential opportunity



Arbor Hills Jr. High



McCord Jr. High School



Timberstone Jr. High School

THE COLLABORATIVE

High Schools

- Number of stacks and desktop computers
- Larger, stationary furniture
- “Think Tank” space at Northview has transitioned some amount of space for more lounge and makerspace type feel
- Considerable amount of space, potential opportunity



Southview High School



Northview High School

THE COLLABORATIVE

Art Rooms

- Varying amounts of storage
- Lack of display space
- Furniture appropriate, potential desire to be more flexible
- Less integrated technology
- High School Art rooms don't have Natural Light
- *Are demonstration areas appropriate?*
- *Are utilities adequate?*



Maplewood Elementary



Arbor Hills Jr. High



Northview High School



Southview High School

THE COLLABORATIVE

Music Rooms

- Adequate space for Elementary
- Potential need for additional practice space in High Schools
- Lack of Volume and Acoustical considerations at Southview and Timberstone
- Potential lack of lockable storage and large instrument storage
- *Recording capabilities?*
- ...



Central Trail Elementary



Maplewood Elementary



Timberstone Jr. High School



McCord Jr. High School

THE COLLABORATIVE

Music Rooms

- Adequate space for Elementary
- Potential need for additional practice space in High Schools
- Lack of Volume and Acoustical considerations at Southview and Timberstone
- Potential lack of lockable storage and large instrument storage
- *Recording capabilities?*
- ...



Northview High School



Southview High School

- Sylvania Schools offers 14 full Career Technical Education (CTE) programs.
- Available to all high school students alongside regular, honors, AP, and special education courses.
- These programs cover industry standards, providing practical skills and industry credentials.
- Students can earn college credits, participate in internships, and compete nationally.
- Located at Northview and Southview

Explore our programs.

Click on the icons to the right to visit a page for each program and learn about the courses, industry credentials, work-based learning, competition, and other opportunities they offer.

The image displays a grid of 14 circular icons, each representing a different Career Technical Education (CTE) program. The icons are arranged in four rows and four columns. The first row contains 'EDUCATION AND TRAINING' (with a green screen and people), 'THEATRICAL PERFORMING ARTS' (with a yellow and orange abstract shape), and 'HORTICULTURE' (with a green leaf). The second row contains 'MEDICAL TECHNOLOGIES' (with a blue caduceus), 'COSMETOLOGY' (with a purple bottle and fork), 'FAMILY and CONSUMER SCIENCES' (with a blue person silhouette), and 'VISUAL COMMUNICATION DESIGN' (with a red frame and computer monitor). The third row contains 'NORTHVIEW PROGRAMMING' (with a laptop screen), 'SOUTHVIEW PROGRAMMING' (with a laptop screen), 'BUSINESS TECHNOLOGY' (with two blue silhouettes), and 'INTERACTIVE MEDIA' (with a laptop screen and a starburst). The fourth row contains 'FINANCIAL MANAGEMENT' (with a green bar chart), 'ENGINEERING FABRICATION' (with blue gears and a hard hat), 'ENGINEERING AEROSPACE' (with a red and blue rocket), and 'CONSTRUCTION TECHNOLOGY' (with a black hammer).

THE COLLABORATIVE

Existing Programs

- Cosmetology
- Education & Training
- Aerospace and Mechanical Engineering
- Interactive Media
- Visual Communication Design
- Medical Technologies
- Business Technologies
- Financial Management
- Family & Consumer Sciences
- Programming

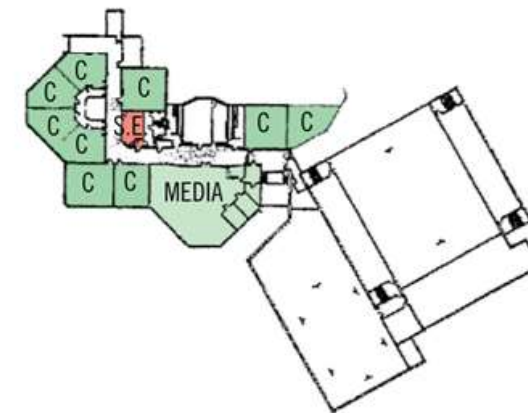
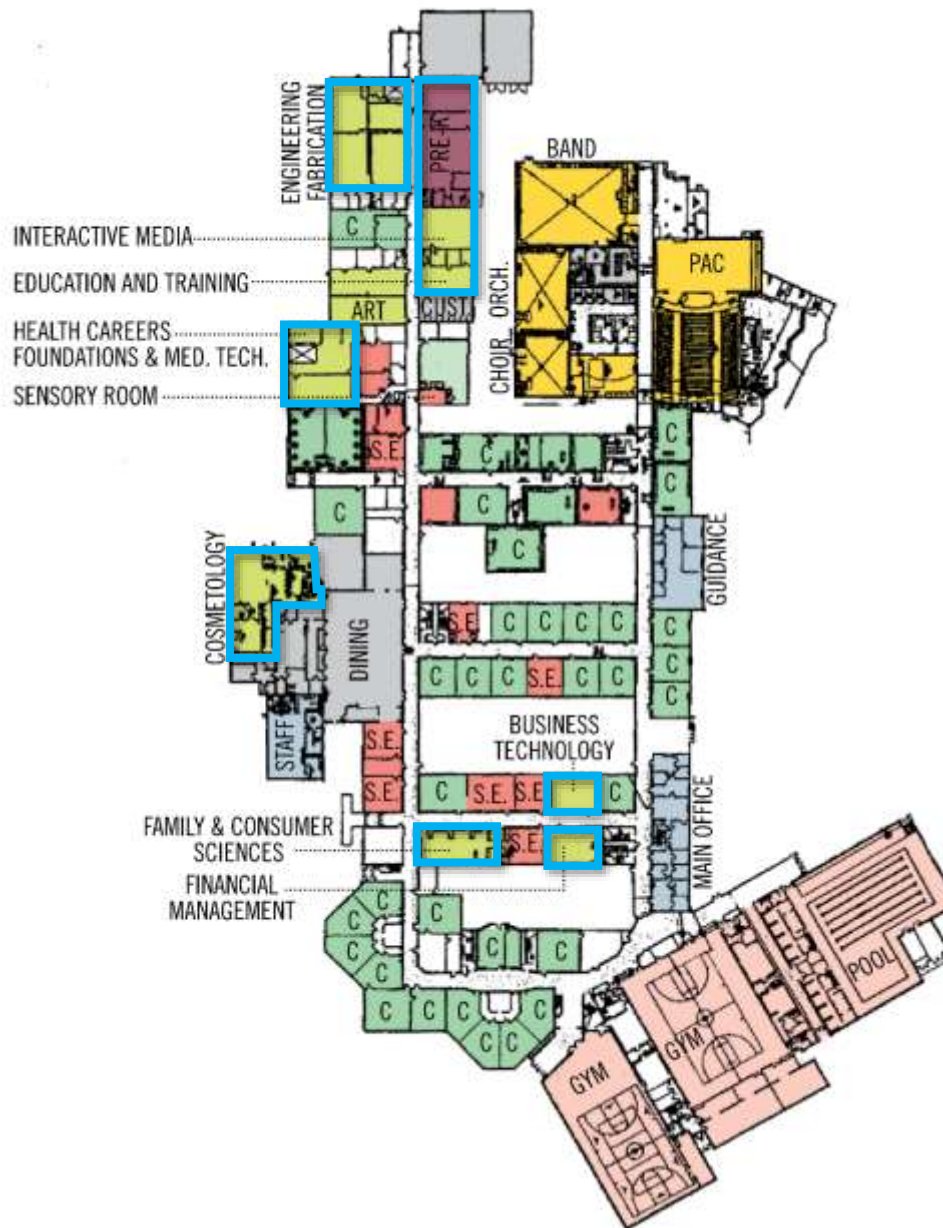

PROGRAMMING KEY :

	FACULTY & STAFF
	CLASSROOM
	COMPUTER LAB / MEDIA CENTER
	SPECIALTY CLASSROOM
	MUSIC ROOM
	GYM
	SPECIAL EDUCATION
	SUPPORT AREAS

THE COLLABORATIVE

Existing Programs

- Cosmetology
- Education & Training
- Aerospace and Mechanical Engineering
- Interactive Media
- Visual Communication Design
- Medical Technologies
- Business Technologies
- Financial Management
- Family & Consumer Sciences
- Programming



Medical Technologies



Cosmetology



Interactive Media



Engineering

THE COLLABORATIVE

Existing Programs

- Horticulture
- Construction Technology
- Engineering and Fabrication Technology
- Medical Technologies
- Programming
- Theatrical Performing Arts



PROGRAMMING KEY :

	FACULTY & STAFF
	CLASSROOM
	COMPUTER LAB / MEDIA CENTER
	SPECIALTY CLASSROOM
	MUSIC ROOM
	GYM
	SPECIAL EDUCATION
	SUPPORT AREAS

THE COLLABORATIVE

Existing Programs

- Horticulture
- Construction Technology
- Engineering and Fabrication Technology
- Medical Technologies
- Programming
- Theatrical Performing Arts



Engineering & Fabrication



Construction Technology



Programming

Should Sylvania's Career Tech programs be co-located in a single facility?



Should Sylvania's Career Tech programs be co-located in a single facility?

One location

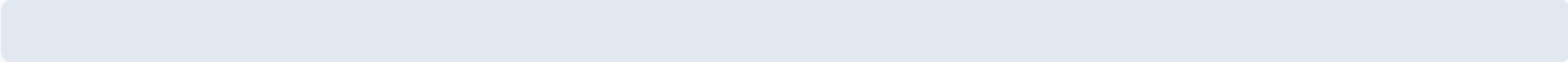

0%

Both high schools

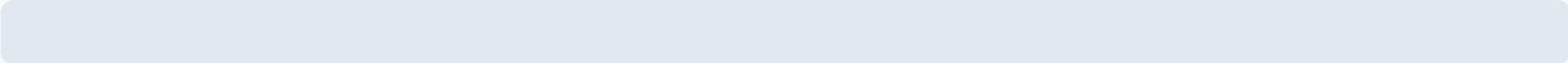

0%

None of the above

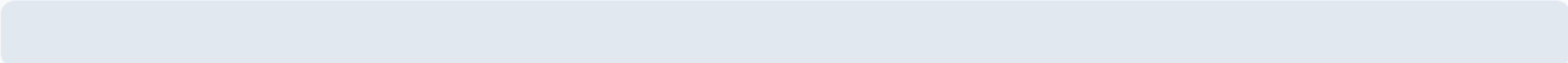

0%

Are there other Career Tech programs that should be added to Sylvania's offerings?



Are there other Career Tech programs that should be added to Sylvania's offerings?

Nobody has responded yet.

Hang tight! Responses are coming in.

Are there other facilities that need to be considered across the district?



Are there other facilities that need to be considered across the district?

Nobody has responded yet.

Hang tight! Responses are coming in.

Agenda

- 1 Introductions
- 2 What we heard...
- 3 Projected Enrollment & Capacity
- 4 Critical Infrastructure Improvements
- 5 Existing Learning Environments
- 6 Next Steps**

Preliminary Schedule

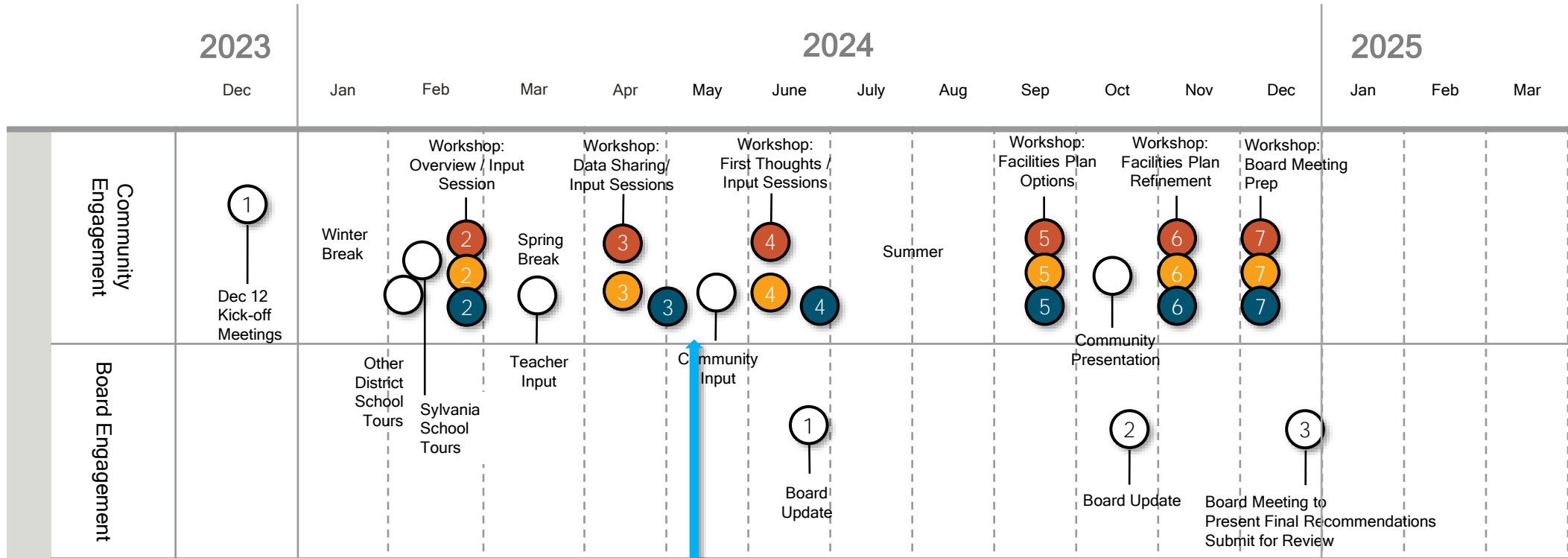

- Current & Future Facilities
- Teaching & Learning Environments
- Fiscal Responsibility

Dedicated Meeting to Discuss Special Education & Preschool