

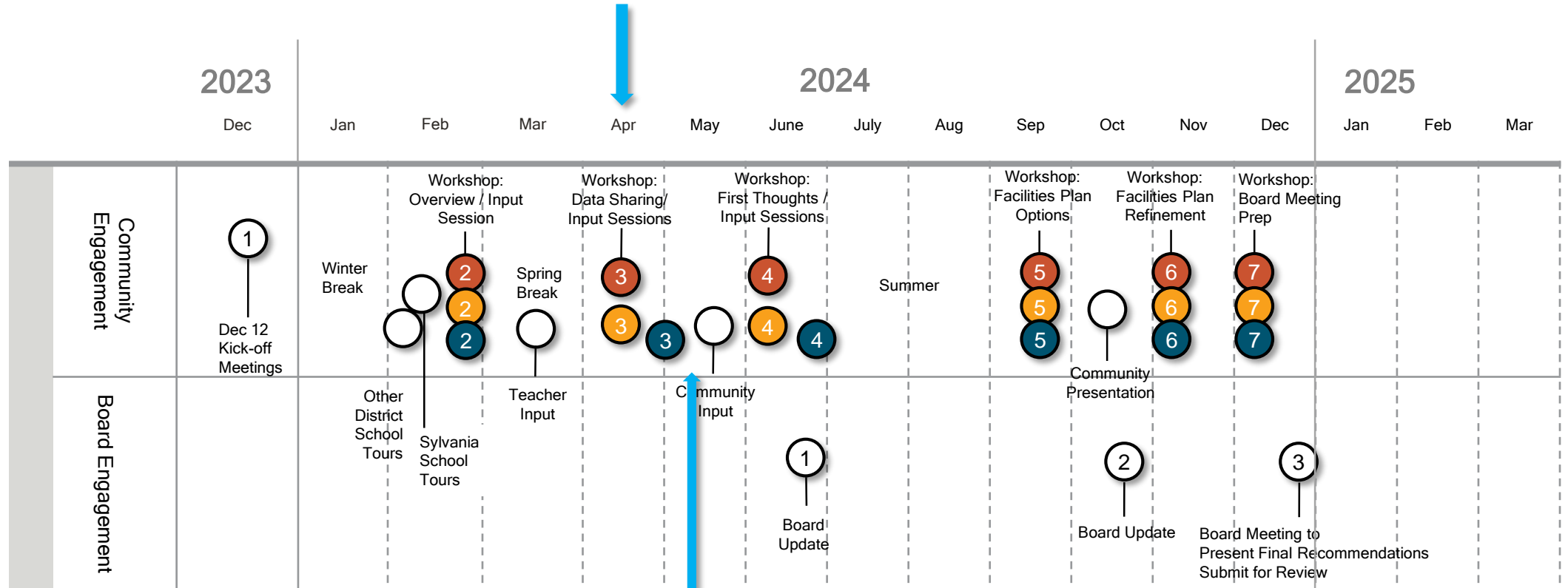

Superintendent's Coffee
Master Facilities Plan Update
Presented by Dr. Veronica Motley

May 17, 2024

Preliminary Schedule



- Current & Future Facilities
- Teaching & Learning Environments
- Fiscal Responsibility

Dedicated Meeting to Discuss Special Education & Preschool

Considerations for the Master Facilities Plan Committee will include:

- Enrollment and residential trends
- Reviewing the maintenance costs associated with the varying ages of buildings across the district (some that require/demand repair beyond typical upkeep.)
- **Preschool** services being provided are currently decentralized in classrooms designed for K-5 students.
- Explore potential grade configurations, redistricting to maximize, build/repurpose current buildings.
- Increase in diverse learning needs that require unique/special learning spaces.



Current Facilities & Future Needs

Enrollment trends and future needs and options

- Contribute unique insight/perspective and expertise relating to condition and viability (current/future) of existing facilities
- Lead exploration of enrollment trends and their affect on future facility needs
- Consider need for renovation of existing and/or creation of new facilities
- Understand deferred maintenance requirements, provide planning approaches to accomplish identified needs, and assist Financial Responsibility Committee to develop funding strategies
- Understand population growth and current and future space needs



Enrollment Projections - Fall 2024

Enrollment (Moderate Approach)

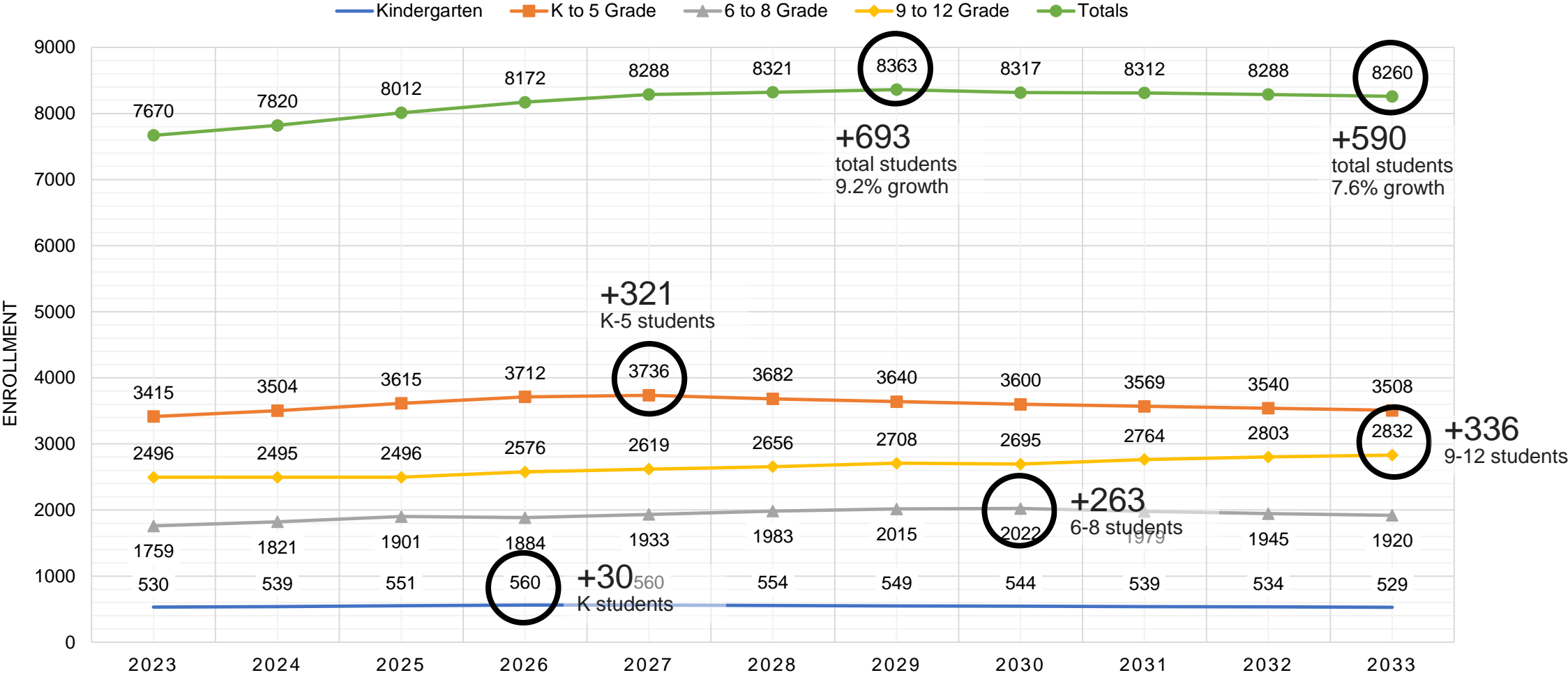

* Moderate projection is more suitable for facilities planning purposes

Analysis of Enrollment Projections Fall 2024 by Power Schools (March 27, 2024)

Projected District Growth



- Proposed New Developments
- Schools with Projected Impact
 - Central Trail E.S.
 - Maplewood E.S.
 - Sylvan E.S.
 - Timberstone J.H.
 - Whiteford E.S.

- Central Trail Elementary School
- Maplewood Elementary School
- Sylvan Elementary School
- Highland Elementary School
- Stranahan Elementary School
- Whiteford Elementary School
- Hill View Elementary School
- Timberstone Junior High
- McCord Junior High
- Arbor Hills Junior High
- Northview High School
- Southview High School

In Addition to Enrollment Growth...

1. Increase in demand for dedicated Special Education classrooms
 - Percentage of moderate to intense cases have been rising each year
 - 7 additional dedicated Special Education Classrooms will need to be added across the district next year
2. Reducing class size (occupancy) / student to teacher ratio to align with education goals
3. The desired addition collaboration spaces to facilitate 21st century teaching and learning
4. Potential additional specialty spaces to accommodate number of students
5. Improving quality of space i.e. reorganizing facilities to add natural light
6. ...

- 1. Teacher’s Lounge and Sensory Room will be converted to dedicated S.E. classrooms
- 2. Existing larger dedicated S.E. classroom will be split into a smaller classroom and the Sensory Room

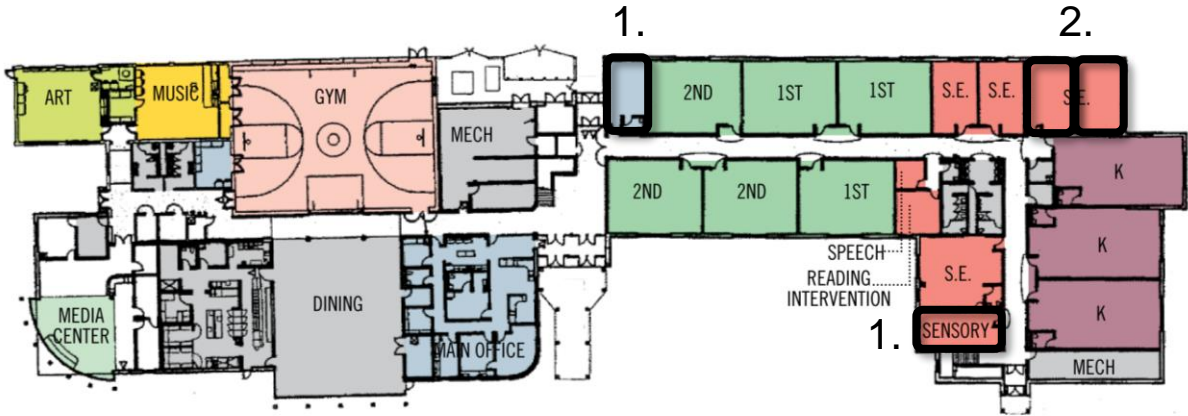

PROGRAMMING KEY :

	FACULTY & STAFF
	CLASSROOM
	COMPUTER LAB / MEDIA CENTER
	SPECIALTY CLASSROOM
	MUSIC ROOM
	GYM
	PRE K / KINDERGARTEN ROOM
	SPECIAL EDUCATION / INTERVENTION
	SUPPORT AREAS

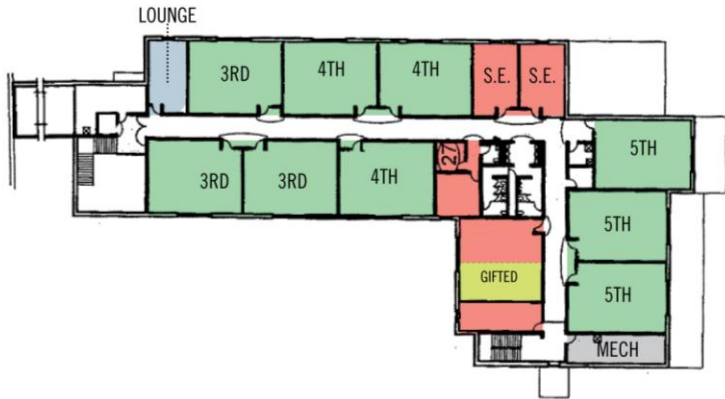

Hill View Example

What we heard...



THE COLLABORATIVE

Based on teachers' responses, key concerns in their district are:

- 1. Space and Overpopulation:** need for more classrooms due to increased enrollment, lack of appropriate space for preschool growth, and challenges accommodating new students
- 2. Student Behavior and Needs:** managing intense behaviors, supporting special needs students, and addressing student apathy, especially among those entering high school unprepared academically
- 3. Support and Resources:** lack of intervention teachers, administrative support, and funding, emphasizing the need for more resources to support both teachers and students
- 4. Follow-Through:** frustration with management issues and inconsistent follow-through on plans was highlighted, including rumors of organizational changes like redistricting



THE COLLABORATIVE

Based on teachers' responses, key concerns in their district are:

- 5. Safety and Mental Health Support:** importance of creating a positive emotional climate, providing mental health support, and addressing safety concerns such as discipline issues
- 6. Educational Quality and Equity:** maintaining educational standards, ensuring equity of resources, and meeting diverse student needs, including concerns about disappearing libraries and the need for career tech labs
- 7. Infrastructure and Academic Structure:** limitations of the daily class schedule, inadequate storage, and the need for changes to the physical environment were noted to support a conducive academic schedule



THE COLLABORATIVE

The following are themes that reflect the most cited improvements....

- 1. More Space(s):** desire for larger classrooms and functional, dedicated intervention spaces - rooms for group counseling, 5 specials gross motor activities, sensory rooms, and career tech classrooms connected to labs
- 2. Technology:** updated technology, including sound systems, more outlets for power, reliable wi-fi and Chromebooks, and access to 21st-century technology for teaching
- 3. Storage:** for modalities within individual classrooms, for specialty equipment and instruments within a building, and district wide solutions for furniture, technology, and other equipment



THE COLLABORATIVE

The following are themes that reflect the most cited improvements....

4. **Flexible Furniture:** updated furniture options with flexibility, functional layouts, and the ability to use space for changing educational needs
5. **Lighting and Temperature:** requests for improved lighting, including natural light, and maintaining comfortable temperatures in classrooms
6. **Safety Measures:** general concern for create safe teaching environments, visibility into classrooms was a concern
7. **Accessibility:** more accessible spaces and technology to meet the needs of all students, including those with disabilities



THE COLLABORATIVE

Most mentioned missing facilities include....

1. **Preschool Building:** desire for a centralized solution
2. **Career Tech Facility:** desire for a centralized solution
3. **Special Education Spaces:** desire for more dedicated, purpose-built spaces including, intervention areas, sensory rooms, autism-specific facilities
4. **Storage :** desire for improved solutions

Other responses include...

- Music Rooms
- Additional Elementary Building
- Larger Gyms and Indoor Sports Facilities
- Employee Break Rooms



THE COLLABORATIVE

Elementary Schools
(7)

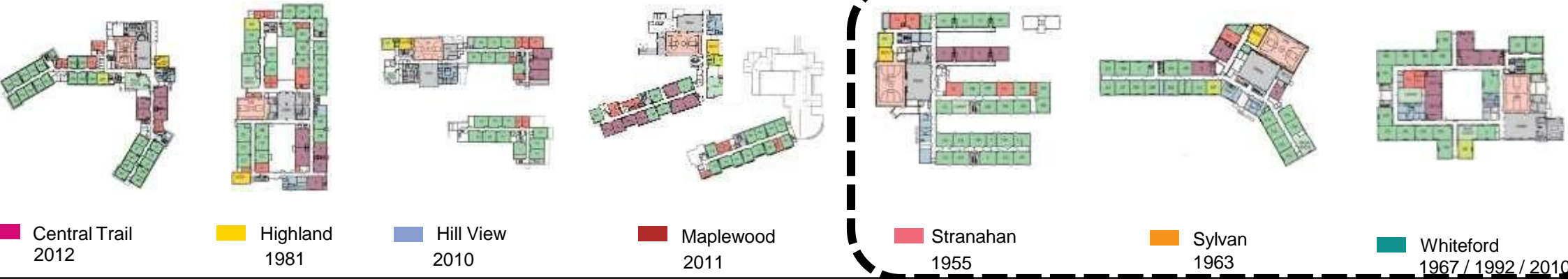

Built 1970 or before

Junior High Schools (3)

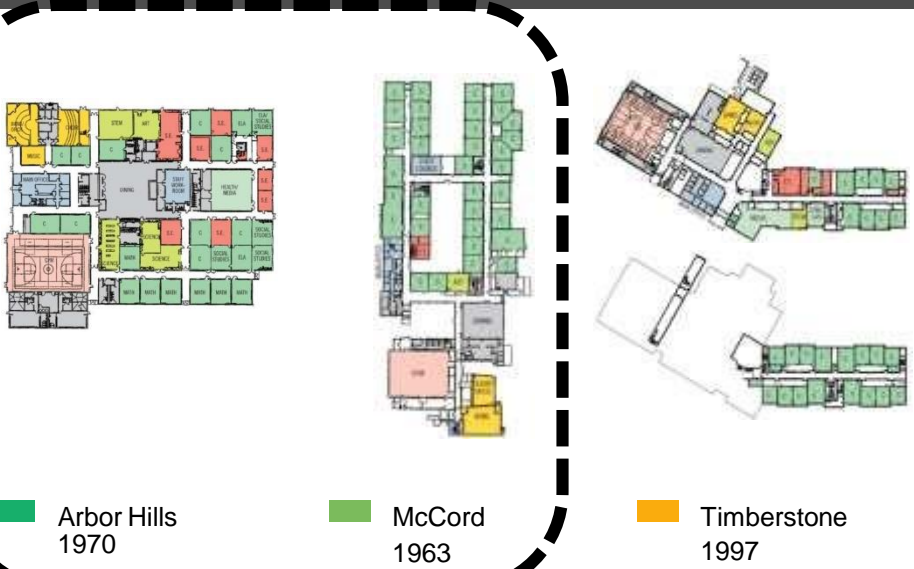

High Schools (2)



Scale

- Varying scales of classrooms across facilities
- Smallest 720 sf, largest 1350 sf, doesn't include dedicated SE classrooms
- 25-35+ sf per student – inline with space needed to facilitate active learning

Class and Special Program Size by District Contract*

- K-3 | 25 students
- 4-5 | 29 students
- 6-8 | 29 students
- 9-12 | 29 students
- Special Education requirements vary from 16 to 6 students max based on intervention need*

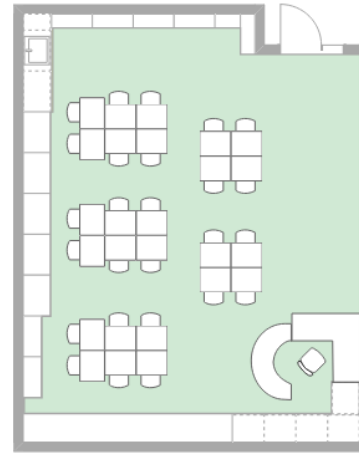

Central Trail / Stranahan
720-750 sf

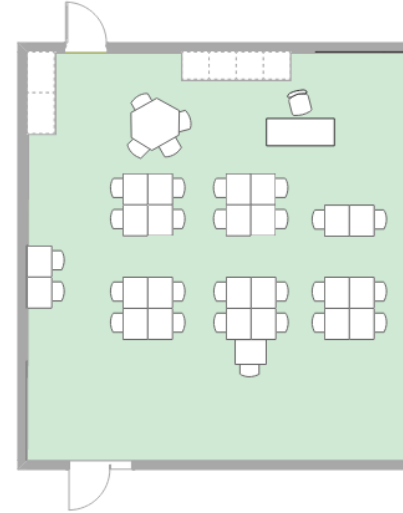

Sylvan / Whiteford / Highland
850 - 950 sf

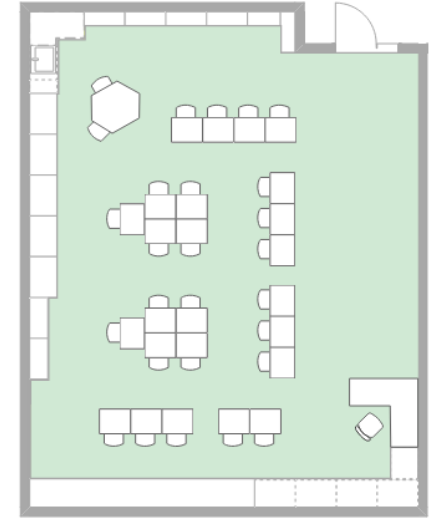

Hill View / Maplewood
970 - 1100 sf

smallest

largest

**2014 Ohio Operating Standards for the Education of Children with Disabilities*

The following are examples not recommendations at this point...

Reorganizing, not adding capacity

- Shifting Classroom / space designations in individual buildings i.e. flipping a 4th grade classroom to 5th grade based on the need from year to year
- Adjusting neighborhood school boundaries, could be year by year i.e. a portion of Central Trail's northern boundary shifts to Highland, or a portion of Timberstone's northern boundary shifts to McCord

Adding capacity, but decreasing quality

- Increasing class sizes in existing facilities
- Adding Trailers / Portable classrooms to existing facilities

Adding capacity and potential to enhance quality

- Reconfigure grade bands / configurations within existing facilities (may require renovation to make suitable for shift in use) i.e. Elementary schools shift to K-4, an existing facility becomes 7-8 and potentially combine, one high school becomes 9th grade and Career Tech and the other becomes 10-12
- Expanding and renovating existing facilities to accommodate growth
- Building new facilities

We're exploring different strategies to address increased enrollment in our district's facilities.
Which of the following options would you prefer?

Please select up to three

Teacher/Staff Responses

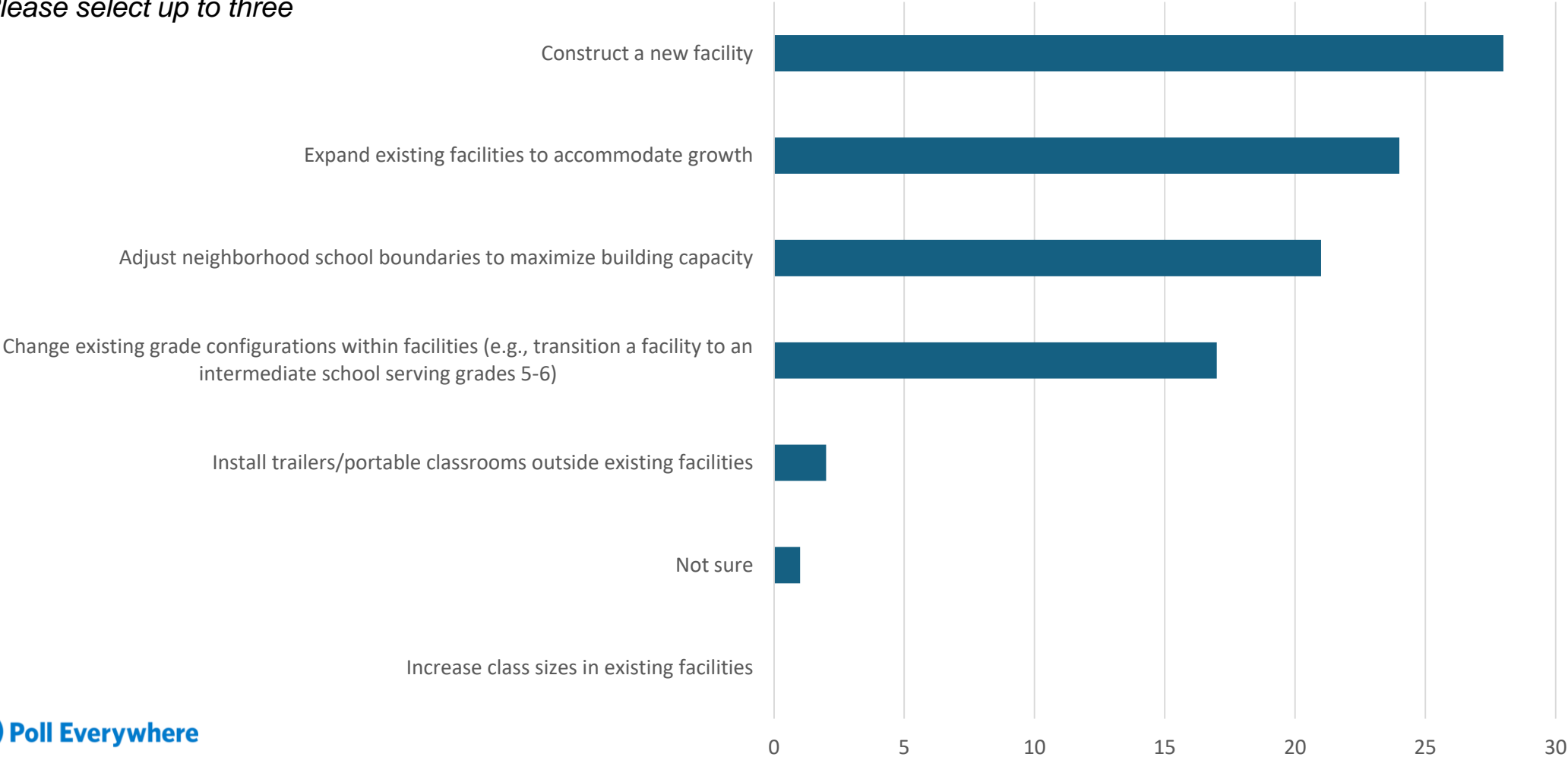

When considering the future of a school building, which factors should be prioritized?

Please select up to three

Teacher / Staff Responses

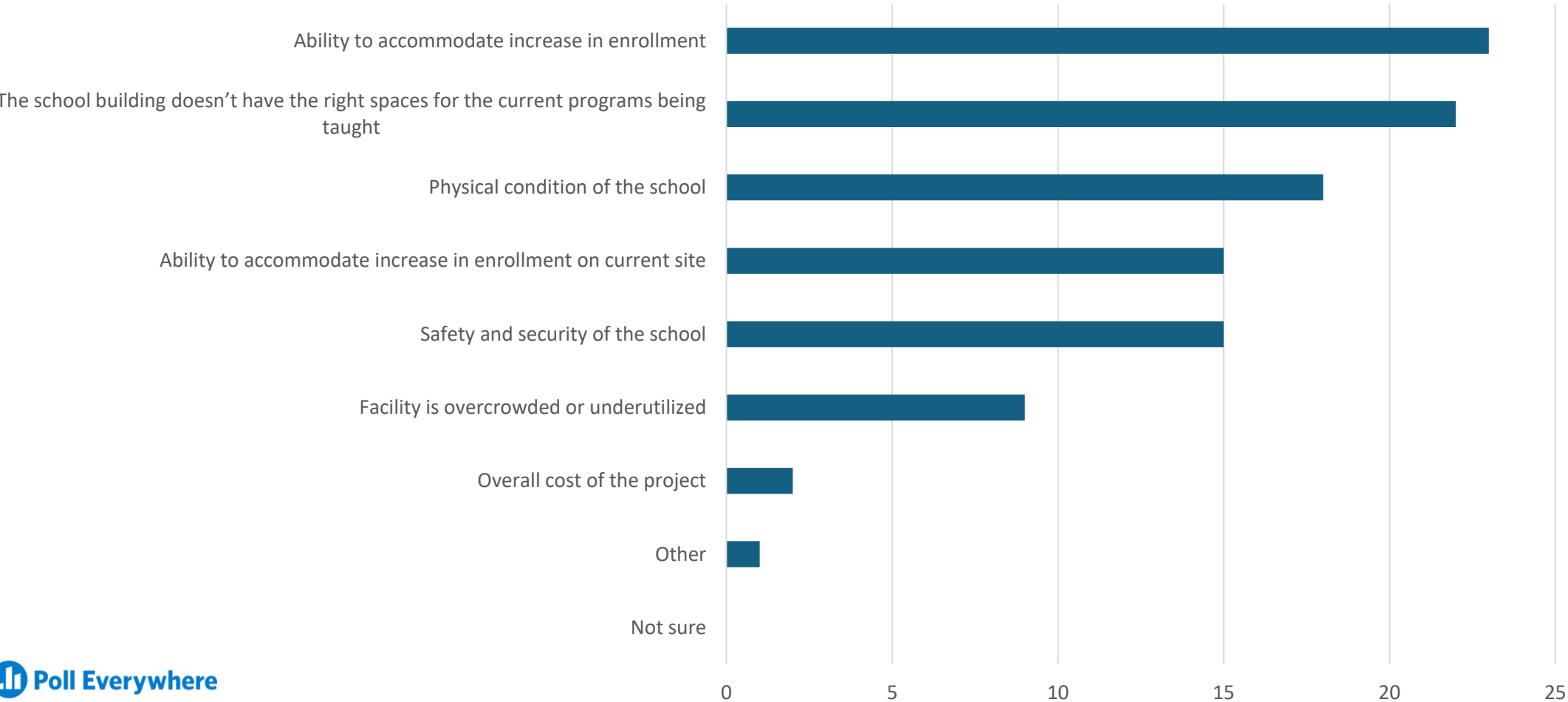

THE COLLABORATIVE

Quality of Light

- Natural light in most classrooms, but some lacking e.g. Southview, Arbor Hills
- Many classrooms have opted for “light filters” over fluorescent lights



Maplewood Elementary School



Southview High School

THE COLLABORATIVE

Furniture, Storage & Technology

- Varying amounts of in-classroom storage based on vintage, Jr. High and High Schools have less
- Varying amount modalities in each classroom – impacts on storage
- Functional furniture, not necessarily flexible
- Limited power outlets
- Technology improves from Elementary, to Jr High, and High School
 - Smart Boards & Projectors in K-8 classrooms
 - Interactive displays in High School Classrooms



Highland Elementary School



Central Trail Elementary

THE COLLABORATIVE

Furniture, Storage & Technology

- Varying amounts of in-classroom storage based on vintage, Jr. High and High Schools have less
- Varying amount modalities in each classroom – impacts on storage
- Functional furniture, not necessarily flexible
- Limited power outlets
- Technology improves from Elementary, to Jr High, and High School
 - Smart Boards & Projectors in K-8 classrooms
 - Interactive displays in High School Classrooms

04.03.2024



McCord Jr. High School

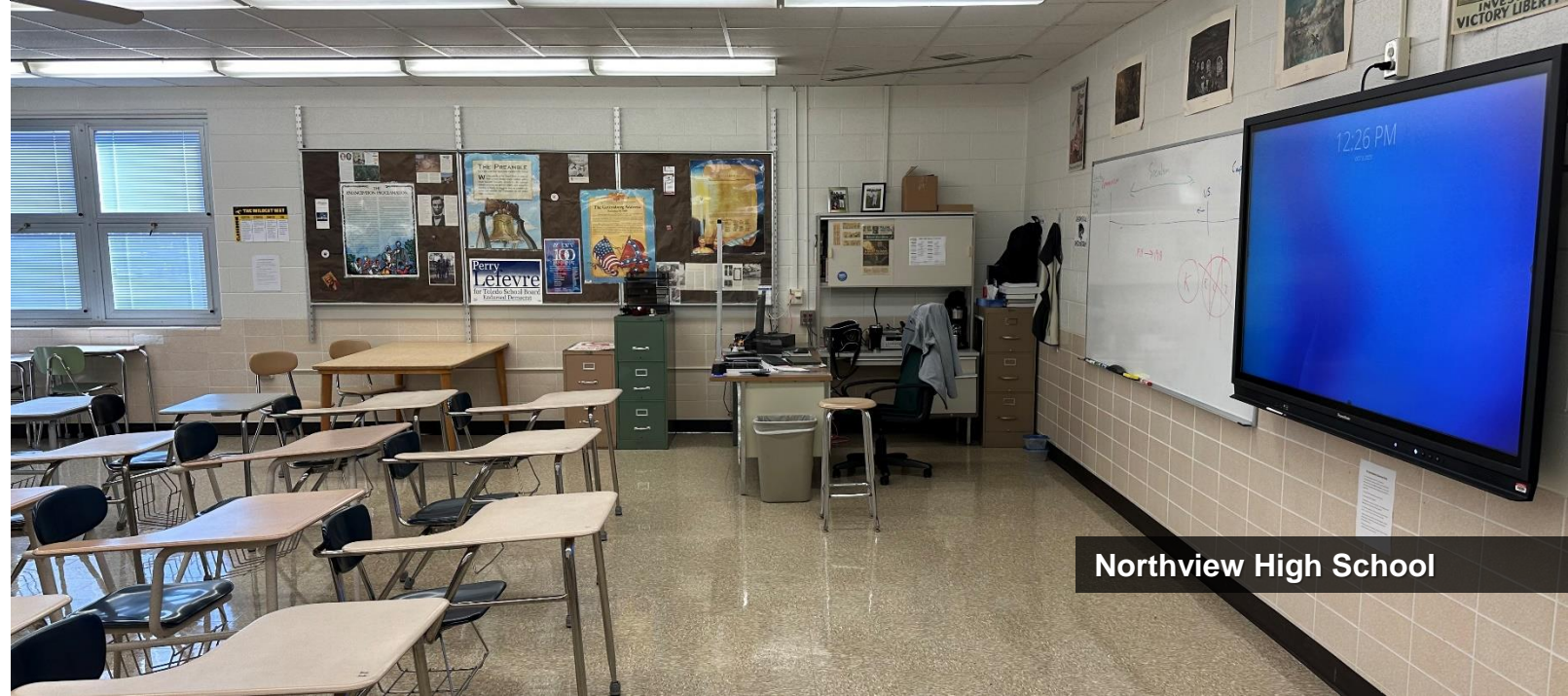

Northview High School

THE COLLABORATIVE

Break Out Spaces

- Vary by building
- Group work, intervention done within classroom spaces
- Observed in hallways
- Some facilities have dedicated “pod” type spaces, like Timberstone
- Cafeterias utilized for commons type environment

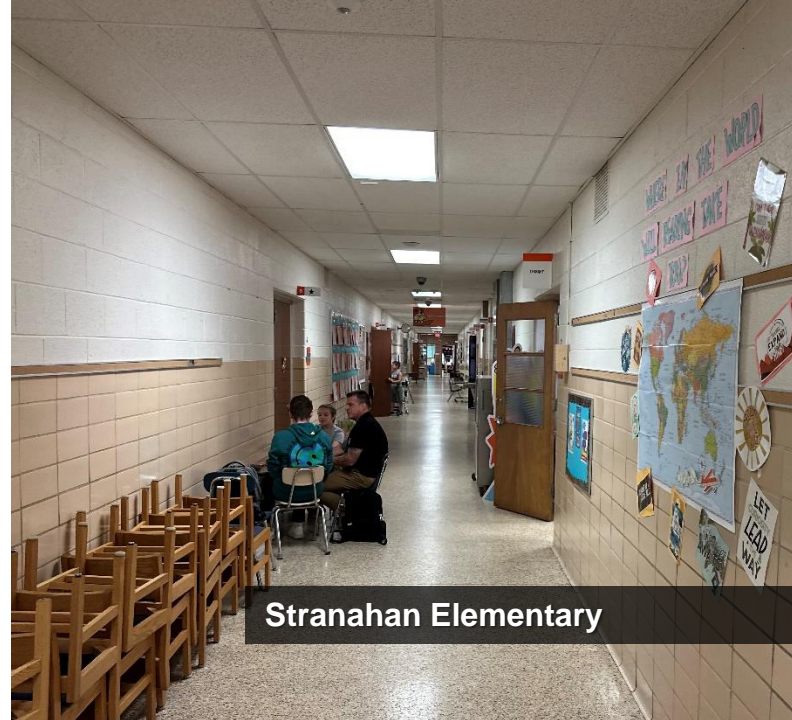

Stranahan Elementary



Maplewood Elementary



Timberstone Jr. High School



Southview High School

THE COLLABORATIVE

Intervention Spaces

- Vary by building
- Some are dedicated rooms, some are shared and subdivided spaces
- Some on carts



Timberstone Jr. High



Central Trail Elementary



Maplewood Elementary



Whiteford Elementary

THE COLLABORATIVE

Elementary Schools

- Stacks and desktop computers
- Some integrated technology
- Larger, stationary furniture
- Newer facilities have broader array of seating options
- Considerable amount of space, potential opportunity



Highland Elementary



Central Trail Elementary

THE COLLABORATIVE

Jr. High Schools

- Varying amount of stacks and desktop computers
- Some integrated technology
- More lounge type furniture, some moveable at Arbor Hills and McCord
- Considerable amount of space, potential opportunity



Arbor Hills Jr. High



McCord Jr. High School



Timberstone Jr. High School

THE COLLABORATIVE

High Schools

- Number of stacks and desktop computers
- Larger, stationary furniture
- “Think Tank” space at Northview has transitioned some amount of space for more lounge and makerspace type feel
- Considerable amount of space, potential opportunity



Southview High School



Northview High School

THE COLLABORATIVE

Art Rooms

- Varying amounts of storage
- Lack of display space
- Furniture appropriate, potential desire to be more flexible
- Less integrated technology
- High School Art rooms don't have Natural Light
- *Are demonstration areas appropriate?*
- *Are utilities adequate?*



Maplewood Elementary



Arbor Hills Jr. High



Northview High School



Southview High School

THE COLLABORATIVE

Music Rooms

- Adequate space for Elementary
- Potential need for additional practice space in High Schools
- Lack of Volume and Acoustical considerations at Southview and Timberstone
- Potential lack of lockable storage and large instrument storage
- *Recording capabilities?*
- ...



Northview High School



Southview High School

THE COLLABORATIVE

21st-century learning environments in K-12 education are designed to support diverse learners in the development of skills such as critical thinking, collaboration, creativity, and communication. Some features of these environments in addition to safety & security include:

1. **Flexibility** – Ability to transforming space to facilitate active learning, mobile furnishings, seating choice
2. **Integrated Technology** – Promote digital literacy
3. **Spaces for Collaboration**- Classroom communities, breakout spaces, and common areas, rethinking the library, career readiness
4. **Inclusive Design** – Accessibility, integration of intervention areas and focus on promoting community
5. **Lighting & Acoustics** – Incorporation of natural daylight, transparency/borrowed light, and focus on sensory awareness – sound absorption, adjustable lighting
6. **STEM and STEAM** – facilities that encourage the “design thinking” process with use of technology and hands on learning



Possibilities.....

Our Sylvania

SCHOOLS

Flexibility - Transforming the Classroom



Choice in Furniture





Movable Furniture & White Boards



High-Low Furnishings



Community & Collaboration



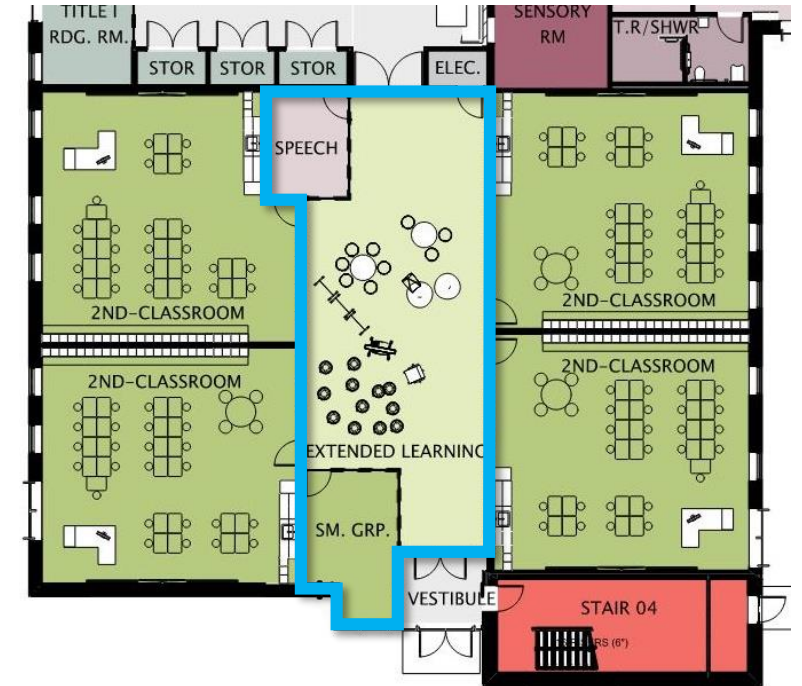

Classroom Communities



- Classrooms around shared collaboration & breakout spaces
- Transparency
- Flexibility, variety of furnishings

THE COLLABORATIVE

- Inclusive opportunities for intervention within classrooms
- Adjacent and visible from classroom spaces
- Varying levels of privacy based on need

-  Inclusion Opportunities
-  Intervention Rooms / Breakout Spaces
-  Extended Learning Zones

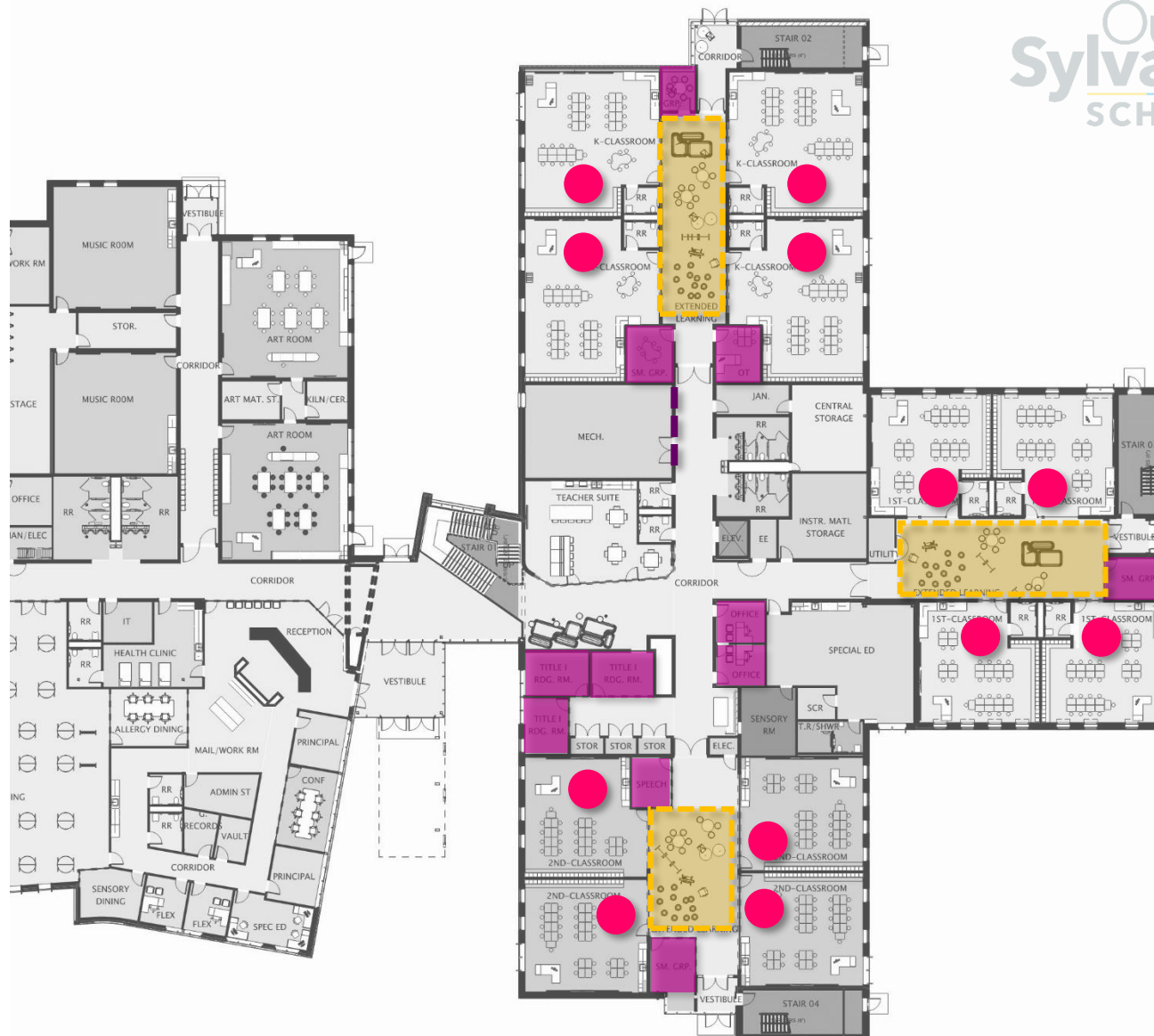

Inclusive Intervention Spaces



Extended Learning Zones



Dedicated Breakout Rooms



Casual “Third” Spaces





Rethinking Libraries...

- Learning Commons instead of Libraries
- Flexible spaces that can be used throughout the day
- Books where students are

Books where the kids are...



Variety of Seating Options



WLS Silver Creek Elementary

Reduced Collections, More Places to Gather



Rossford Elementary School

Modeling the Office Environment



STEM / STEAM



Maker Spaces



Flexible Areas for Design Thinking



Perryburg Hull Prairie Intermediate





Fine & Performing Arts



Storage & Instruction Areas



Flexible Furnishings



Rossford Jr / High School

Flexibility



WLS Silver Creek Elementary

Acoustical Treatments



High Volume Space



Rossford Jr / High School

Music Technology Lab Space



Storage Solutions





Career Tech

THE COLLABORATIVE

- Sylvania Schools offers 14 full Career Technical Education (CTE) programs.
- Available to all high school students alongside regular, honors, AP, and special education courses.
- These programs cover industry standards, providing practical skills and industry credentials.
- Students can earn college credits, participate in internships, and compete nationally.
- Located at Northview and Southview

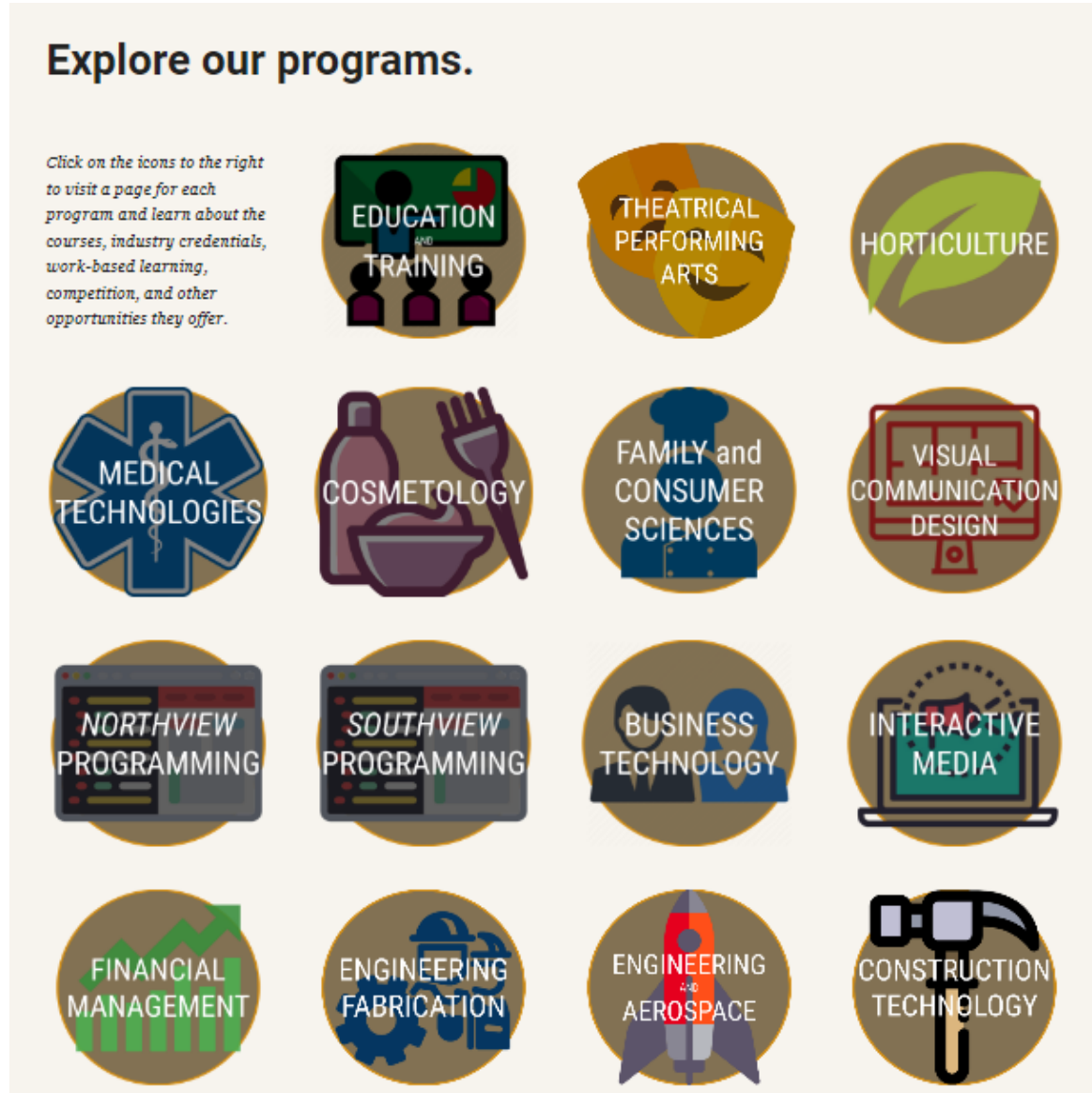

THE COLLABORATIVE

Existing Programs

- Cosmetology
- Education & Training
- Aerospace and Mechanical Engineering
- Interactive Media
- Visual Communication Design
- Medical Technologies
- Business Technologies
- Financial Management
- Family & Consumer Sciences
- Programming



Medical Technologies



Cosmetology



Interactive Media

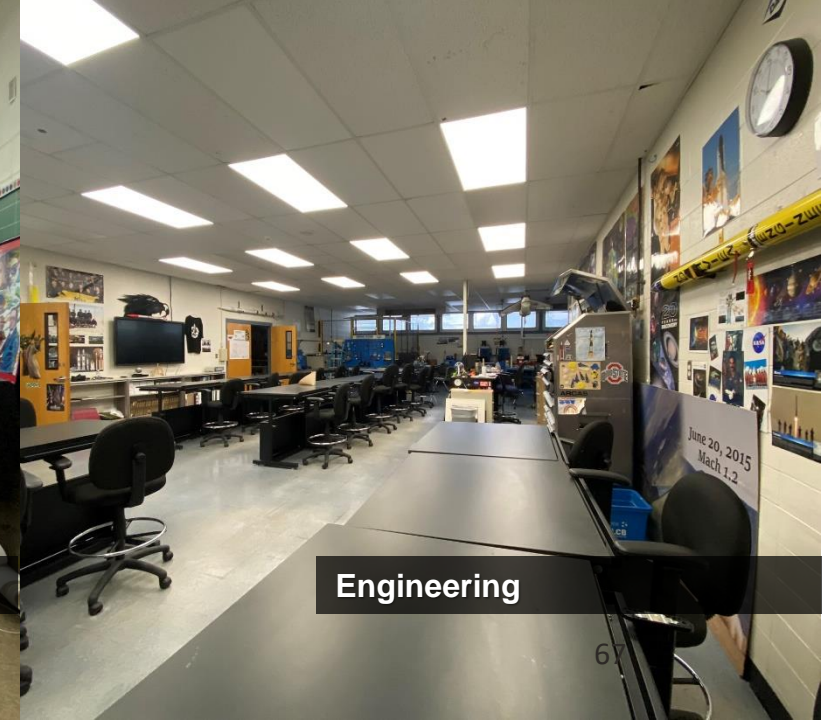

Engineering

THE COLLABORATIVE

Existing Programs

- Horticulture
- Construction Technology
- Engineering and Fabrication Technology
- Medical Technologies
- Programming
- Theatrical Performing Arts



Engineering & Fabrication



Construction Technology



Programming







In support of Congresswoman Marcy Kaptur's goal to make the Toledo area a national leader in providing instruction for the maintenance and repair of electric vehicles.

Electric Vehicle Repair & Maintenance

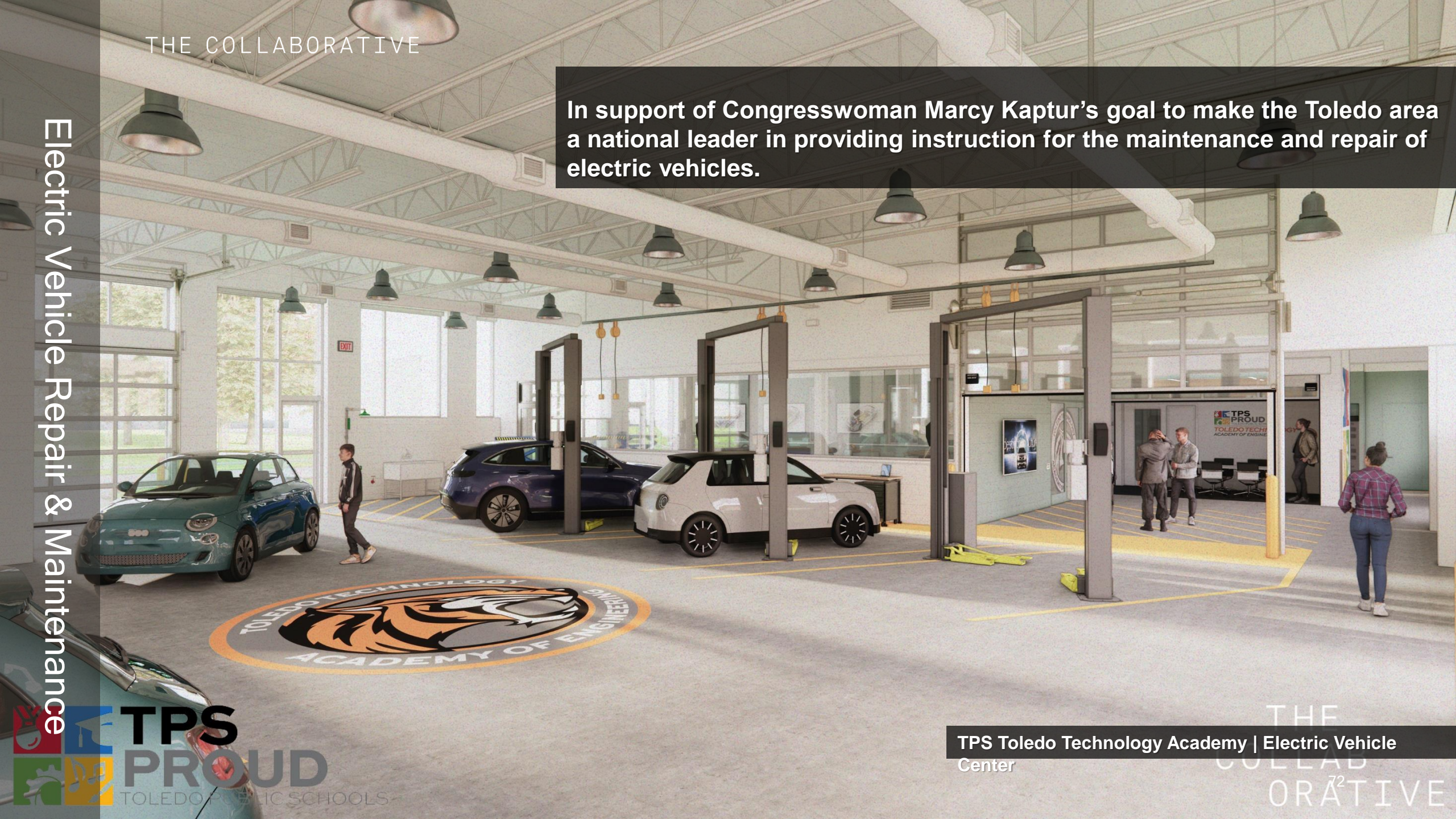



Culinary Arts & Food Service Operation



EHOVE Career Center, Milan, OH



Thank you!