

COMMUNITY UPDATE ON THE NEW ELEMENTARY BUILDING



New Brentwood Elementary School
Brentwood Borough School District

Rendering 2

November 15, 2023

Brentwood Borough School District

HHSDR



Agenda

- ❖ Review Previous Actions
- ❖ Review Proposed Renderings
- ❖ Discuss Timeline of Project
- ❖ Outline Future Meetings

Meeting Purpose

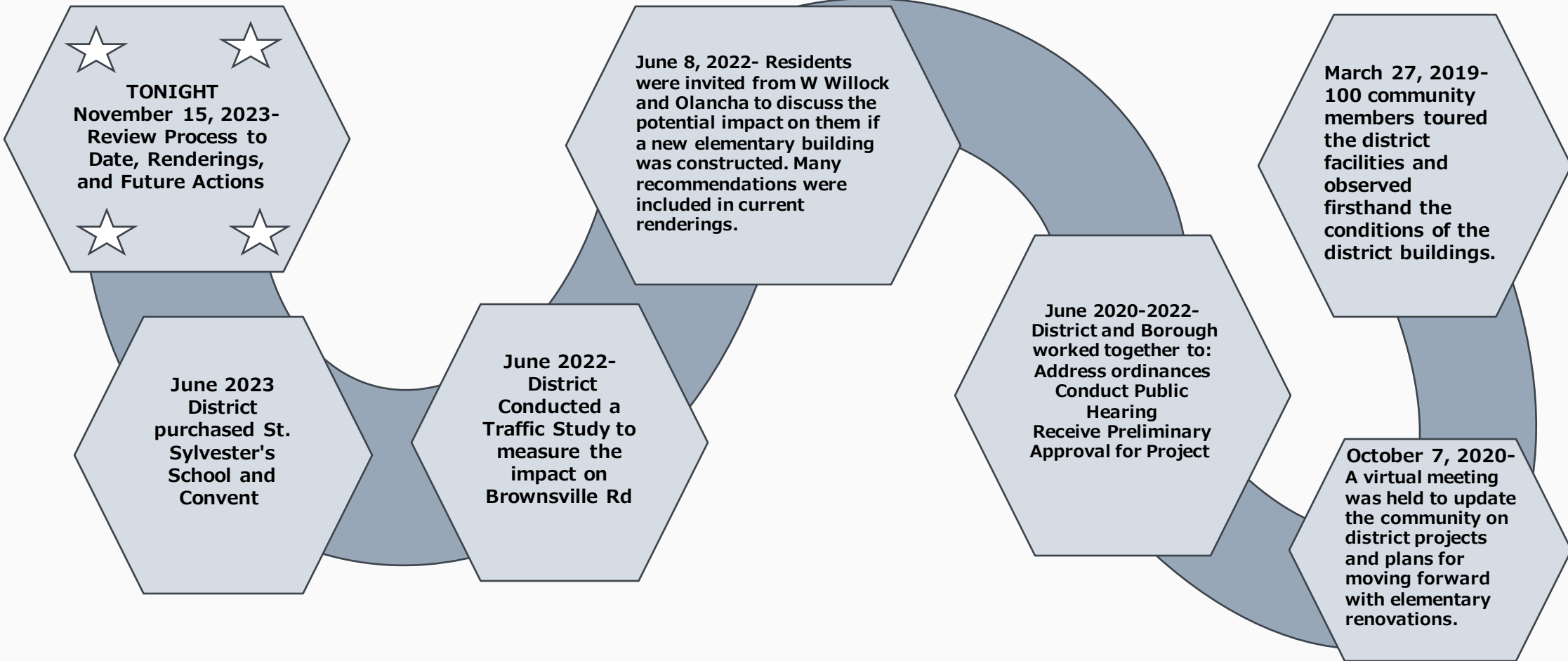

Four Year Journey

Evolution of Education in Pennsylvania

1900s

- No mandatory attendance for students beyond 16 weeks each year- Students that could keep pace with typical peers attended school
- Enrollment fluctuated depending on world events (Baby Boomer Generation)
- Focus was on basic education-memorizing facts and events
- 1920's school attendance shifted with hopes of attending a university for students seeking white collar jobs
- 1949- School Code is created

2023

- Mandatory attendance laws- all students were required to enroll
- Enrollment fluctuates and was impacted by COVID
- Focus is on preparing students to meet the challenges of a complex society through life-long learning skills to be successful in college, career or individual goals
- More challenges than ever in the areas of mental health (especially impact of social media), accessibility to drugs and the direct impact on the family

2123

- Students are inspired to attend and enrollment increases
- Focus is on personalized learning with an emphasis on thinking critically, creatively, strengthening emotional intelligence and social skills
- Preparation for jobs that are not even in existence yet
- Continued challenges in overall health of our students and families

Elementary Building Facts

Moore 32,200 SQ FT

Constructed 1914

Addition in 1941

Last renovated and addition 1997 (26 years)

Building Capacity is **250** students (**216 current**)

When calculating capacity, all sq ft are included. This means that the cafeteria and gym alters the actual capacity of classrooms.

Classroom size varies throughout the building but averages around 660sq ft with potential for 30 students in this space

Elroy 42,000 SQ FT

Constructed 1920

Additions and alterations 1925, 1955, 1965

Last renovation was 1997 (26 years)

Building Capacity **350** students (**316 current**)

When calculating capacity, all sq ft are included. This means that the cafeteria and gym alters the actual capacity of classrooms.

Classroom size varies throughout the building but averages around 660sq ft with potential for 30 students in this space

Merger or Consolidation

- 2017- Joint State Government Commission
- <http://jsg.legis.state.pa.us/resources/documents/ftp/publications/2017-07-31%20Final%20Report%20HR910%207.31.17%20220pm.pdf>
- 2017 –Procedural Review of School District Merger
- https://core-docs.s3.amazonaws.com/documents/asset/uploaded_file/923841/CBSD-Merger-White-Paper-2017-2018-1j2g9pi.pdf
- 2009- PSBA –Merger /Consolidation of School Districts: Does it Save Money?
<https://mrea-mt.org/wp-content/uploads/2016/04/PA-psba-merger-consolidation.pdf>

Considerations for New Building



Design for
Safety



Design for
the Greater
Community



Invest in
Quality
Materials



Design with
Change in
Mind



Design to
Keep Pace
with
Technology



Design for
Future
Energy

A blue starburst graphic with a jagged, sunburst-like border, containing the text "Design for Safety".

Design for Safety

- **Design using materials that add layers of protection for students- Window film, automated locking systems, sally port to hold visitors, camera system, security system, communication system, fire detection system**
- **Bollards in front of entrances to regulate arrival and dismissal**
- **Required storm shelter to withstand an F3 tornado**
- **Structure of Nursing Suite to provide services to students and ensure privacy- Designed for students requiring daily medical services**
- **HVAC System- Consider systems that filter the air and sanitize the air- Many students suffer from allergies, asthma, and other respiratory illnesses that require accommodations**
- **Climate**



**Design with
Change in
Mind**

- **ESL classrooms, STEAM classroom, Sensory room, OT/PT, Speech and Language, Counseling rooms**
- **Intentional meeting spaces will be included in the design of the new building**
- **Adequate size of common areas cafeteria, gyms, kitchen Cafeterias are unable to fit all students
Library/media, music, art rooms are inadequate not all special teachers have a dedicated space**
- **Rethink the size of classrooms to promote students' ability to move and collaborate- Balance Enrollment across Grade levels**



**Invest in
Quality
Materials**

- **Quality does not mean defaulting to expensive products**
- **Intentional design promotes better use of materials**
- **Set standards for length of serviceable life**
- **Select materials that will assist with ease of replacement**



Design for the Greater Community

- **Structure areas in the building where community groups may gather. Bhutanese Community Group initiated a tutoring program for our students Monday-Friday, Girl Scouts, Boy Scouts, Athletic Organizations, Musical Organizations**
- **This would require compliance with most recent ADA regulations**
- **Promote the use of the building as an attraction for incoming families**
- **Designing areas outside of the structure for the community to use**



**Design to
Keep Pace
with
Technology**

- **Forward thinking design for classroom organization- Examples may include electrical outlets from the ceilings instead of on the floor**
- **Include outlet ports for various types of technology**
- **Wire the classroom and plan for future upgrades**
- **Communication Systems-Telephones**
- **Lighting- Controlled LED lighting**
- **Audio- Include an amplification system to assist teachers and students to project their voice**



**Design for
Future
Energy**

- **Consider energy consumption and ways in which to capitalize on resources such as solar panels, watersheds, water retention systems**
- **New windows and doors are built for efficiency**
- **New HVAC system will be cost efficient**
- **Automatic Temperature Control Systems –regulate the environment to assist heating and cooling of the building**

Current and On-Going Actions

- Create a team to assist in the brainstorming process- Include school board directors, administrators, educators, support staff, students, parents, community members, business professionals, financial planners, architects, and solicitors.
- Partner with Children's Museum to lead the process and assist with communicating ideas to our architects, HHSDR
- Identify current challenges and potential solutions for moving forward
- Visit multiple organizations (schools and non-schools) to gain perspective and gather ideas
- Create a space to share, track, and analyze ideas



Interactive Learning Structure Design



Dual Purpose Interior Design



Flexible Furniture



Environmental Considerations

Future of School Design

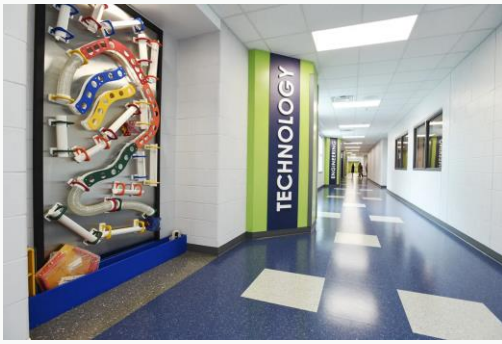

Intentional Design for Learning Walls



Sensory- Acoustic Considerations and Lighting Options



Consideration of Selecting Color Options



What Will Schools Look Like?



Interactive

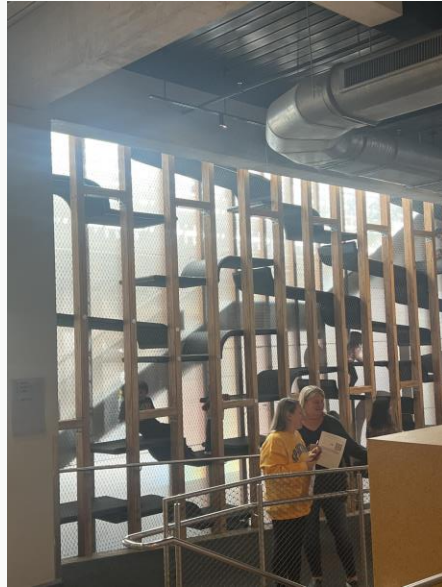

Problem Solving

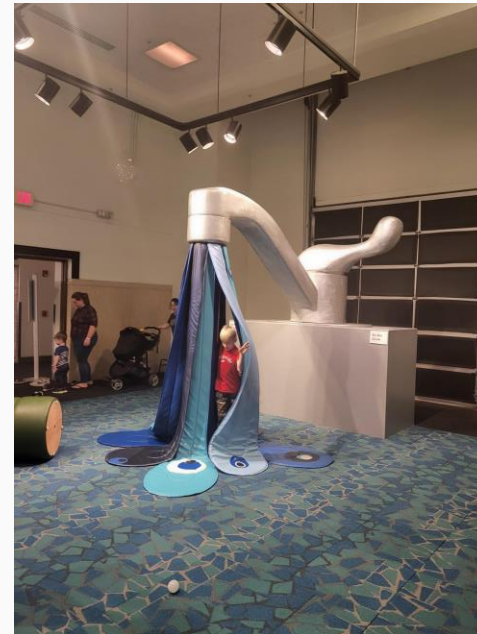

Exploration

Engagement



How Do Children Learn?

Elements of Classroom Design



Future focused verses current classroom organization

Conceptual Designs



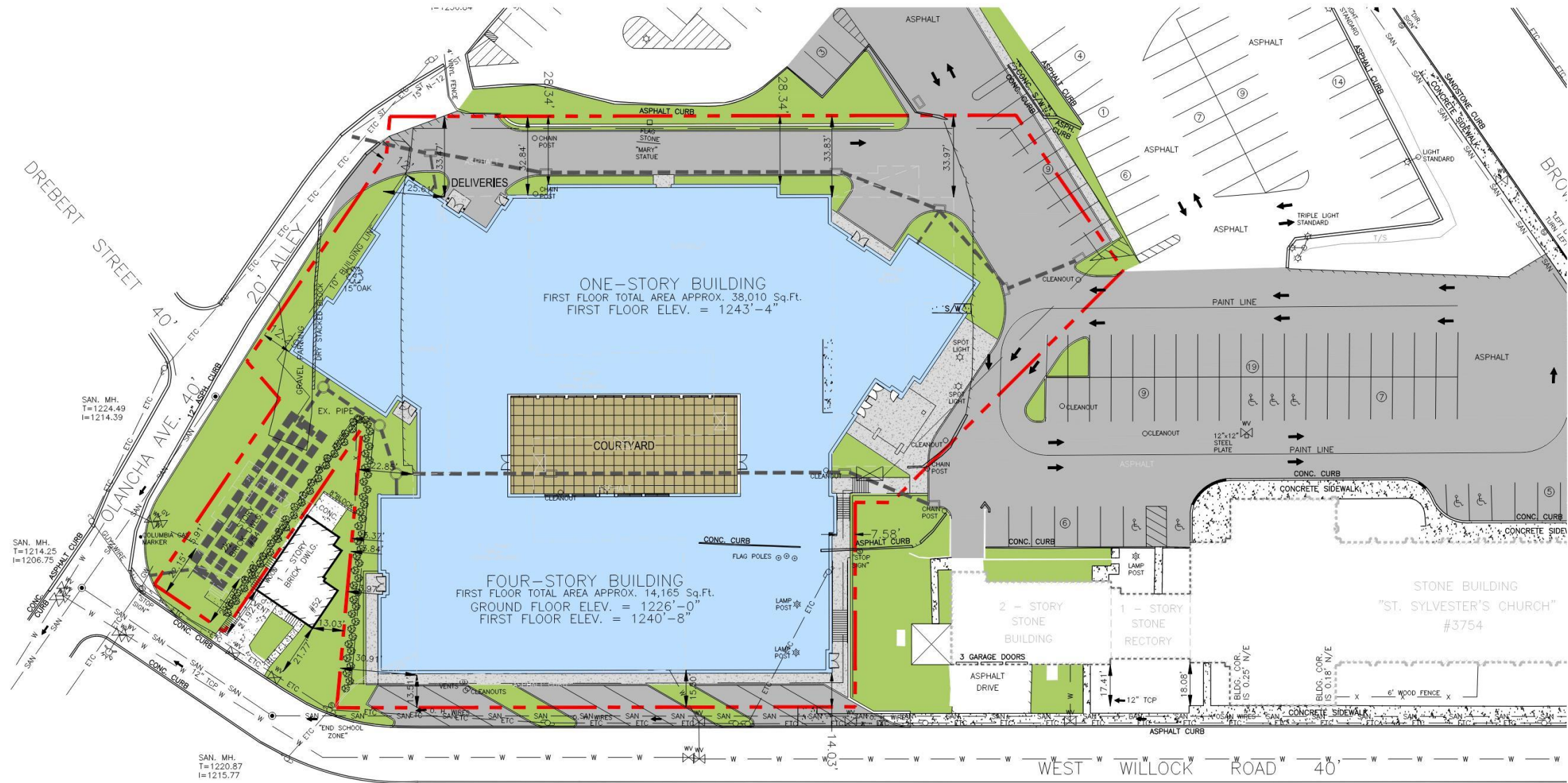

New Brentwood Elementary School

Brentwood Borough School District

PRELIMINARY SITE PLAN

1"=40'-0"

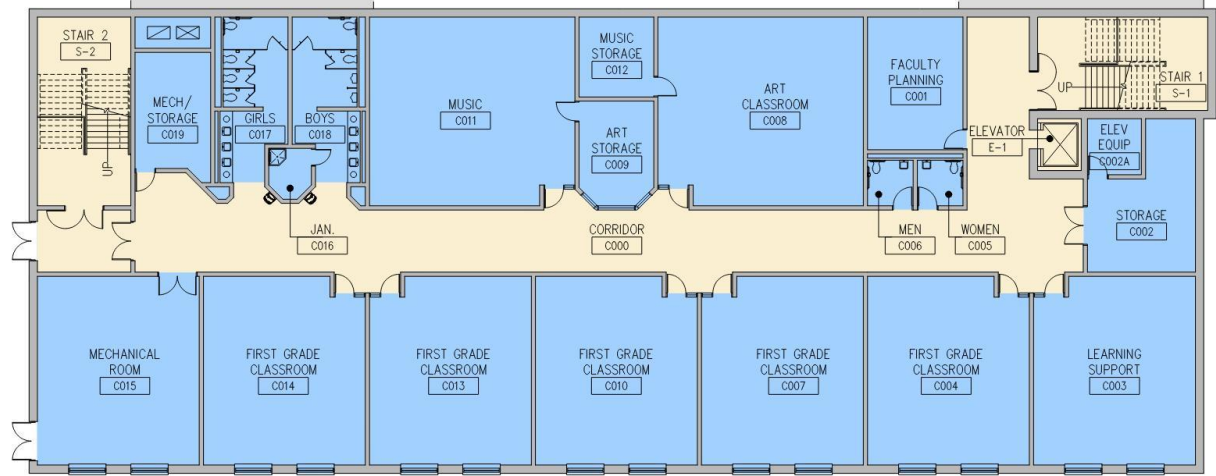
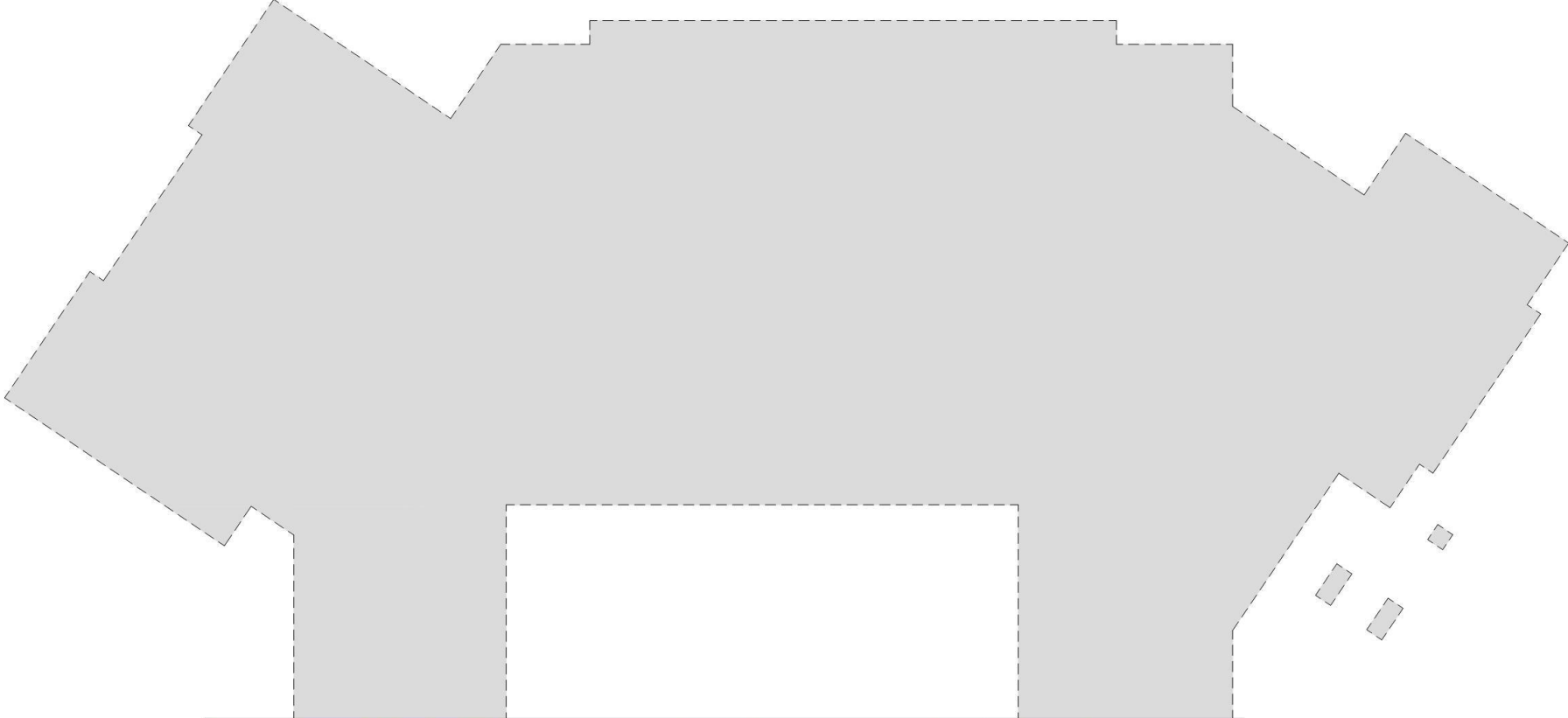

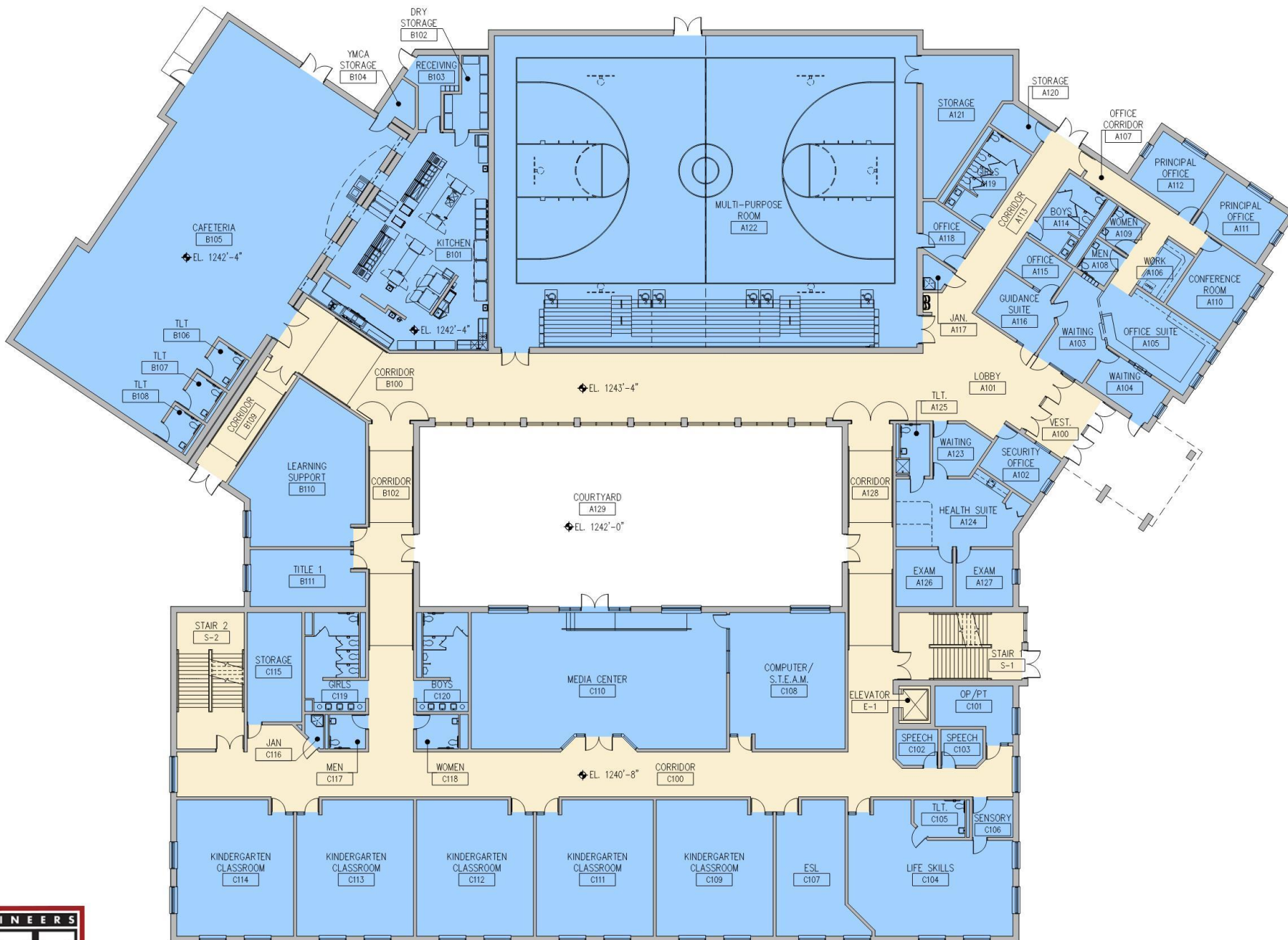

New Brentwood Elementary School
 Brentwood Borough School District

FIRST FLOOR PLAN
 41,840 SF

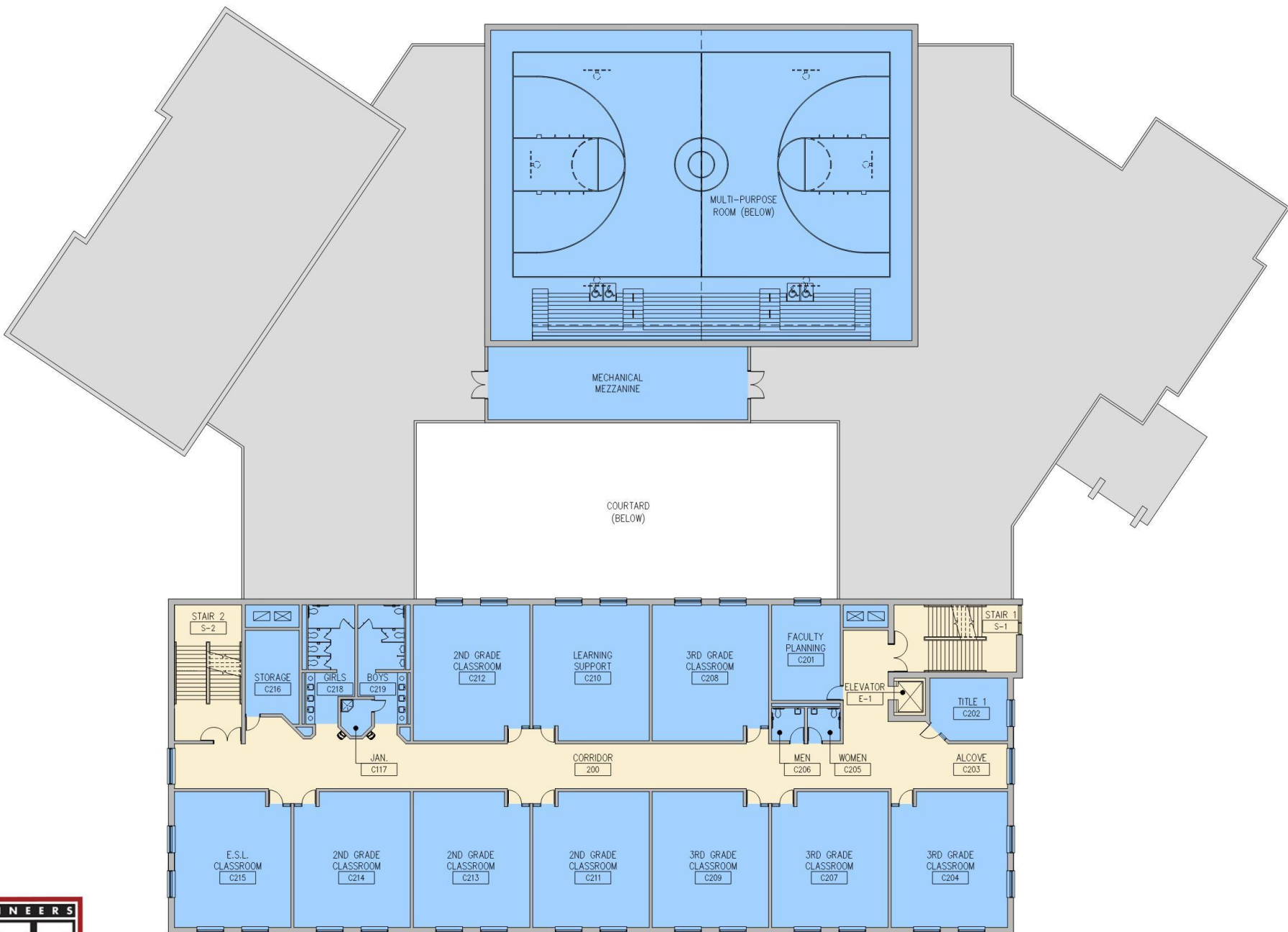

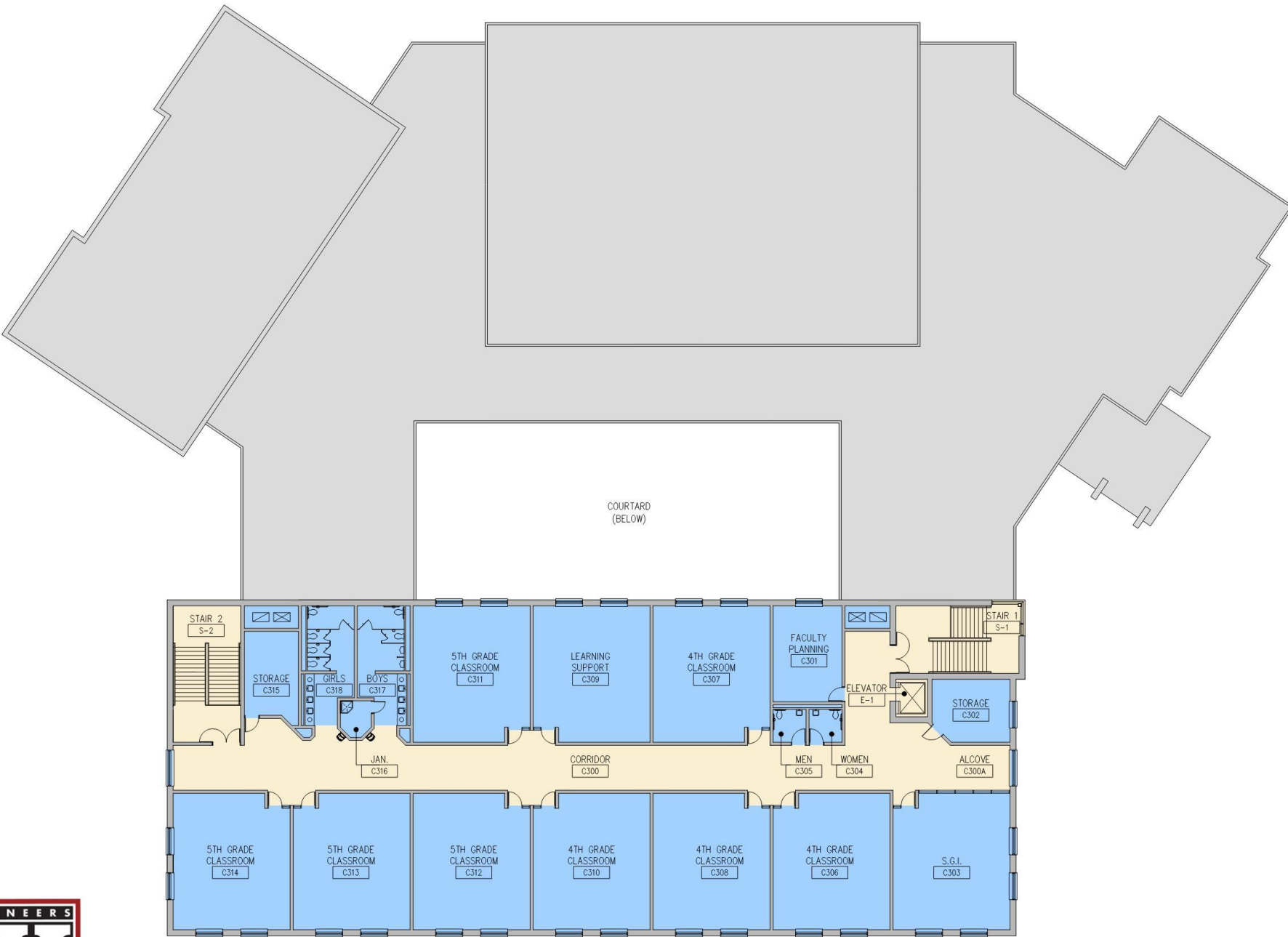



New Brentwood Elementary School

Brentwood Borough School District
Community Update on New Elementary Building



New Brentwood Elementary School
Brentwood Borough School District
Community Update on New Elementary Building

Rendering 2
24



New Brentwood Elementary School

Brentwood Borough School District
Community Update on New Elementary Building

Rendering 1
25



New Brentwood Elementary School

Brentwood Borough School District
Community Update on New Elementary Building

Other Considerations and Challenges

- Track decision making process for future leaders and community members
- Parking in Brentwood is a challenge. A parking agreement has been established between the District, St. Sylvester's, and Brentwood Medical.
- Some students will be required to walk further to school. We are still exploring options to address this challenge.
- The District would be responsible for arranging for the selling of Moore and Elroy buildings. The Board is adamant that conditions be included in the purchasing agreement that any project be one that would enhance the overall community value.

Proposed Timeline

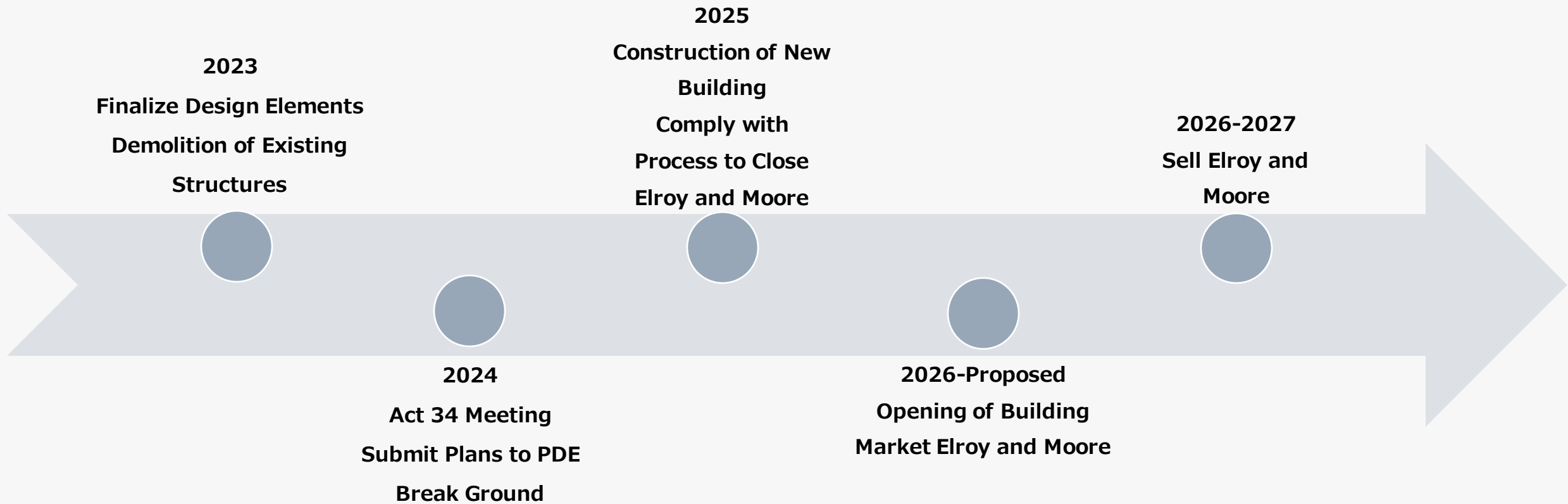

Future Meetings (Red indicates required)

- **Act 34 of 1973 Meeting- Financial Impact**
Anticipated to be scheduled in January 2024
- Design Meeting- Presentation of final design
- **School Closings- Moore and Elroy- Article VII, 24 PS § 7-780, Article XIII, 24 PS § 13-1311, 22 Pa. Code § 4.41(c) Scheduling**

Future Touchpoint Meetings 2023-2026

Thank you!



Construction Updates Located:

- <https://www.bb-sd.com/Construction.aspx>

Brentwood Borough
School District

HHSDR